

GENERAL NOTES:

1. THE GENERAL CONTRACTOR SHALL CHECK AND VERIFY ALL DIMENSIONS AND REPORT ALL ERRORS AND OMISSIONS TO THE CONSULTANT.
2. ALL WORK AND MATERIALS TO BE IN COMPLIANCE WITH ALL CODES, REGULATIONS, AND BY-LAWS.
3. FOOTINGS DESIGNED FOR 2000 P.S.F. ASSUMED BEARING. BEARING STRATA, GRANULAR MATERIAL AND COMPACTION TO BE INSPECTED AND APPROVED BY SOILS CONSULTANT PRIOR TO POURING CONCRETE.
4. DO NOT SCALE THE DRAWINGS.

NO.	DESCRIPTION & DATE
1	

JOB TITLE:
PROPOSED 2
BASEMENT UNITS IN
EXISTING TRIPLEX
505-507 CHURCHILL
CITY OF OTTAWA

SHEET TITLE:
SITE-LANDSCAPE PLAN

SCALE: AS SHOWN	DWG NO.
DRAWN: C.S.	S1.1
CHECKED:	
DATE: SEPT 2022	
PRINT DATE:	

Committee of Adjustment
DEC 16 2022
City of Ottawa

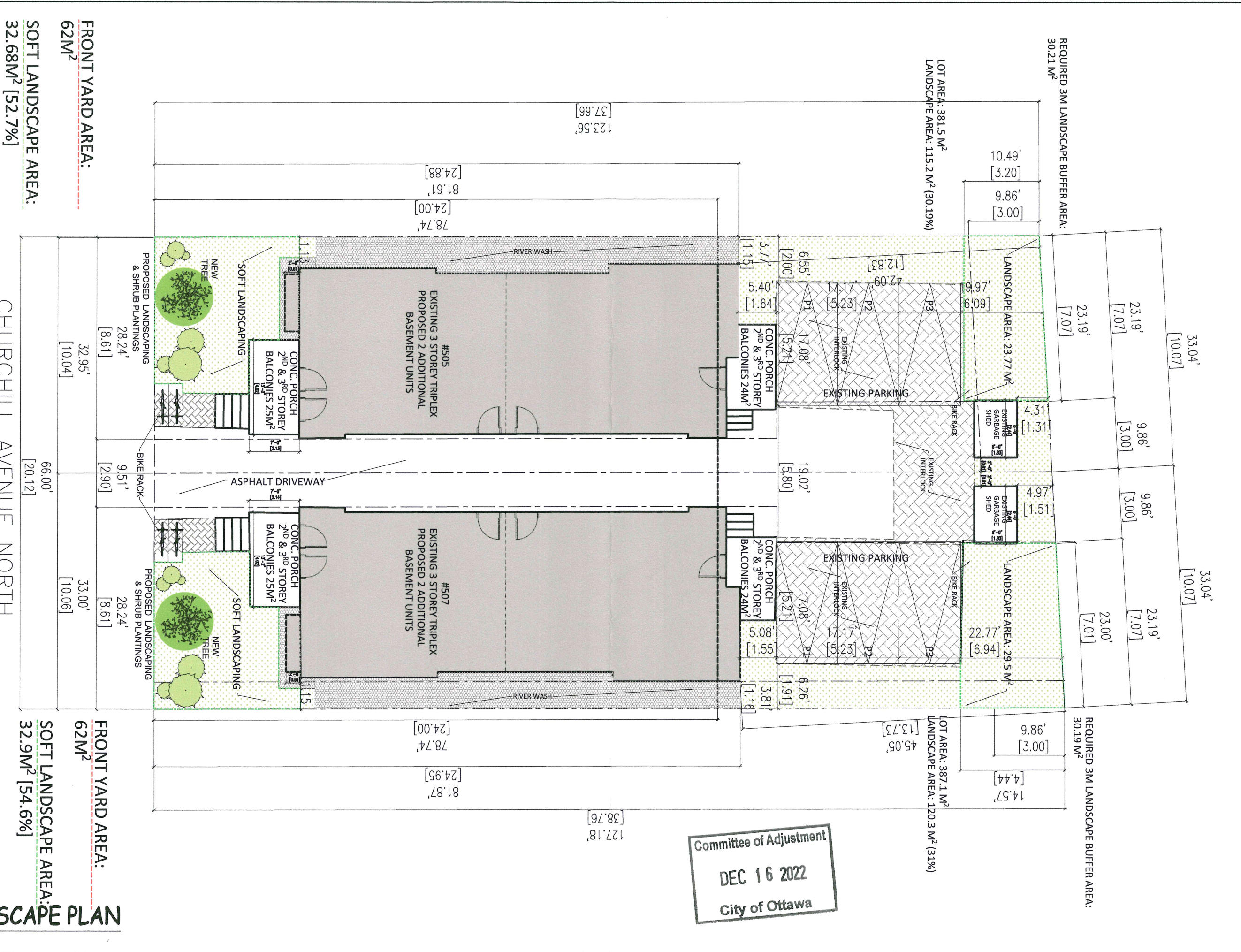

SITE-LANDSCAPE PLAN
SCALE 1:150

FRONT YARD AREA:
62M²

SOFT LANDSCAPE AREA:
32.68M² [52.7%]

FRONT YARD AREA:
62M²

SOFT LANDSCAPE AREA:
32.9M² [54.6%]

CHURCHILL AVENUE NORTH