

Slevin Severance Sketch

3057 Greenland Road
 Part 2, Plan 5R-10409
 Part Lot 3, Concession 5
 Geographic Twp. of Torbolton
 CITY OF OTTAWA

Key Map
 N.T.S.

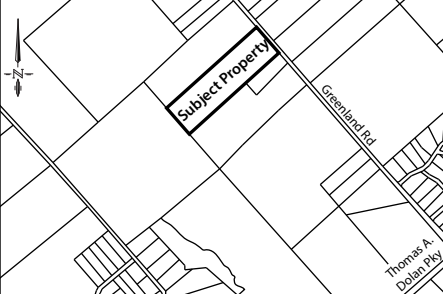

Legend

- Lands to be Severed
- Lands to be Retained
- Local (unevaluated) Wetlands
- Flood Plain
- Regulation Limit
- Watercourse
- Coniferous Tree
- Deciduous Tree

Committee of Adjustment
 Received | Reçu le

2023-03-22

City of Ottawa | Ville d'Ottawa
 Comité de dérogation

Notes:

1. Location of the Local Wetlands, Flood Plain, Regulation Limit and Watercourse derived from the City of Ottawa geoOttawa Online GIS Map and confirmed using the Mississippi Valley Conservation Authority GIS Mapping.
2. Both of the proposed severances are located greater than 295 metres from the ME2 zone to the west, measured to their closest point. The required setback for the future dwelling to the ME2 zone is 150 metres.
3. Boundary and dimensions of the subject property derived from Plan 5R-10409 completed by Fairhall, Moffatt and Woodland Ltd. in November of 1986.

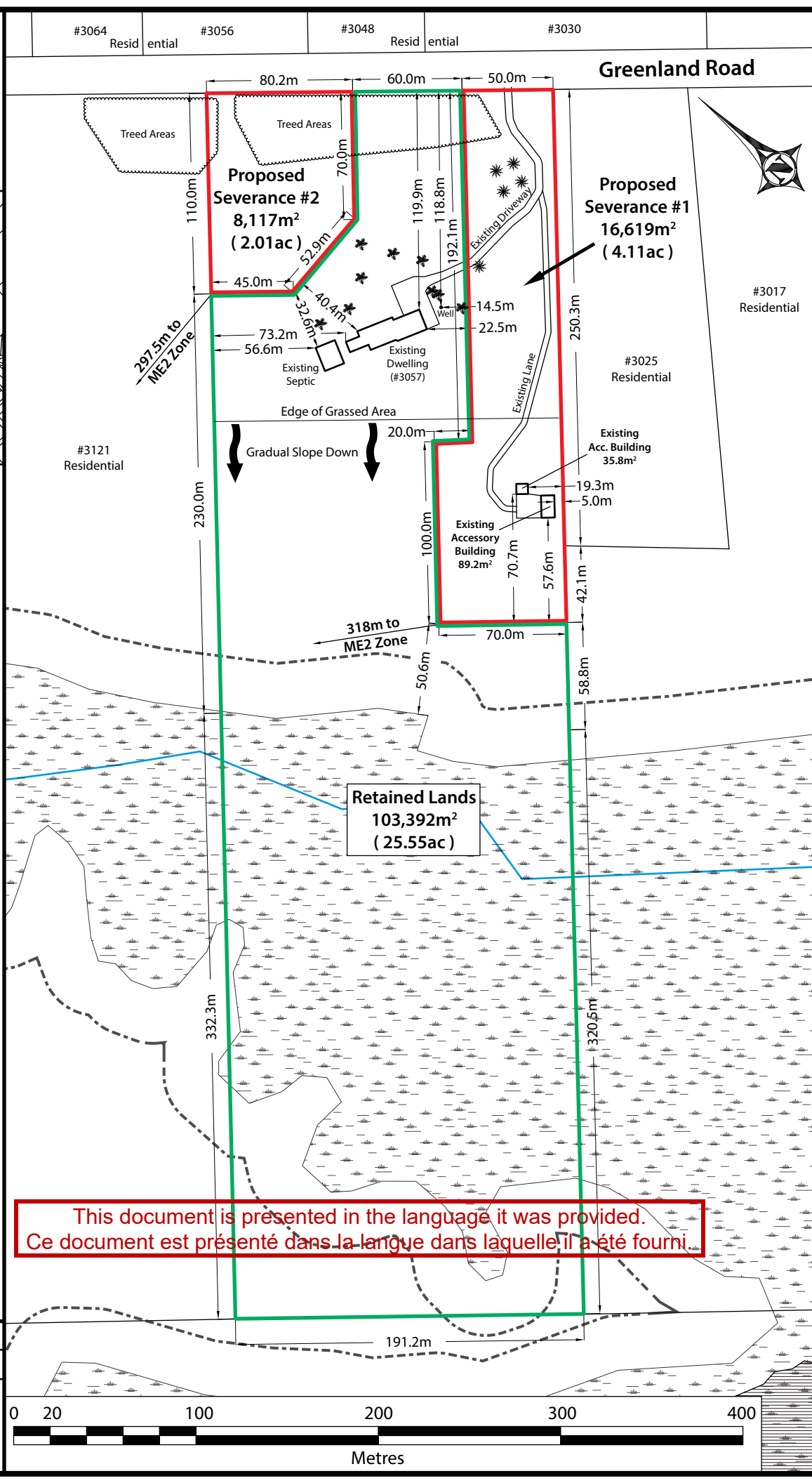

This document is presented in the language it was provided.
 Ce document est présenté dans la langue dans laquelle il a été fourni.

Version Date: February 22, 2023

File No. 22-234 | Drawn By: CC

