

This document is presented in the language it was provided.
Ce document est présenté dans la langue dans laquelle il a été fourni.

Tree Information Report

660 O'Connor St, Ottawa ON, K1S 3R8

Committee of Adjustment

Received | Reçu le

2023-05-02

City of Ottawa | Ville d'Ottawa

Comité de dérogation

Property Owner Contact Information

George & Georgina Georgopoulos

24 Greenpointe Drive

Nepean, ON

K2J 4T9

ggeorgopoulos@rogers.com

613 797 8517

Arborist Contact Information

Kyle Hewitt

Croft Tree Experts Inc.

crofttreeexperts@gmail.com

613 218 4958

660 O'Connor St, Ottawa ON—Tree Information Report

Tree Layer Prepared by Croft Tree Experts Inc. (Kyle Hewitt ISA ON-2442A)

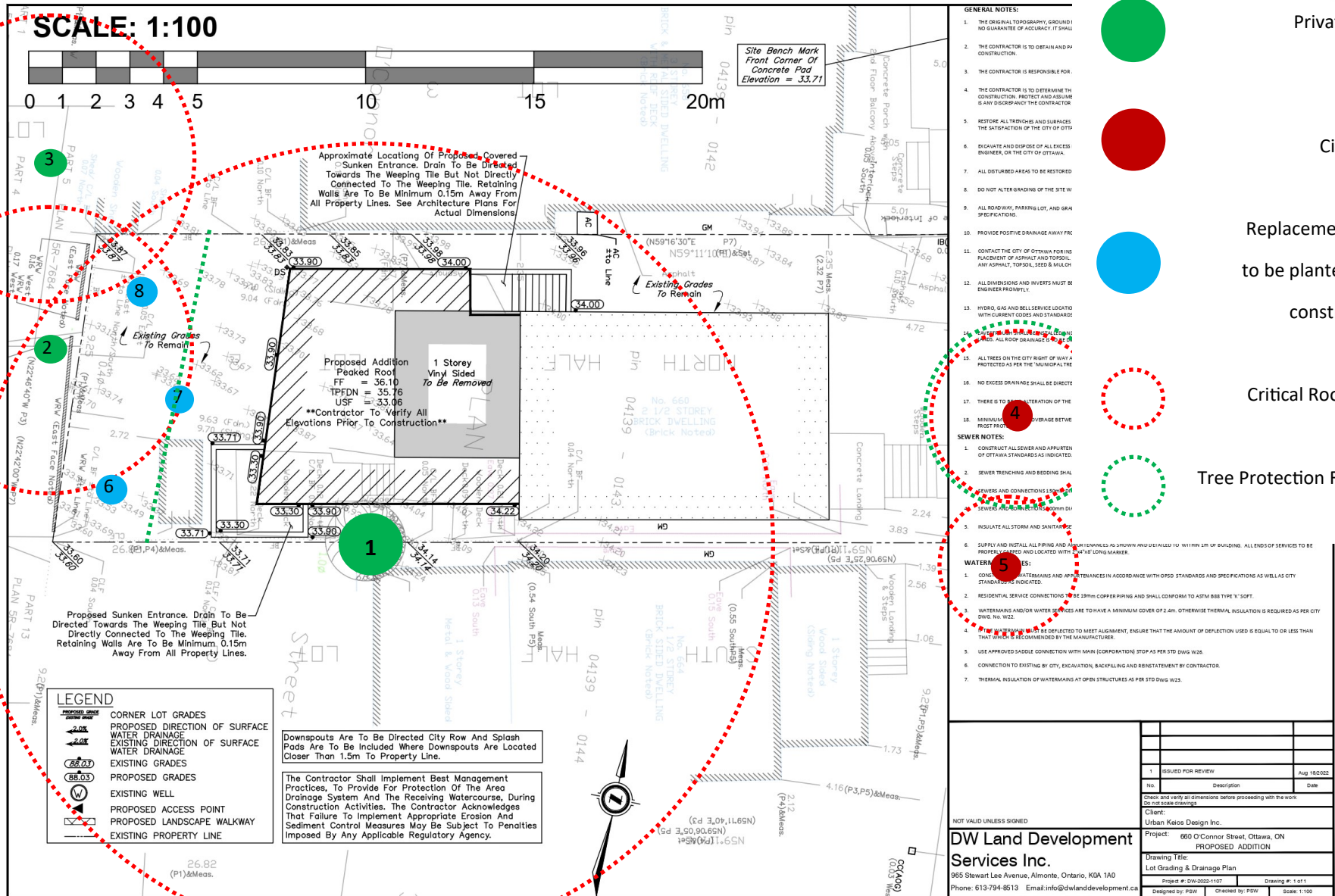

NOT VALID UNLESS SIGNED

DW Land Development Services Inc.	
965 Stewart Lee Avenue, Almonte, Ontario, K0A 1A0	
Phone: 613-794-8513 Email: info@dwlanddevelopment.ca	
Project:	660 O'Connor Street, Ottawa, ON PROPOSED ADDITION
Drawing Title:	Lot Grading & Drainage Plan
Project #:	DW-0302-1107
Designed by:	PSW
Checked by:	PSW
Scale:	1:100

No.	Description	Date
1	ISSUED FOR REVIEW	Aug 16/2022

Check and verify all dimensions before proceeding with the work.
Do not scale drawings.

Client: Urban Kelos Design Inc.

660 O'Connor St, Ottawa —TREE INVENTORY

Prepared by Croft Tree Experts Inc. (Kyle Hewitt ISA ON-2442A)

#	SPECIES	DBH (CM)	OWNERSHIP	CONDITION/NOTES	ACTION	ARBORIST RECOMMENDATIONS
1	Sugar Maple <i>Acer saccharum</i>	80 (est)	Private— Shared	Fair condition—tree has a codominant structure from 1m with included bark, large decaying wound on stem over house, tree is very close to structures and has outgrown the space	Remove—tree is within foot print of excavation for proposed dwelling. Will require boundary tree declaration from neighbour.	Hire certified arborist to remove the tree. Replace the loss of tree post Construction as per city bylaw requirements.
2	Norway Maple <i>Acer platanoides</i>	30 (est)	Private— Adjacent	Good condition	Protect/Retain	Erect a protection fence 2m from rear fence to protect the Critical Root Zone.
3	Norway Maple <i>Acer platanoides</i>	25 (est)	Private— Adjacent	Good condition	Protect/Retain	Erect a protection fence 2m from rear fence to protect the Critical Root Zone.
4	Pin Cherry <i>Prunus pensylvanica</i>	15	City	Good condition	Protect/Retain	Erect a protection fence 1.5m from tree trunk to protect the Critical Root Zone.
5	White Cedar <i>Thuja occidentalis</i>	12	City	Good condition	Protect/Retain	No protection required, well clear of work zone.
6-8	6. <i>Ulmus davidiana</i> var. <i>japonica</i> 'Prospector' 7. <i>Syringa reticulata</i> 8. <i>Prunus species</i>	50mm/ 2m	Private	Minimum 50mm caliper for deciduous, 2m height for conifers	Plant post construction	Have an arborist assess the site post construction for recommendations on species and where to plant.

Tree #1—sugar maple to be removed.

