

LOT 3
JUNCTION GORE
CITY OF OTTAWA

BEECHWOOD CEMETERY

Division Line Between Lots 3 and 4 (JUNCTION GORE) And Division Line Between CITY OF OTTAWA and CITY OF VANIER

Committee of Adjustment
Received | Reçu le
2023-05-19
City of Ottawa | Ville d'Ottawa
Comité de dérogation

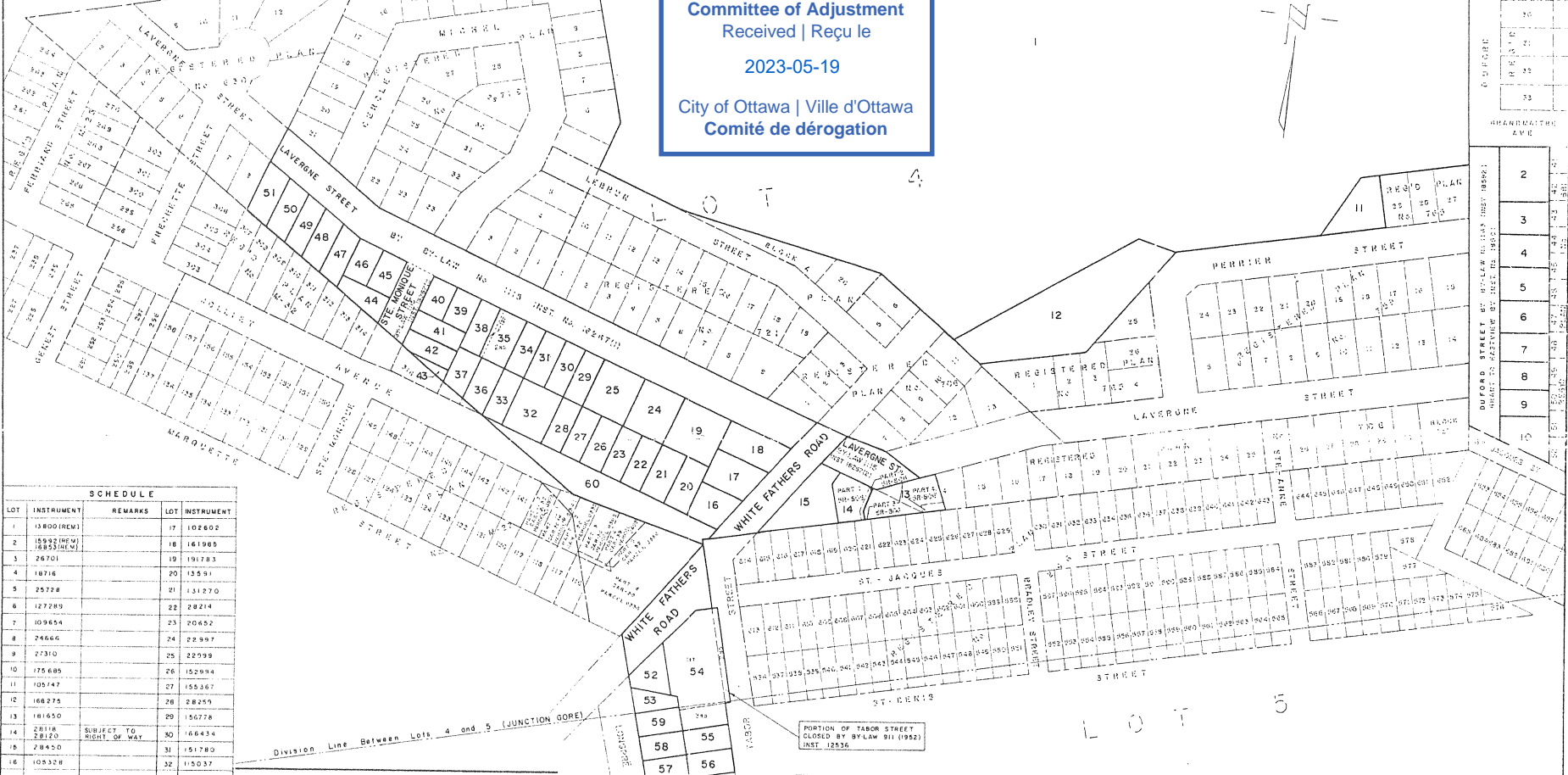

SCHEDULE			
LOT	INSTRUMENT	REMARKS	LOT
1	13800 (REV)		17
2	15952 (REV)		18
3	26701		19
4	18716		20
5	25728		21
6	127289		22
7	109654		23
8	24666		24
9	27310		25
10	175685		26
11	105147		27
12	168275		28
13	181550		29
14	28120	SUBJECT TO RIGHT OF WAY	30
15	28450		31
16	105328		32
LOT INSTRUMENT			
33	124785		40
34	108770		50
35	29328		51
36	137773		52
37	17189		53
38	147782		54
39	27892		55
40	184509		56
41	28316		57
42	20842		58
43	17809		59
44	188831	TOGETHER WITH RIGHT OF WAY	60
45	182725	SUBJECT TO RIGHT OF WAY	
46	25144	SUBJECT TO RIGHT OF WAY	
47	24724		
48	179625		

FOR THE PURPOSE OF SUBSEQUENT SURVEYS RECOURSE SHOULD BE HAD TO PREVIOUSLY REGISTERED INSTRUMENTS

CAUTION: THIS PLAN IS PREPARED PURSUANT TO SECTION 81(2) OF THE REGISTRY ACT, R.S.O. 1990, CHAPTER A03, FOR THE PURPOSE OF ILLUSTRATING GRAPHICALLY THE RELATIVE POSITION OF THE INSTRUMENTS SHOWN IN THE SCHEDULE. THIS PLAN IS NOT A PLAN OF SUBDIVISION WITHIN THE MEANING OF SECTIONS 29, 32, OR 33 OF THE PLANNING ACT. SEVERANCE APPROVAL FROM THE APPROPRIATE PLANNING AUTHORITY MAY BE REQUIRED FOR CONVEYANCE OF ANY OF THE LOTS SHOWN ON THIS PLAN.

EXAMINER'S CERTIFICATE
THIS PLAN WAS EXAMINED FOR COMPLIANCE WITH THE REGULATIONS UNDER THE REGISTRY ACT.

16 SEPTEMBER, 1974

BDO
PLANNING EXAMINER

REGISTRAR'S COMPILED PLAN
BEING A GRAPHIC INDEX OF
LOTS 4 and 5, JUNCTION GORE
TOWNSHIP OF GLOUCESTER
PART OF TABOR STREET, REGD PLAN 246
PART OF LOT 14
REGISTERED PLAN No. 706
ALL WITHIN THE CITY OF VANIER
REGIONAL MUNICIPALITY OF OTTAWA-CARLETON

SCALE: 1 INCH = 104.16 FT.
or 1:1250

CAUTION - THIS PLAN IS NOT A PLAN OF SURVEY - FOR OWNERSHIP AND BOUNDARY INFORMATION SEE PREVIOUSLY REGISTERED INSTRUMENTS. THIS PLAN IS NOT A PLAN OF SUBDIVISION WITHIN THE MEANING OF SECTIONS 29, 32, OR 33 OF THE PLANNING ACT.

REGISTRAR'S CERTIFICATE

THIS PLAN ACCURATELY DESIGNATES AS LOTS 4 AND 5, JUNCTION GORE, ST. STEPHEN ST. AND WHITE A. THE PARCELS OF LAND DESCRIBED IN THE RESPECTIVE INSTRUMENTS SET OUT IN THE SCHEDULE.

THIS PLAN WAS COMPILED FROM AND IS A GRAPHIC ILLUSTRATION OF INFORMATION FROM THE RECORDS OF THE REGISTRY OFFICE, AND IS NOT BASED ON ACTUAL SURVEY.

16 SEPTEMBER 1974

[Signature]
REGISTRAR

CERTIFICATE OF REGISTRATION OF PLAN

I CERTIFY THAT THIS PLAN IS DULY REGISTERED IN THE REGISTRY OFFICE FOR THE REGISTRY DIVISION OF CARLETON No. 5 AT 10:31 O'CLOCK P.M. ON THE 16 DAY OF SEPT 1974 AS No. 908

[Signature]
REGISTRAR

REARER ST.	27	28	29	30	31	32	33
2							
3							
4							
5							
6							
7							
8							
9							
10							

