

M:\2023\123069\CAD\Planning\Figures\123069-SEV.dwg, SEV 1, Jun 23, 2023 - 12:19pm, wslloss

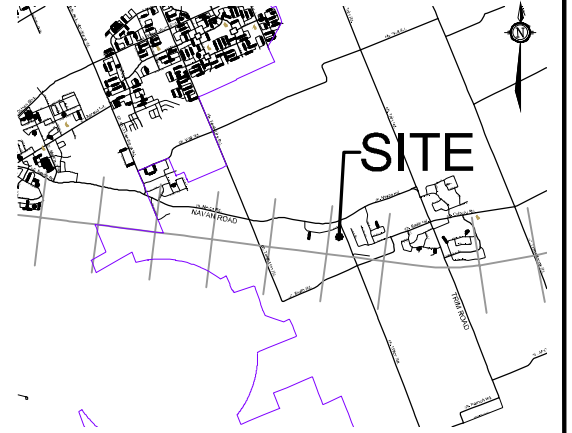
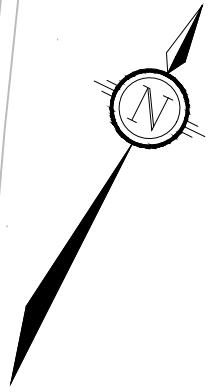
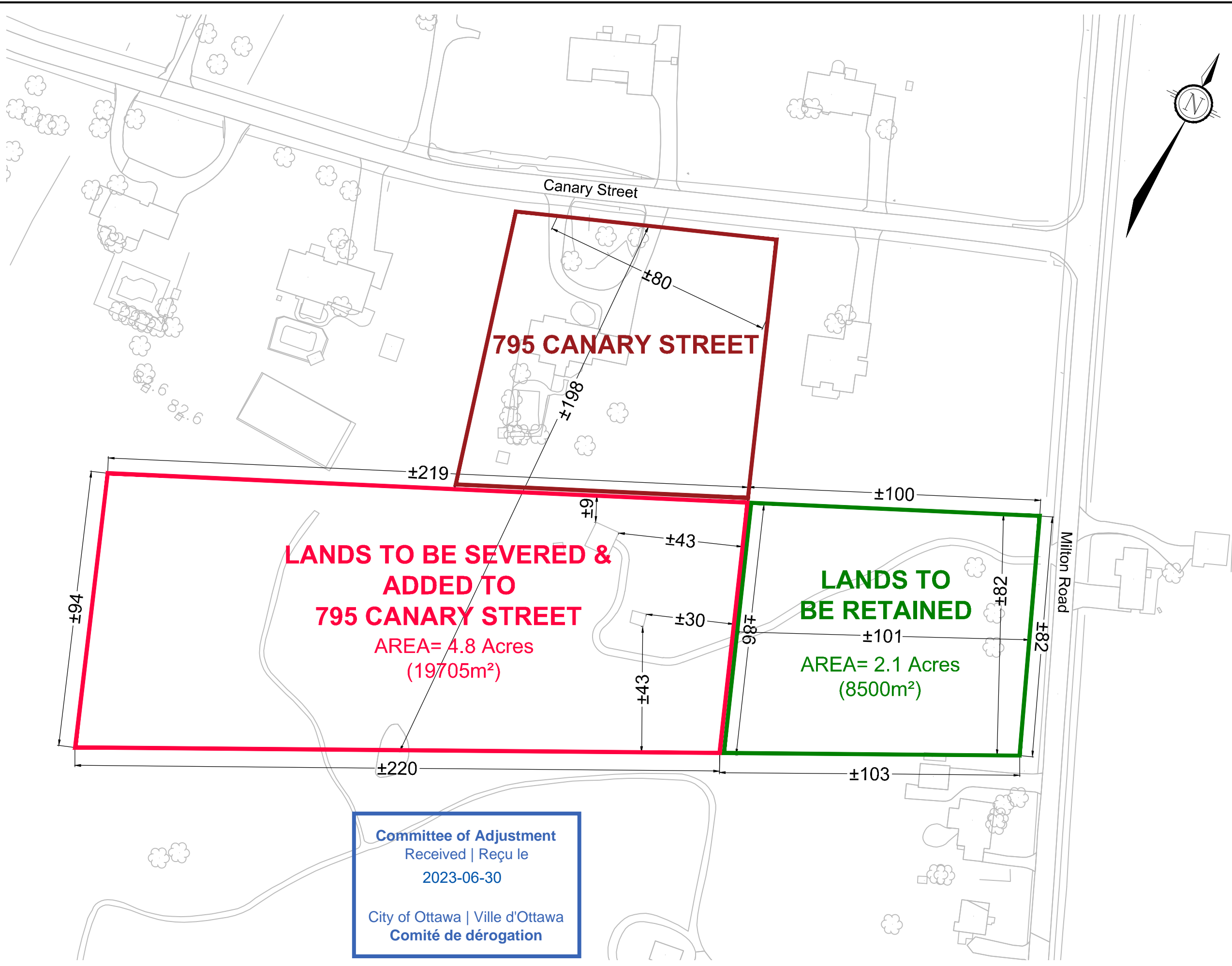

KEY PLAN
N.T.S.

CONSENT APPLICATION

3388 MILTON ROAD

PART OF LOT 10,
CONCESSION 10 CUMBERLAND
CITY OF OTTAWA

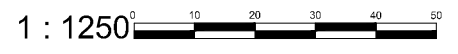

Committee of Adjustment
Received | Reçu le
2023-06-30

City of Ottawa | Ville d'Ottawa
Comité de dérogation

No.	REVISION	DATE	BY
1.	ISSUED FOR CONSENT APPLICATION	JUNE 23/23	RP

NOVATECH
Engineers, Planners & Landscape Architects
Suite 200, 240 Michael Cowpland Drive
Ottawa, Ontario, Canada K2M 1P6
Telephone (613) 254-9643
Facsimile (613) 254-5857
Website www.novatech-eng.com

ISSUED
JUNE, 2023
PROJECT No.
123069
DRAWING No.
123069-SEV