



Dendron Forestry Services

www.dendronforestry.ca

613.805.WOOD (9663)

info@dendronforestry.ca

Tree Information Report

Submitted as part of Heritage Application to the City of Ottawa

Address: 1112 Lisgar/1 Maple
Date of Report: August 17, 2023
Date of Site Visit: June 8, 2023
Prepared by: Kevin Myers, ISA Certified Arborist®
info@dendronforestry.ca

Committee of Adjustment

Received | Reçu le

2024-05-24

City of Ottawa | Ville d'Ottawa
Comité de dérogation

Client: Hobin Architecture - Todd Duckworth; tduckworth@hobinarc.com

This Report must be read in its entirety, including the Assumptions and Limiting Conditions attached herein.

Purpose of the Report

The purpose of this report is to provide the client with a detailed description of all protected trees on site as per the City of Ottawa's Tree Protection By-law No. 2020-340. This report is part of a Heritage permit application to the City of Ottawa and considers the expected impact that the proposed development will have on the trees. Plans provided by the client are reviewed as part of this report, and conclusions are made on the suitability for retaining the protected trees on the site. These conclusions may change as more information becomes available during building permitting phase.

Methodology

The following materials were reviewed as part of this report:

- Survey by Stantec Geomatics Ltd., received August 16, 2023
- Site Plan by Hobin Architecture, dated August 2023
- GeoOttawa tree inventory layer and aerial photography
- Google© Street View imagery – various years

A site visit was conducted to collect the following information from each tree classified as protected under the City of Ottawa's Tree Protection By-law No. 2020-340:

- Diameter at breast height (1.3 m from grade)
- Species
- Tree health

Tree Information and Existing site conditions

The site is currently in an unmaintained state and is being overgrown by shrubs and small trees. Among these are common buckthorn (*Rhamnus cathartica*) and Norway maples (*Acer platanoides*), both



invasive species prevalent in Ottawa. There is a cedar hedge running along the eastern and southern boundaries of the property. This hedge consists of approximately 120 stems ranging from 5-15cm DBH.

The following is an inventory of all trees that are protected under City of Ottawa Tree Protection (By-law No. 2020-340) on the site and adjacent City property. This includes Distinctive Trees (private trees with a diameter at breast height (dbh) of 30 cm or greater) and city-owned trees of all sizes. It also includes Distinctive Trees on adjacent properties whose Critical Root Zone (CRZ) extend into the subject area. The CRZ is an area around the trunk with a radius equivalent to 10 times the diameter of the trunk. This does not take into account infrastructure such as buildings and asphalt and assumes the tree has no restrictions on root growth.

Tree ¹	Species	Diameter at breast height (cm)	Ownership ²	Condition	Action	Recommendations
1	White spruce (<i>Picea glauca</i>)	36	City	Fair/Good: <25% defoliation	Retain	Retain. Care is to be taken to not tear roots when removing the existing driveway. Any roots that are torn should be cleanly severed by hand and immediately covered by a moist organic material such as burlap or soil.
2	Eastern white cedar (<i>Thuja occidentalis</i>)	40	Subject property	Good/Fair: asymmetrical crown; leaning towards road; being shaded by Norway maple growth	Retain	Retain and protect as per the City of Ottawa Tree Protection Specifications (March 2021).
3	Eastern white cedar (<i>Thuja occidentalis</i>)	35	Subject property	Good/Fair: asymmetrical crown; leaning towards road; being shaded by Norway maple growth	Retain	Retain and protect as per the City of Ottawa Tree Protection Specifications (March 2021).
4	Red oak (<i>Quercus rubra</i>)	128	City	Fair/Good: dieback in crown <30%; minor lean corrected by growth	Retain	Retain and protect as per the City of Ottawa Tree Protection Specifications (March 2021).
5	Sugar maple (<i>Acer saccharum</i>)	78	Subject property	Good: growing near wires	Retain	Retain and protect as per the City of Ottawa Tree Protection Specifications (March 2021).
6	White spruce (<i>Picea glauca</i>)	43	Subject property	Good	Remove	Remove: tree is growing directly beside existing building. Tree permit required for removal.
7	Crabapple (<i>Malus spp.</i>)	21	City	Fair/Poor: asymmetrical crown due to shading by cedar hedge; lean to road; mechanical wound at base <1/4	Retain	Retain and protect as per the City of Ottawa Tree Protection Specifications (March 2021)



				diameter – not sealing well; sprout at base becoming new tree		
8	Sugar maple (<i>Acer saccharum</i>)	14	City	Good: slight lean to road	Retain	Retain and protect as per the City of Ottawa Tree Protection Specifications (March 2021)

¹ Please refer to the attached Tree Information map for tree numbers. Note that this includes a tree layer added to the site plan (in pdf format) provided by the client. This layer includes only information about the trees and the original site plan is not altered in this process.

²Ownership of the tree in this report is based on the information provided and should not be used as a determination of ownership. For ownership disputes, a survey should be relied on. For boundary trees, consent from the adjacent property owner is required for removal as part of the application.

Proposed development and Tree Protection

Tree 1 is growing directly beside the existing driveway; it is possible there are few roots under the asphalt. Care is to be taken to not tear roots when removing the existing driveway. Any roots that are torn should be cleanly severed by hand and immediately covered by a moist organic material such as burlap or soil. If large roots require severing when installing the new driveway, a certified arborist is to be on hand to make a determination about the tree’s stability. A line of fencing to protect this tree from mechanical damage should be erected along the edge of the existing driveway.

Tree 2 and 3 are large cedars growing beside an existing metal fence. They are in a clump of trees with a large number of Norway maple (*Acer platanoides*) saplings. These are invasive trees that grow quickly and will soon shade the cedars. For best preservation of the protected trees, it is recommended that the competing brush in this clump be removed as soon as possible to release the cedars to grow freely. When replacing the pathway to the south of Tree 3, similar steps as above should be followed, and constructing the path with as little excavation as possible will help maintain this tree’s health. A large percentage of the crown of Tree 3 may have to be removed to facilitate access along the existing path.

Tree 4 is a very large red oak which should be far enough from construction to protect effectively. While erecting the appropriate Tree Protection Area should keep foot traffic away from the tree, it is recommended a certified arborist be employed to prune the dead limbs from this tree for site safety. Note that since this is a city tree, any pruning would need to be pre-approved by city forestry staff.

The only tree recommended for removal at this site is **Tree 6**. This is a large spruce growing directly beside the existing dwelling. It would be operationally difficult to renovate this building without damaging the tree, let alone construct a new building.

The remaining trees on site are far enough from expected construction to be retained effectively with proper Tree Protection Areas as described below.

Tree Protection

Prior to any site works, protective fencing should be installed around the Tree Protection Areas as indicated in the attached Tree Information Map and maintained until all construction on site has been completed as per the City of Ottawa Tree Protection Specifications (March 2021). **Failure to install and maintain fencing as described in this report may result in fines from the city.**



Within the fenced area, the following tree protection guidelines should be applied:

- Do not change the grade
- Do not store construction material
- Do not operate machinery
- Do not convert to hard surface or change the landscaping
- Do not excavate unless it is a method that has been pre-approved by the City
- Do not place signs, notices or posters to any tree
- Do not damage the root system, trunk, or branches of any tree
- Direct the exhaust away from the tree

The tree protection fencing must be 1.2 m in height and constructed of a rigid or framed material (e.g. modulus – steel, plywood hoarding, or snow fence on a 2”X4” wood frame) with posts 2.4 m apart such that the fence location cannot be altered. All supports must be placed outside of the CRZ and installation must minimize damage to existing roots.

If the fenced tree protection area must be reduced to facilitate construction, *one* of the following mitigation measures should be applied:

- Place a layer of 6-12 inches (15 to 30 cm) of woodchip mulch to the area
- Apply ¾ (2 cm) inch plywood, or road mats over a 4+ inch (10 cm) thick layer of the wood chip mulch
- Apply 4-6 inches (10 to 15 cm) of gravel over a taut, staked, geotextile fabric

The undersigned personally inspected the property and issues associated with this report on June 8, 2023. On Behalf of Dendron Forestry Services,

Kevin Myers, MFC, RPF in Training
ISA Certified Arborist®, ON-2907A
Dendron Forestry Services
kevin.myers@dendronforestry.ca; (514) 726-8531

This report has been approved by
Astrid Nielsen, Registered Professional
Forester, August 18, 2023





Above: Tree 2 and 3 - private cedars to be retained.

Right: trunks of Tree 2 (right) and Tree 3 (left)





(left to right) Tree 4 - city oak to be retained, Tree 8 - city maple to be retained, and Tree 5 - private maple to be retained.



Tree 6 - private spruce to be removed - base surrounded by buckthorn thicket



ASSUMPTIONS AND LIMITING CONDITIONS

Intended Use of the Report

This Report was prepared by Dendron Forestry Services (hereafter “Dendron”) at the request of the Client. The results, observations, interpretations, analysis, recommendations, and conclusions contained within this Report are to be used solely for the purposes outlined within this Report. All other uses are impermissible and unintended, unless specifically stated in writing in the Report.

Intended User of the Report

This Report was prepared by Dendron for the exclusive use of the Client and may not be used or relied upon by any other party. All other users are unintended and unauthorized, unless specifically stated in writing in the Report.

Limitations of this Report

This Report is based on the circumstances and on-site conditions as they existed at the time of the site inspection and the information provided by the Client and/or third parties to Dendron. On-site conditions may limit the extent of the on-site inspection(s) conducted by Dendron, including weather events such as rain, flooding, storms, winds, tornados, snowfall, snow cover, hail; obstructions including fencing, dwellings, buildings, sheds, plants, and animals; lack of access to the entire perimeter of the tree due to adjacent properties; the shape of the tree; and accessibility of the tree crown, branches, trunk, or roots for examination.

In the event that information provided by the Client or any third parties, including but not limited to documents, records, site and grading plans, permits, or representations or any site conditions are updated or change following the completion of this Report, this Report is no longer current and valid and cannot be relied upon for the purpose for which it was prepared. Dendron and its agents, assessors, and/or employees are not liable for any damages, injuries, or losses arising from amendments, revisions, or changes to the documents, records, site and grading plans, permits, representations, or other information upon which Dendron relied in preparing this Report.

No assessment of any other trees or plants has been undertaken by Dendron. Dendron and its agents, assessors, and/or employees are not liable for any other trees or plants on or around the subject Property except those expressly identified herein. The results, observations, interpretations, analysis, recommendations, and conclusions contained within this Report apply only to the trees identified herein.

Trees and plants are living organisms and subject to change, damage, and disease, and the results, observations, interpretations, analysis, recommendations, and conclusions as set out in this Report are valid only as at the date any inspections, observations, tests, and analysis took place. No guarantee, warranty, representation, or opinion is offered or made by Dendron as to the length of the validity of the results, observations, interpretations, analysis, recommendations, and conclusions contained within this Report. As a result the Client shall only rely upon this Report as representing the results, observations, interpretations, analysis, recommendations, and conclusions that were made as at the date of such inspections, observations, tests, and analysis. The trees discussed in this Report should be re-assessed periodically and at least within one year of the date of this Report.

No Opinion regarding ownership of the Tree

This Report was not prepared to make a determination as to ownership of the subject tree(s). Where ownership of the subject tree(s) is identified within this Report, said identification is based on the information provided by the Client and third parties, including surveys, permits, and site and grading plans and may not be relied upon as a guarantee, warranty, or representation of ownership.

Assumptions

This Report is based on the circumstances and conditions as they existed at the time of the site inspection and the information provided by the Client and/or third parties to Dendron. Where documents, records, site and grading plans, permits, representations, and any other information was provided to Dendron for the purpose of preparing this Report, Dendron assumed that said information was correct and up-to-date and prepared this Report in reliance on that information. Dendron and its agents, assessors, and/or employees, are not responsible for the veracity or accuracy of such information. Dendron and its agents, assessors, or employees are not liable for any damages, injuries, or losses arising from inaccuracies, errors, and/or omissions in the documents, records, site and grading plans, permits, representations, or other information upon which Dendron relied in preparing this Report.

For the purpose of preparing this Report, Dendron and its agents, assessors, and/or employees assumed that the property which is the subject of this Report is in full compliance with all applicable federal, provincial, municipal, and local statutes, regulations, by-laws, guidelines, and other related laws. Dendron and its agents, assessors, and/or employees are not liable for any issues with respect to non-compliance with any of the above-referenced statutes, regulations, bylaws, guidelines, and laws as it may pertain to or affect the property to which this Report applies.

For the purpose of preparing this Report, Dendron and its agents, assessors, and/or employee assumed that there are no hidden or unapparent conditions affecting the results, observations, interpretations, analysis, recommendations, and conclusions contained within this Report.

No Publication

The Client acknowledges and agrees that all intellectual property rights and title, including without limitation, all copyright in this Report shall remain solely with Dendron Forestry. Possession of this Report, or a copy thereof, does not entitle the Client or any third party to the right of publication or reproduction of the Report for any purpose save and except where Dendron has given its prior written consent.

Neither all nor any part of the contents of this Report shall be disseminated to the public through advertising, public relations, news, sales, the internet or other media (including, without limitation, television, radio, print or electronic media) without the prior written consent of Dendron Forestry.



Implementing the Report Recommendations

Dendron and its agents, assessors, and/or employees accept no responsibility for the implementation of any part of this Report unless specifically requested to provide oversight on the implementation of the recommendations. In the event that inspection or supervision of all or part of the implementation of the within recommendations is requested, that request shall be in writing and the details agreed to in writing by both parties.

Dendron and its agents, assessors, and/or employees are not liable for any damages or injuries arising from the manner in which the recommendations in this Report are implemented, including failure to, incorrect, or negligent implementation of the recommendations.

Further Services

Neither Dendron nor any assessor employed or retained by Dendron for the purpose of preparing or assisting in the preparation of this Report shall be required to provide any further consultation or services to the Client, save and except as already carried out in the preparation of this Report and including, without limitation, to act as an expert witness or witness in any court in any jurisdiction unless the Client has first made specific arrangements with respect to such further services, including, without limitation, providing the payment of the Report's regular hourly billing fees.

Limits of Liability

In carrying out this Report, Dendron and its agents, assessors, and/or employees have exercised a reasonable standard of care, skill, and diligence as would be customarily and normally provided in carrying out this Report. While reasonable efforts have been made to ensure that the trees recommended for retention are healthy, no guarantees are offered, or implied, that these trees, or all parts of them will remain standing. It is professionally impossible to predict with absolute certainty the behaviour of any single tree or group of trees, or all their component parts, in all given circumstances. Inevitably, a standing tree will always pose some risk. Most trees have the potential to fall, lean, or otherwise pose a danger to property and persons in the event of adverse weather conditions, and this risk can only be eliminated if the tree is removed.

Without limiting the foregoing, no liability is assumed by Dendron for:

- a) any legal description provided with respect to the Property;
- b) issues of title and or ownership respect to the Property;
- c) the accuracy of the Property line locations or boundaries with respect to the Property; and
- d) the accuracy of any other information provided to Dendron by the Client or third parties;
- e) any consequential loss, injury or damages suffered by the Client or any third parties, including but not limited to replacement costs, loss of use, earnings and business interruption; and
- f) the unauthorized distribution of the Report.

The total monetary amount of all claims or causes of action the Client may have as against Dendron Forestry, including but not limited to claims for negligence, negligent misrepresentation, and breach of contract, shall be strictly limited solely to the total amount of fees paid by the Client to Dendron Forestry pursuant to the Contract for Services dated June 1, 2023, for which this Assessment was carried out.

Further, under no circumstance may any claims be initiated or commenced by the Client against Dendron or any of its directors, officers, employees, contractors, agents, assessors, or Assessors, in contract or in tort, more than 12 months after the date of this Report.

No Third Party Liability

This Report was prepared by Dendron exclusively for the Client for the purpose set out in the Report. Any use which a third party makes of this Report, or any reliance on or decisions a third party may make based upon this Report, are made at the sole risk of any such third parties. Dendron Forestry accepts no responsibility for any damages or loss suffered by any third party or by the Client as a result of decisions made or actions based upon the unauthorized use or reliance of this Report by any such party.

General

Any plans and/or illustrations in this Report are included only to help the Client visualize the issues in this Report and shall not be relied upon for any other purpose. This report is best viewed in colour. Any copies printed in black and white may make some details difficult to properly understand. Dendron accepts no liability for misunderstandings due to a black and white copy of the report.

Notwithstanding any of the above, nothing in this Report is taken to absolve the Client of the responsibility of obtaining a new Report in the event that the circumstances of the tree change.

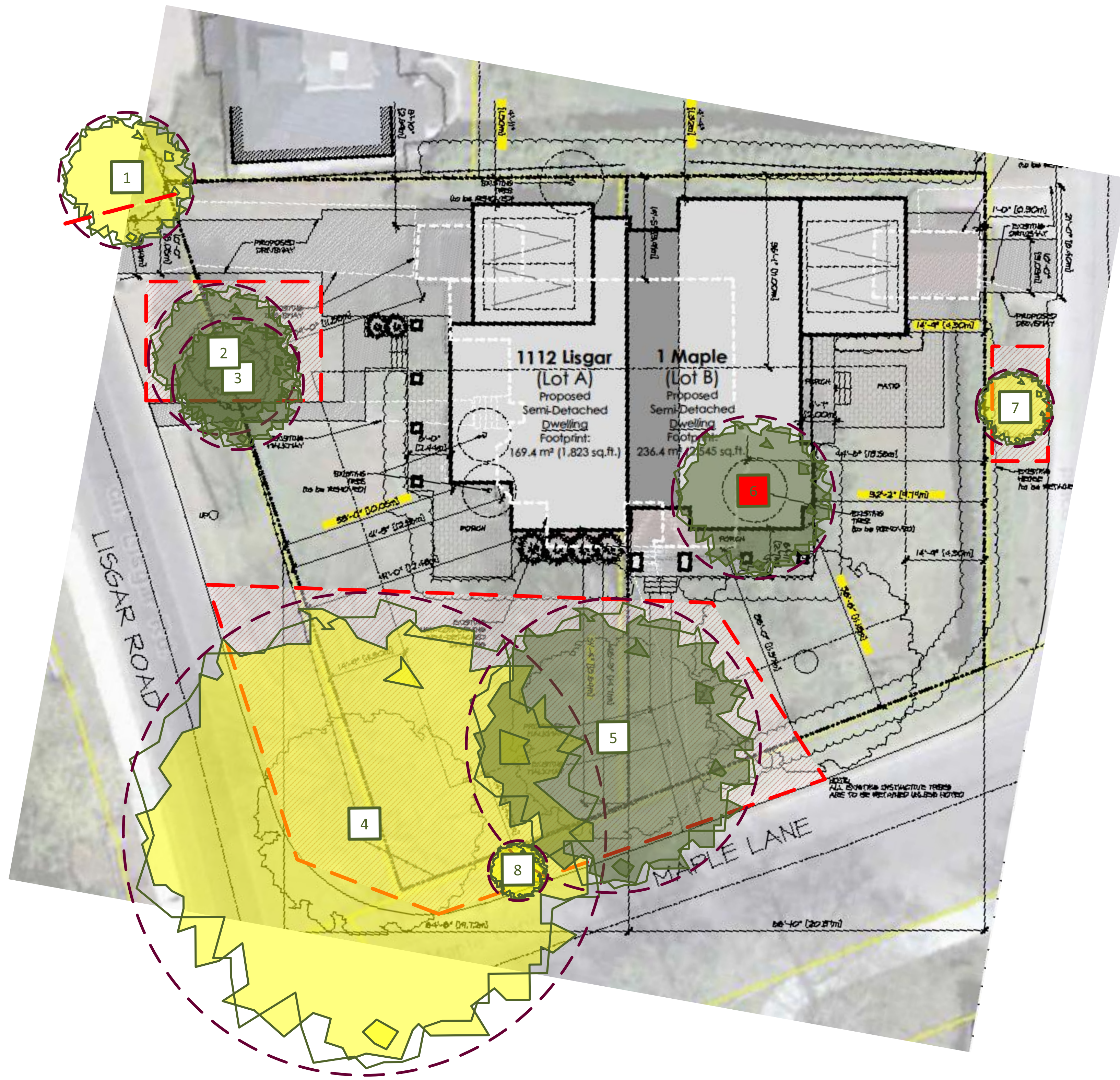

Tree ¹	Species	DBH (cm)	Condition	Recommendations
1	White spruce (<i>Picea glauca</i>)	36	Fair/Good: <25% defoliation	Retain. Care is to be taken to not tear roots when removing the existing driveway. Any roots that are torn should be cleanly severed by hand and immediately covered by a moist organic material such as burlap or soil.
2	Eastern white cedar (<i>Thuja occidentalis</i>)	40	Good/Fair: asymmetrical crown; leaning towards road; being shaded by Norway maple growth	Retain and protect as per the City of Ottawa Tree Protection Specifications (March 2021).
3	Eastern white cedar (<i>Thuja occidentalis</i>)	35	Good/Fair: asymmetrical crown; leaning towards road; being shaded by Norway maple growth	Retain and protect as per the City of Ottawa Tree Protection Specifications (March 2021).
4	Red oak (<i>Quercus rubra</i>)	128	Fair/Good: dieback in crown <30%; minor lean corrected by growth	Retain and protect as per the City of Ottawa Tree Protection Specifications (March 2021).
5	Sugar maple (<i>Acer saccharum</i>)	78	Good: growing near wires	Retain and protect as per the City of Ottawa Tree Protection Specifications (March 2021).
6	White spruce (<i>Picea glauca</i>)	43	Good	Remove: tree is growing directly beside existing building. Tree permit required for removal.
7	Crabapple (<i>Malus spp.</i>)	21	Fair/Poor: asymmetrical crown due to shading by cedar hedge; lean to road; mechanical wound at base <1/4 diameter – not sealing well; sprout at base becoming new tree	Retain and protect as per the City of Ottawa Tree Protection Specifications (March 2021)
8	Sugar maple (<i>Acer saccharum</i>)	14	Good: slight lean to road	Retain and protect as per the City of Ottawa Tree Protection Specifications (March 2021)

Tree Protection Area (TPA)

Prior to any site works, protective fencing should be installed around the TPA as indicated in Map and maintained until all construction on site has been completed as per the City of Ottawa Tree Protection Specifications (March 2021). **Failure to install and maintain the indicated fencing may result in fines from the City.**

Within the fenced area, the following tree protection guidelines should be applied:

- Do not change the grade
- Do not store construction material
- Do not operate machinery
- Do not convert to hard surface or change the landscaping
- Do not excavate unless it is a method that has been pre-approved by the City
- Do not place signs, notices or posters to any tree
- Do not damage the root system, trunk, or branches of any tree
- Direct the exhaust away from the tree

The tree protection fencing must be 1.2 m in height and constructed of a rigid or framed material (e.g. modulus – steel, plywood hoarding, or snow fence on a 2"X4" wood frame) with posts 2.4 m apart such that the fence location cannot be altered. All supports must be placed outside of the CRZ and installation must minimize damage to existing roots.

If the fenced tree protection area must be reduced to facilitate construction, *one* of the following mitigation measures should be applied:

- Place a layer of 6-12 inches (15 to 30 cm) of woodchip mulch to the area
- Apply ¾ (2 cm) inch plywood, or road mats over a 4+ inch (10 cm) thick layer of the wood chip mulch
- Apply 4-6 inches (10 to 15 cm) of gravel over a taut, staked, geotextile fabric

Legend

- Critical Root Zone
- Tree to be removed
- Tree Protection Area
- Private Tree
- Tree either fully or partly on city property
- Tree either fully or partly on adjacent property

Note: the tree layer has been added to the original site plan supplied by the client in pdf format. This layer refers to the trees only, and the original site plan has not been altered in the process. Refer to the original plan for details as quality is lost when importing the plan into the mapping software used to create the tree layer.



Tree Information Report – 112 Lisgar/1 Maple Lane
 Tree layer prepared by Dendron Forestry Services
 Version 1.0, August 17, 2023
 For more information, please contact info@dendronforestry.ca