

M:\2023\123069\CAD\Planning\Figures\123069-SEV.dwg, SEV 1, Jun 23, 2023 - 12:19pm, wslloss

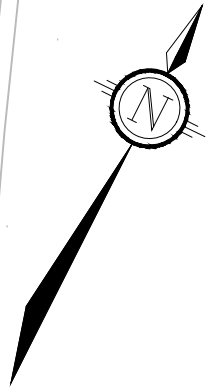
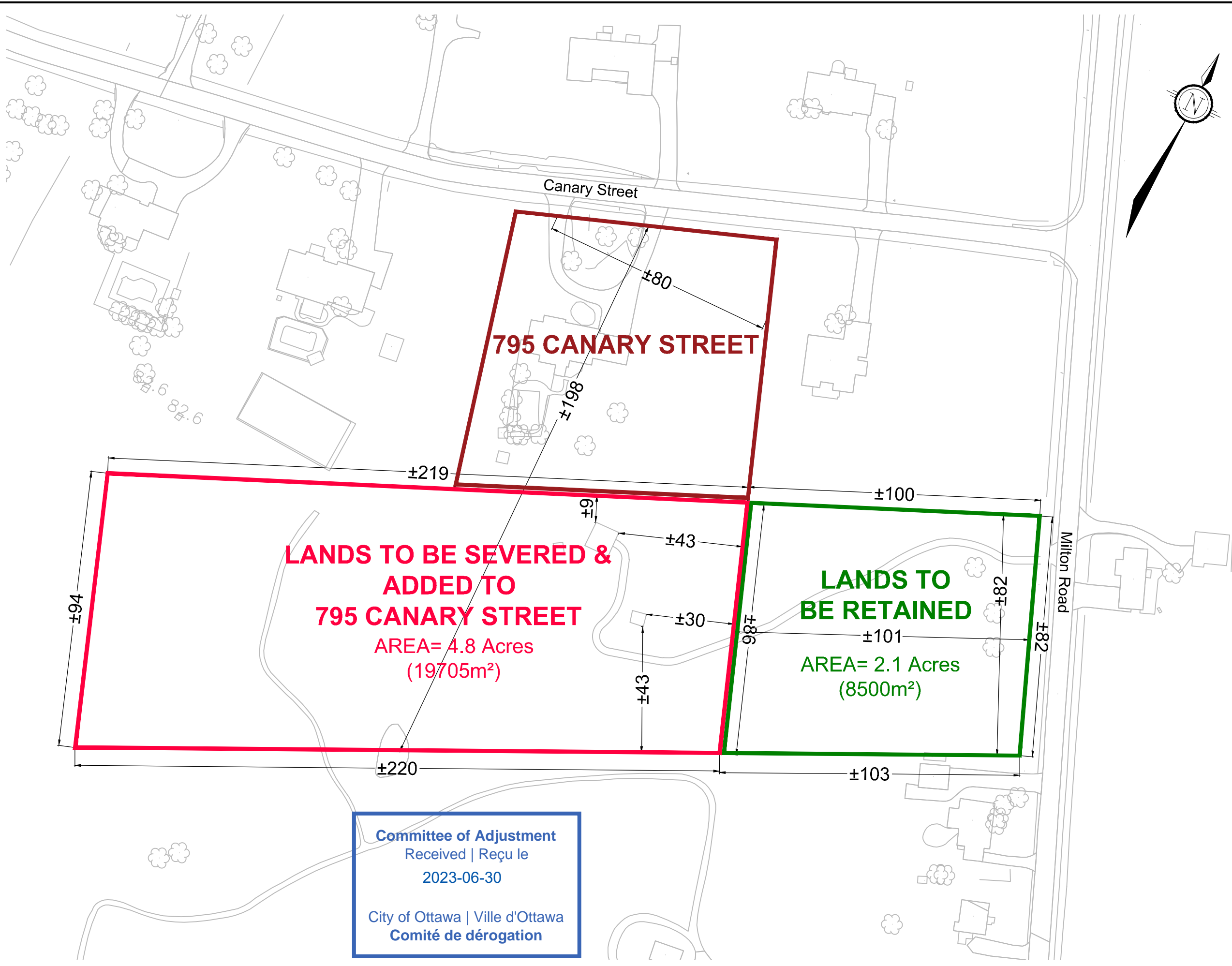

KEY PLAN  
N.T.S.

# CONSENT APPLICATION

3388 MILTON ROAD

PART OF LOT 10,  
CONCESSION 10 CUMBERLAND  
CITY OF OTTAWA

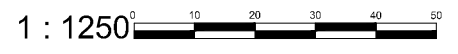

Committee of Adjustment  
Received | Reçu le  
2023-06-30  
  
City of Ottawa | Ville d'Ottawa  
Comité de dérogation

No.	REVISION	DATE	BY
1.	ISSUED FOR CONSENT APPLICATION	JUNE 23/23	RP

**NOVATECH**  
Engineers, Planners & Landscape Architects  
Suite 200, 240 Michael Cowpland Drive  
Ottawa, Ontario, Canada K2M 1P6  
Telephone (613) 254-9643  
Facsimile (613) 254-5857  
Website www.novatech-eng.com

ISSUED  
JUNE, 2023  
PROJECT No.  
123069  
DRAWING No.  
123069-SEV