

This document is presented in the language it was provided.
Ce document est présenté dans la langue dans laquelle il a été fourni.

53 SLADE CRESCENT TREE INFORMATION REPORT

Committee of Adjustment
Received | Reçu le

2024-07-08

City of Ottawa | Ville d'Ottawa
Comité de dérogation



DATE: JULY 4, 2024

OTTAWA TREE REPORTS
SCOTT PETRIE

Table of Contents

Introduction 3

 Contact Information 3

 Policy Framework 3

Tree Information 4

 Tree Inventory and Assessment Methodology 4

 Subject Trees 4

 Impacted Trees 4

 Tree Protection Details 6

Tree Compensation and Replanting 7

Summary 7

 Application Fees 8

APPENDIX A 9

 Tree Information Table 10

 Tree Identification Plan 11

APPENDIX B 12

 Tree Protection Specification 13

 Tree Protection Plan 14

Self-Declaration Statement 15

Introduction

Ottawa Tree Reports was retained by Mazen Chaaraoui of The Good Guys Contracting to complete a Tree Information Report in support of a Minor Variance Application and pergola construction for the property located at 53 Slade Crescent in Ottawa, Ontario.

The work plan for this Tree Information Report included the following:

- Prepare inventory of the tree resources on the subject property and within vicinity of impact on adjacent neighbouring property;
- Evaluate potential tree protection and preservation opportunities based on proposed site plans; and
- Document the findings in a Tree Information Report.

Contact Information

Owner Information:

Name: Ferass Elrayes
 Phone #: 613-762-0731
 Email: ferass.elrayes@gmail.com

Arborist Information:

Name: Scott Petrie
 Phone #: 613-204-8687
 Email: info@ottawatreereports.com

Contractor Information:

Name:
 Phone #:
 Email:

Policy Framework

The subject property is subject to the provisions of the City of Ottawa's Tree Protection By-law 2020-340. The purpose of this by-law is for the protection of municipal trees and municipal natural areas in the City of Ottawa and trees on private property in the urban area of the City of Ottawa.

City of Ottawa tree protection requirements were applied during the Tree Information Report planning process. These protection requirements indicate a minimum distance at which the critical root zone (CRZ) must be protected.

The CRZ distances allow for maximum development potential while providing sufficient space to ensure the tree(s) are not subject to any long term adverse due to the impacts of development. In instances where the CRZ will be encroached upon and impacted, an Adjusted Tree Protection Zone (Adj TPZ)

has been calculated based upon impacts to the CRZ; further mitigation measure may be required to ensure there are no adverse long-term impacts to the tree(s).

Tree Information

Field assessments were conducted on June 13, 2024, the results of the assessment are provided in the Tree Information Table found in Appendix “A”.

Tree Inventory and Assessment Methodology

All trees on the subject property and those that maybe impacted on adjacent properties were inventoried and assessed, with specific focus on trees that are protected and thus subject to the provisions of the City of Ottawa’s Tree Protection By-law 2020-340.

Tree inspections were limited to visual, on-ground examinations. No boring, probing, or sonic tomography was employed during the assessments. Any data and information collected is based on the conditions at the time of inspection.

The trees located on City of Ottawa property (Walden Park) are greater than 3 m laterally and 1m vertically (below) from the property line and will not be impacted by the proposed works

Subject Trees

A total of four (4) protected trees were inventoried on the subject property, it was determined that three (3) protected trees will be impacted by the proposed works. Please refer to the table below for the number of trees, number of impacted trees, and the distribution of protection status and type of impact.

Table 1 – Tree Information Dashboard

# of Trees Inventoried	# of Protected Trees	# Protected Tree Impacts	Protected Tree Removals		Protected Tree Injuries	
			# of City Trees	# of Private Trees	# of City Trees	# of Private Trees
4	4	3	0	0	0	3

Impacted Trees

The three protected tree that will be impacted by the proposed works have been identified for CRZ injury; no protected trees are to be removed. The impacted trees will be further discussed below (See Table 2), based on their location and proximity to proposed work, and the nature of impact to be incurred.

Table 2 – Tree Impact Table

Tree #	Species		DBH (cm)	Ownership	By-Law Protected	Condition			Arborist Recommendations
	Common	Botanical				(Poor/Fair/Good)			
						Trunk	Canopy	Canopy	
						Integrity	Structure	Vigour	
1	Honey Locust	<i>Gleditsia triocanthos</i>	49	Private	Yes	G	G	G	Protect & Injure
2	White Pine	<i>Pinus strobus</i>	47	Private	Yes	G	F	G	Protect & Injure
4	White Pine	<i>Pinus strobus</i>	47	Private	Yes	G	G	G	Protect & Injure

Tree 1 is a 49 cm Honey Locust *Gleditsia triocanthos*, completely located on the subject property with a CRZ of 4.9m. The proposed walkway will be installed along the westerly limits of the CRZ of this tree approximately less than 10% of the tree’s roots system will be injured due excavation for the proposed works. Preconstruction root pruning is recommended to occur along the limits of the proposed walkway. This tree shall be retained and protected.

Tree 2 is a 45 cm White Pine *Pinus strobus*, completely located on the subject property with a CRZ of 4.5m. The proposed installation and excavation for the pergolas sanitary line will be approximately located 3 m NW from the base of this tree; approximately less than 10% of the tree’s roots system will be injured due excavation for the proposed works. Preconstruction root pruning is recommended to occur within the CRZ along excavation limits for the proposed sewer line. This tree shall be retained and protected.

Tree 4 is a 47 cm White Pine *Pinus strobus*, completely located on the subject property with a CRZ of 4.7m. The proposed pergola’s foundation and excavation will be approximately located 2.5 m NW from the base of this tree; approximately less than 10% of the tree’s roots system will be injured due excavation for the proposed works. Preconstruction root pruning is recommended to occur within the CRZ along excavation limits for the proposed pergola. This tree shall be retained and protected.

For all impacted trees identified, it is recommended that a preconstruction root pruning (grinding) operation to occur to cleanly severe the roots according to arboricultural best practices, this to ensure they’re not negatively damaged by the proposed works. It is recommended that the root grinding be performed as prescribed, under the supervision of Ottawa Tree Reports. Lastly preconstruction tree pruning is recommended for Trees 2 and 4 to at minimum to remove the lowest whorl branch extending NW into the yard for both trees.

Tree Protection Details

Four protected trees are required to have tree protection measures installed as outlined in the City of Ottawa’s Tree Protection Specification in Appendix “B”. Tree protection measures are recommended to be installed prior to the commencement of the proposed works to ensure tree resources designated for retention and protection are not impacted by the development. The tree protections should be maintained throughout the duration of the proposed works until final grading and landscaping are complete, or as otherwise directed by City of Ottawa staff.

Unless otherwise indicated, tree protection shall be installed at the minimum extent of the CRZ.

Table 3 – Tree Protection Table

Tree #	Species		DBH (cm)	Ownership	By-Law Protected	Arborist Recommendations	CRZ (m)	CRZ Impacted	Recommended Excavation Limit (m)	Adj TPZ (m)	Specification Recommendations	Notes
	Common	Botanical										
1	Honey Locust	<i>Gleditsia triacanthos</i>	49	Private	Yes	Injure/ Protect	4.9	Yes	2.45	2.45	Plywood Snowfence	preconstruction root pruning
2	White Pine	<i>Pinus strobus</i>	45	Private	Yes	Injure/ Protect	4.5	No	NA	2.25	Plywood	preconstruction branch and root pruning
3	White Pine	<i>Pinus strobus</i>	36	Private	Yes	Protect	3.6	No	NA	NA	Plywood	
4	White Pine	<i>Pinus strobus</i>	47	Private	Yes	Injure/ Protect	4.7	Yes	2.3	2.3	Plywood	preconstruction branch and root pruning

Tree 1 is a 49 cm Honey Locust *Gleditsia triacanthos*, that is entirely located on the subject property’s front yard with a CRZ of 4.9m. Tree protection measures are recommended to be installed due to protect the CRZ from the proposed new walkway to the rear yard, material storage, and construction access to the rear yard. At minimum tree protection measures shall be installed 0.3m from the edge of the new walkway. Remaining tree protections measures shall be installed according the Tree Protection Plan.

Tree 2 is a 45 cm White Pine *Pinus strobus*, that is entirely located on the subject property’s backyard with a CRZ of 4.5m. It is recommended that tree protection measures be installed 4.9 m (east) perpendicular from the base of the tree at the property line, then proceed NW to the adjusted TPZ of 2.25m north of this tree to meet the continuous line going west to include Trees 3 and 4. Tree protections measures shall be installed according the Tree Protection Plan

Tree 3 is a 37cm White Pine *Pinus strobus* that is entirely located on the subject property’s backyard, with a CRZ of 3.7m. It is recommended that this tree be retained, protected, and measures installed according to the Tree Protection Plan.

Tree 4 is a 47cm White Pine *Pinus strobus*, that is entirely located on the subject property’s backyard, with a CRZ of 4.7 m. Tree protection measures shall be installed at the property line 2.3 m SW from the base of the tree, then proceed NW until 4.7m from the NW corner of the tree then, proceed parallel to the property line in a continuous line to the adj TPZ of Tree number 2.

Tree Compensation and Replanting

No trees are proposed to be removed with the associated works; therefore, Tree Compensation and Replanting is not required.

Summary

Ottawa Tree Reports was retained by Mazen Chaaoui of The Good Guys Contracting to complete a Tree Information Report in support of a Minor Variance Application and pergola construction for the property located at 53 Slade Crescent in Ottawa, Ontario.

The findings of the tree inventory indicate a total of four (4) protected trees on the subject property, three (3) of these trees have been identified for CRZ injury. All tree resources inventoried may be preserved and retained provided appropriate tree protection measures are implemented.

The following recommendations are suggested to minimize impacts to trees identified for protection. Refer to Tree Protection Drawing in Appendix "B" for additional tree preservation plan notes and the tree protection fence details.

- Tree protection barriers and fencing should be erected at locations prescribed on Tree Protection Drawing in accordance to the Tree Protection Specification in Appendix "B".
- Tree protection measures will have to be implemented prior to construction phase to ensure the trees identified for preservation and protection are not impacted by the development.
- Branches and roots that extend past prescribed critical root zone and/or adjusted tree protection zones that require pruning must be pruned by a qualified Arborist or other tree professional. All pruning of tree roots and branches must be in accordance with good arboricultural practices.
- Site visits, pre, during and post construction is recommended by Ottawa Tree Reports to ensure proper utilization of tree protection barriers.

Trees should also be inspected for damage incurred during construction to ensure appropriate corrective pruning or other mitigation measures are implemented.

Application Fees

No application fees are required to be paid at the time of this application, if a City of Ottawa Tree requires removal further fees will be administered by the City.

Respectfully Submitted,

Scott Petrie

**Scott Petrie, Dip EMT, EDDM
Ottawa Tree Reports**

APPENDIX A

Tree Information Table

Table 4 – Tree Information Table

Tree #	Species		DBH (cm)	Ownership	By-Law Protected	Condition			Arborist Recommendations	Tree Planting Required	Planting #s	CRZ (m)	CRZ Impacted	Recommendations Excavation Limit (m)	Adj TPZ (m)	Specification Recommendations	Notes
	Common	Botanical				(Poor/Fair/Good)											
						Trunk	Canopy	Canopy									
						Integrity	Structure	Vigour									
1	Honey locust	<i>Gleditsia triocanthos</i>	49	Private	Yes	G	G	G	Injure/Protect	No	0	4.9	Yes	2.45	2.45	Plywood Snowfence	preconstruction root pruning
2	White Pine	<i>Pinus strobus</i>	45	Private	Yes	G	F	G	Injure/Protect	No	0	4.5	Yes	2.25	2.25	Plywood	preconstruction branch and root pruning
3	White Pine	<i>Pinus strobus</i>	36	Private	Yes	G	G	G	Protect	No	0	3.6	No	NA	NA	Plywood	
4	White Pine	<i>Pinus strobus</i>	47	Private	Yes	G	G	G	Injure/Protect	No	0	4.7	Yes	2.3	2.3	Plywood	preconstruction branch and root pruning

Tree Identification Plan

53 Slade Crescent

Tree Identification Plan

Tree Information Table

Tree #	Species		DBH (cm)	Ownership	By-Law protected	Condition (Poor/Fair/Good)			Arborist Recommendations
	Common	Botanical				Trunk	Canopy	Canopy	
						Integrity	Structure	Vigour	
1	Honey locust	<i>Gleditsia triacanthos</i>	49	Private	Yes	G	G	G	Injure/Protect
2	White Pine	<i>Pinus strobus</i>	45	Private	Yes	G	F	G	Injure/Protect
3	White Pine	<i>Pinus strobus</i>	36	Private	Yes	G	G	G	Protect
4	White Pine	<i>Pinus strobus</i>	47	Private	Yes	G	G	G	Injure/Protect

OTTAWA TREE REPORTS
www.ottawatree reports.com
info@ottawatree reports.com
 613-204-8687

APPENDIX B

Tree Protection Specification

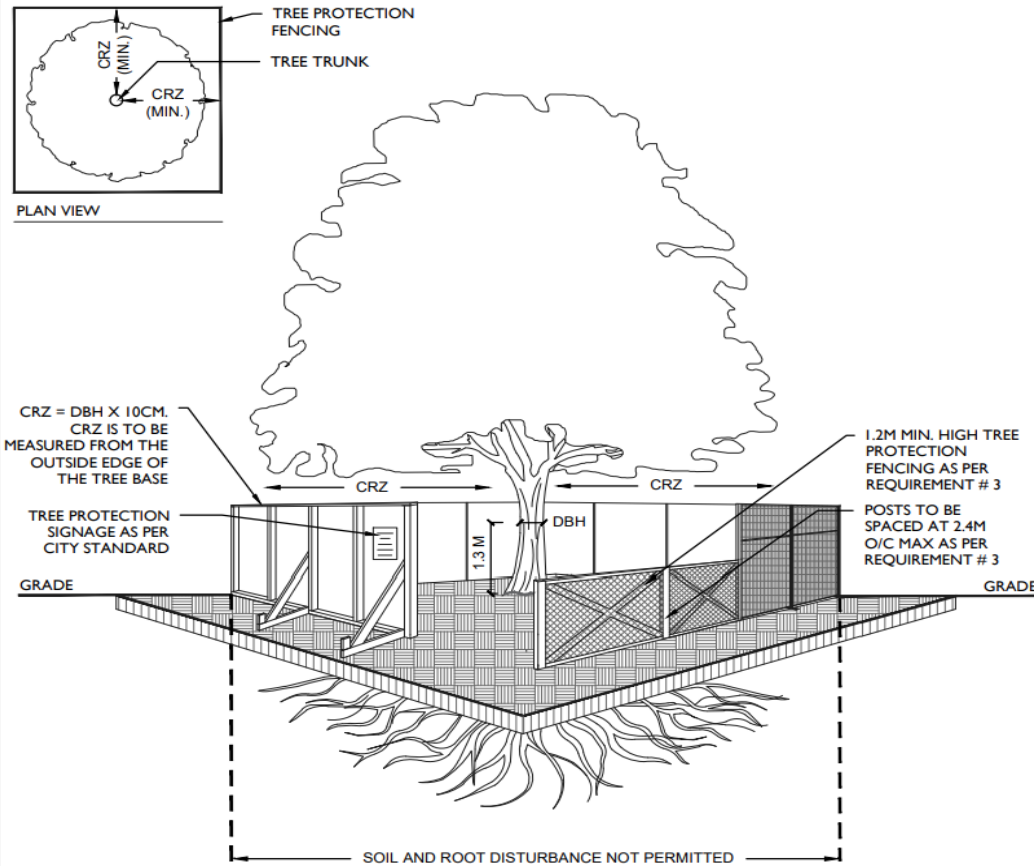

TREE PROTECTION REQUIREMENTS:

1. PRIOR TO ANY WORK ACTIVITY WITHIN THE CRITICAL ROOT ZONE (CRZ = 10 X DIAMETER) OF A TREE, TREE PROTECTION FENCING MUST BE INSTALLED SURROUNDING THE CRITICAL ROOT ZONE, AND REMAIN IN PLACE UNTIL THE WORK IS COMPLETE.
2. UNLESS PLANS ARE APPROVED BY CITY FORESTRY STAFF, FOR WORK WITHIN THE CRZ:
 - DO NOT PLACE ANY MATERIAL OR EQUIPMENT - INCLUDING OUTHOUSES;
 - DO NOT ATTACH ANY SIGNS, NOTICES OR POSTERS TO ANY TREE;
 - DO NOT RAISE OR LOWER THE EXISTING GRADE;
 - TUNNEL OR BORE WHEN DIGGING;
 - DO NOT DAMAGE THE ROOT SYSTEM, TRUNK, OR BRANCHES OR ANY TREE;
 - ENSURE THAT EXHAUST FUMES FROM ALL EQUIPMENT ARE NOT DIRECTED TOWARD ANY TREE CANOPY.
 - DO NOT EXTEND HARD SURFACE OR SIGNIFICANTLY CHANGE LANDSCAPING
3. TREE PROTECTION FENCING MUST BE AT LEAST 1.2M IN HEIGHT, AND CONSTRUCTED OF RIGID OR FRAMED MATERIALS (E.G. MODULOC - STEEL, PLYWOOD HOARDING, OR SNOW FENCE ON A 2"X4" WOOD FRAME) WITH POSTS 2.4M APART, SUCH THAT THE FENCE LOCATION CANNOT BE ALTERED. ALL SUPPORTS AND BRACING MUST BE PLACED OUTSIDE OF THE CRZ, AND INSTALLATION MUST MINIMISE DAMAGE TO EXISTING ROOTS. (SEE DETAIL)
4. THE LOCATION OF THE TREE PROTECTION FENCING MUST BE DETERMINED BY AN ARBORIST AND DETAILED ON ANY ASSOCIATED PLANS FOR THE SITE (E.G. TREE CONSERVATION REPORT, TREE INFORMATION REPORT, ETC). THE PLAN AND CONSTRUCTED FENCING MUST BE APPROVED BY CITY FORESTRY STAFF PRIOR TO THE COMMENCEMENT OF WORK.
5. IF THE FENCED TREE PROTECTION AREA MUST BE REDUCED TO FACILITATE CONSTRUCTION, MITIGATION MEASURES MUST BE PRESCRIBED BY AN ARBORIST AND APPROVED BY CITY FORESTRY STAFF. THESE MAY INCLUDE THE PLACEMENT OF PLYWOOD, WOOD CHIPS, OR STEEL PLATING OVER THE ROOTS FOR PROTECTION OR THE PROPER PRUNING AND CARE OF ROOTS WHERE ENCOUNTERED.

THE CITY'S TREE PROTECTION BY-LAW, 2020-340 PROTECTS BOTH CITY-OWNED TREES, CITY-WIDE, AND PRIVATELY-OWNED TREES WITHIN THE URBAN AREA. PLEASE REFER TO WWW.OTTAWA.CA/TREEBYLAW FOR MORE INFORMATION ON HOW THE TREE BY-LAW APPLIES.

ACCESSIBLE FORMATS AND COMMUNICATION SUPPORTS ARE AVAILABLE, UPON REQUEST



TREE PROTECTION SPECIFICATION

TO BE IMPLEMENTED FOR RETAINED TREES, BOTH ON SITE AND ON ADJACENT SITES, PRIOR TO ANY TREE REMOVAL OR SITE WORKS AND MAINTAINED FOR THE DURATION OF WORK ACTIVITIES ON SITE.

SCALE:	NTS
DATE:	MARCH 2021
DRAWING NO.:	1 of 1

Tree Protection Plan

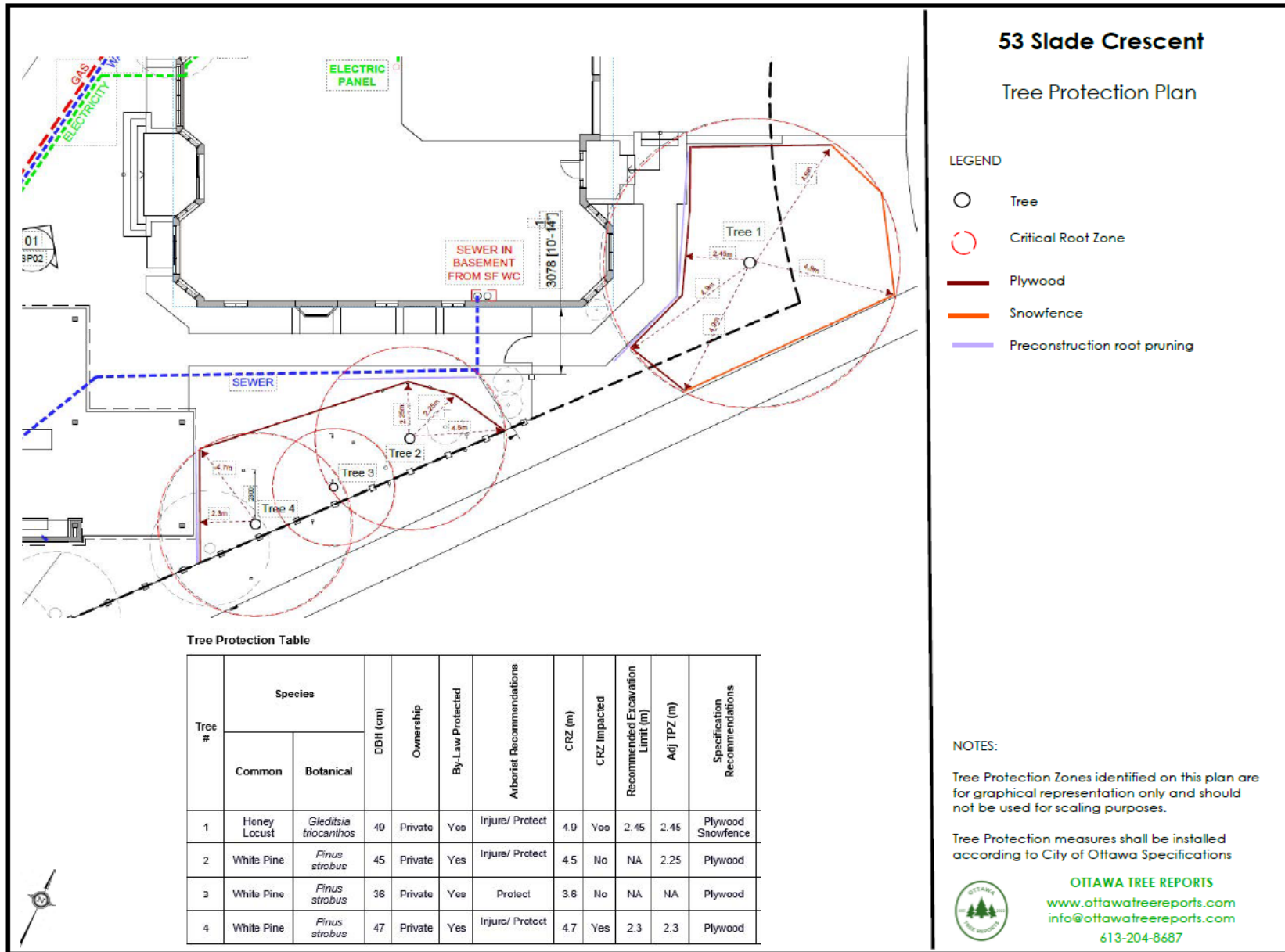

Tree Protection Table

Tree #	Species		DBH (cm)	Ownership	By-Law Protected	Arborist Recommendations	CRZ (m)	CRZ Impacted	Recommended Excavation Limit (m)	Adj. IPZ (m)	Specification Recommendations
	Common	Botanical									
1	Honey Locust	<i>Gleditsia triacanthos</i>	49	Private	Yes	Injure/ Protect	4.9	Yes	2.45	2.45	Plywood Snowfence
2	White Pine	<i>Pinus strobus</i>	45	Private	Yes	Injure/ Protect	4.5	No	NA	2.25	Plywood
3	White Pine	<i>Pinus strobus</i>	36	Private	Yes	Protect	3.6	No	NA	NA	Plywood
4	White Pine	<i>Pinus strobus</i>	47	Private	Yes	Injure/ Protect	4.7	Yes	2.3	2.3	Plywood

Self-Declaration Statement

By signing this application declaration, the owner, arborist and contractor (if known at time of application) which confirms that all parties agree with the information provided and will respect the proposed work and mitigation measures (if required). Furthermore, the signature of the owner is also acknowledging and understanding that a City of Ottawa Forestry Staff may enter your property at a reasonable time for the purpose of carrying out an inspection. You also acknowledge and understand that failure to abide by the recommendations of the approved Tree Information Report, damaging or destructing trees identified for protection, you will be responsible to bear fully the cost of compensation, removal and replacement.

It is the owner/applicant's responsibility to ensure that all protection and mitigation measures described in the Tree Information Report are followed, and where necessary are done so under the supervision of an arborist.

Owner/Applicant

Print Name

Signature

Arborist

Scott Petrie

Scott Petrie

Print Name

Signature

Contractor

Print Name