



Tree Information Report

Submitted as part of Committee of Adjustment Application to the City of Ottawa

Date of Report: November 4, 2024
Property Address: 1975 Banff Avenue
Prepared for: Jordan Khoury; jordan@360cci.com
Prepared by: Kevin Myers, ISA Certified Arborist®; kevin.myers@dendronforestry.ca
Date of Site Visit: October 28, 2024

Committee of Adjustment
Received | Reçu le

2024-11-18

City of Ottawa | Ville d'Ottawa
Comité de dérogation

This Report must be read in its entirety, including the Assumptions and Limiting Conditions.

Purpose of the Report

The purpose of this report is to provide the client with a detailed description of all protected trees on site as per the City of Ottawa's Tree Protection By-law No. 2020-340. This report is part of a Committee of Adjustment application to the City of Ottawa and considers the impact that the proposed development will have on the trees. The assessment of the suitability of tree retention is based on the information provided at the time of report preparation which includes:

- Survey by Annis, O'Sullivan, Vollebakk Ltd., dated July 26, 2024
- Site plan by Evolution Design and Drafting, dated October 23, 2014

This assessment does not consider additional factors that could influence tree retainability such as:

- site grading, and requirement for retaining walls and/or swales
- installation of services for the new units
- capping of existing water and sewer services
- installation of gas lines for the new units
- site access

The potential for retaining those tree(s) identified for retention in this report may change as more information on the site-specific construction details is provided during the building permitting phase. For those trees that are recommended for retention, mitigation measures are provided to reduce the impact during construction. It should be noted that the construction phase includes all site works that could impact trees, from the capping of services at the beginning to the final landscaping steps at the end.

While a rationale for removing trees may be provided based on document review, **this report does not grant permission to remove trees: a permit from the city must be received before removal of distinctive trees can occur.**



Methodology

The following materials were reviewed as part of this report:

- Survey
- Site Plan
- GeoOttawa tree inventory layer and aerial photography
- Google© Street View imagery – various years

A site visit was conducted to collect the following information from each tree classified as protected under the City of Ottawa’s Tree Protection By-law No. 2020-340:

- Diameter at breast height (1.3 m from grade)
- Species
- Tree health
- Pertinent measurements to structures such as fences, driveways, or building

Existing site information

Appendix A is an inventory of all trees that are protected under City of Ottawa Tree Protection (By-law No. 2020-340) on the site and adjacent City property. This includes Distinctive Trees (private trees with a diameter at breast height (dbh) of 30 cm or greater) and city-owned trees of all sizes. It also includes Distinctive Trees on adjacent properties whose Critical Root Zone (CRZ) extend into the subject area. The CRZ is an area around the trunk with a radius equivalent to 10 times the diameter of the trunk. This does not take into account infrastructure such as buildings and asphalt and assumes the tree has no restrictions on root growth.

Proposed development and Tree protection

Tree 1 is a Scot’s pine in fair condition. It has been heavily pruned around the overhead wires, but on Google Streetview imagery from August 2021 it shows a large crown; so the tree has suffered significant canopy loss within the last three years. While its rooting zone will be disturbed due to construction, it is expected the remaining soft landscaping in the boulevard and front yard will provide the tree sufficient rooting space to recover after construction. To allow for efficient site works, the rooting zone to the north of the tree is to be protected with a 6” layer of mulch.

Tree Protection

Prior to any site works, protective fencing should be installed around the Tree Protection Area as indicated in the attached Tree Information Map and maintained until all construction on site has been completed as per the City of Ottawa Tree Protection Specifications (March 2021).

Failure to install and maintain fencing as shown on the attached map may result in fines from the city.

Within the fenced area, the following tree protection guidelines should be applied:

- Do not change the grade
- Do not store construction material
- Do not operate machinery
- Do not convert to hard surface or change the landscaping



- Do not excavate unless it is a method that has been pre-approved by the City
- Do not place signs, notices or posters to any tree
- Do not damage the root system, trunk, or branches of any tree
- Direct the exhaust away from the tree

The tree protection fencing must be 1.2 m in height and constructed of a rigid or framed material (e.g. modulus – steel, plywood hoarding, or snow fence on a 2”X4” wood frame) with posts 2.4 m apart such that the fence location cannot be altered. All supports must be placed outside of the CRZ and installation must minimize damage to existing roots.

If the fenced tree protection area must be reduced to facilitate construction, *one* of the following mitigation measures should be applied:

- Place a layer of 6-12 inches (15 to 30 cm) of woodchip mulch to the area
- Apply ¾ (2 cm) inch plywood, or road mats over a 4+ inch (10 cm) thick layer of the wood chip mulch
- Apply 4-6 inches (10 to 15 cm) of gravel over a taut, staked, geotextile fabric

The undersigned personally inspected the property and issues associated with this report on October 28, 2024. On Behalf of Dendron Forestry Services,

Kevin Myers, MFC, RPF in Training
ISA Certified Arborist®, ON-2907A
kevin.myers@dendronforestry.ca
(514) 726-8531



APPENDIX A

TREE INFORMATION TABLE

Tree ¹	Species	DBH (cm)	Ownership ²	Tree condition	Approximate distance to excavation (m)	Action	Forester recommendation
1	Scot's pine (<i>Pinus sylvestris</i>)	61	City	Fair/Poor: large amounts of canopy removed – asymmetrical crown remaining – large pruning wounds; slight lean west	2	Retain	Retain and protect as per the City of Ottawa Tree Protection Specifications (March 2021).
2	Sugar maple (<i>Acer saccharum</i>)	36	City	Poor: extensive decay in leader and scaffold branch	Path: 0	Remove	Remove due to health condition. Tree permit required for removal.
3	Manitoba maple (<i>Acer negundo</i>)	40, 30, 16	Subject property	Poor: failure at main union – heavy lean increases risk; majority of canopy removed – asymmetrical crown	0	Remove	Remove: within excavation area. Also in poor condition and should be removed based on health. Tree permit required for removal.
4	White spruce (<i>Picea glauca</i>)	31, 34	Subject property	Fair: majority of crown removed from smaller stem – pruned around wires; decay at main union	0	Remove	Remove: within proposed driveway. Tree permit required for removal.
5	Manitoba maple (<i>Acer negundo</i>)	35	Subject property	Poor: growing on fence; large portion of canopy removed around wires	0	Remove	Remove: within proposed driveway. Tree permit required for removal.
6	Manitoba maple (<i>Acer negundo</i>)	80, 60 (estimate)	Adjacent – 1977 Banff	Poor: extensive decay in large stem; stems with heavy leans	4.75	Retain	Retain. No mitigations required; far enough from construction

¹ Please refer to the attached Tree Information map for tree numbers. Note that this includes a tree layer added to the site plan (in pdf format) provided by the client. This layer includes only information about the trees and the original site plan is not altered in this process.

²Ownership of the tree in this report is based on the information provided and should not be used as a determination of ownership. For ownership disputes, a survey should be relied on. For boundary trees, consent from the adjacent property owner is required for removal as part of the application.

³Trees on adjacent properties do not include a full assessment. The diameters are estimated, and the health is estimated based on what is visible from the subject property. Trees along the property line may also have limited health assessments if part of the tree is not visible.



APPENDIX B

PHOTOGRAPHS



Clockwise from above: Tree 1 - city pine to be retained.

Tree 2 - city maple to be removed.

Failure of main union of Tree 3.

Tree 3 - private maple to be removed.





Clockwise from left: Tree 4 - private spruce to be removed.

Tree 6 - adjacent maple to be retained.

Stem of Tree 5 - private maple to be removed

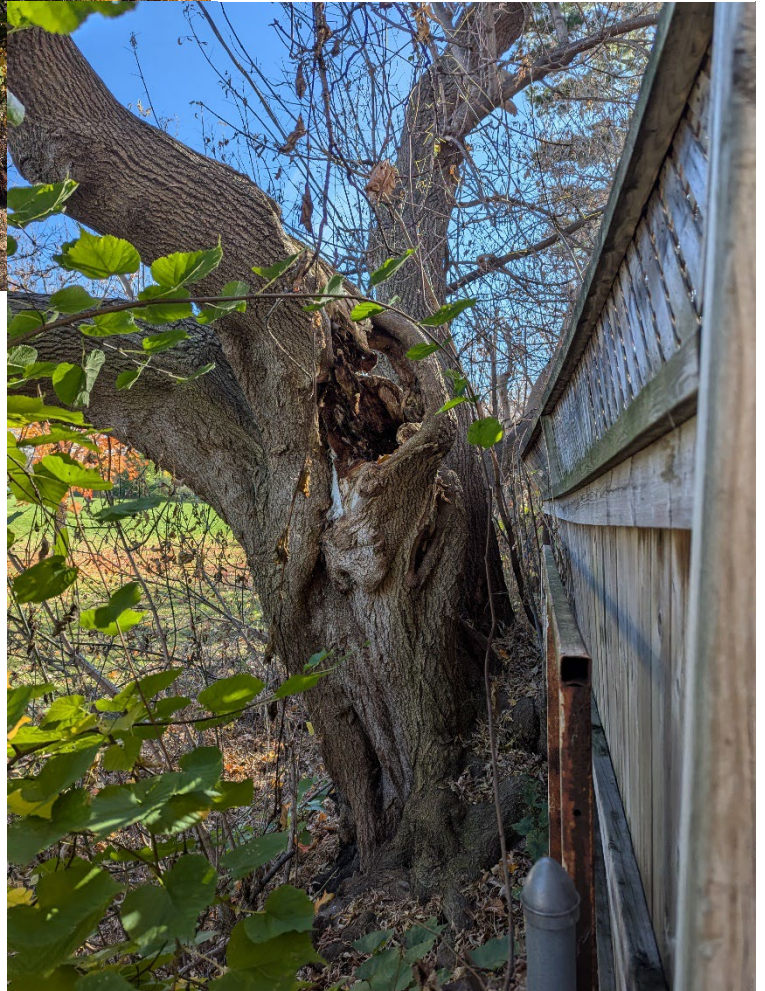



APPENDIX C

ASSUMPTIONS AND LIMITING CONDITIONS

Intended Use of the Report

This Report was prepared by Dendron Forestry Services (hereafter “Dendron”) at the request of the Client. The results, observations, interpretations, analysis, recommendations, and conclusions contained within this Report are to be used solely for the purposes outlined within this Report. All other uses are impermissible and unintended, unless specifically stated in writing in the Report.

Intended User of the Report

This Report was prepared by Dendron for the exclusive use of the Client and may not be used or relied upon by any other party. All other users are unintended and unauthorized, unless specifically stated in writing in the Report.

Limitations of this Report

This Report is based on the circumstances and on-site conditions as they existed at the time of the site inspection and the information provided by the Client and/or third parties to Dendron. On-site conditions may limit the extent of the on-site inspection(s) conducted by Dendron, including weather events such as rain, flooding, storms, winds, tornados, snowfall, snow cover, hail; obstructions including fencing, dwellings, buildings, sheds, plants, and animals; lack of access to the entire perimeter of the tree due to adjacent properties; the shape of the tree; and accessibility of the tree crown, branches, trunk, or roots for examination.

In the event that information provided by the Client or any third parties, including but not limited to documents, records, site and grading plans, permits, or representations or any site conditions are updated or change following the completion of this Report, this Report is no longer current and valid and cannot be relied upon for the purpose for which it was prepared. Dendron and its agents, assessors, and/or employees are not liable for any damages, injuries, or losses arising from amendments, revisions, or changes to the documents, records, site and grading plans, permits, representations, or other information upon which Dendron relied in preparing this Report.

No assessment of any other trees or plants has been undertaken by Dendron. Dendron and its agents, assessors, and/or employees are not liable for any other trees or plants on or around the subject Property except those expressly identified herein. The results, observations, interpretations, analysis, recommendations, and conclusions contained within this Report apply only to the trees identified herein.

Trees and plants are living organisms and subject to change, damage, and disease, and the results, observations, interpretations, analysis, recommendations, and conclusions as set out in this Report are valid only as at the date any inspections, observations, tests, and analysis took place. No guarantee, warranty, representation, or opinion is offered or made by Dendron as to the length of the validity of the results, observations, interpretations, analysis, recommendations, and conclusions contained within this Report. As a result the Client shall only rely upon this Report as representing the results, observations, interpretations, analysis, recommendations, and conclusions that were made as at the date of such inspections, observations, tests, and analysis. The trees discussed in this Report should be re-assessed periodically and at least within one year of the date of this Report.

No Opinion regarding ownership of the Tree

This Report was not prepared to make a determination as to ownership of the subject tree(s). Where ownership of the subject tree(s) is identified within this Report, said identification is based on the information provided by the Client and third parties, including surveys, permits, and site and grading plans and may not be relied upon as a guarantee, warranty, or representation of ownership.

Assumptions

This Report is based on the circumstances and conditions as they existed at the time of the site inspection and the information provided by the Client and/or third parties to Dendron. Where documents, records, site and grading plans, permits, representations, and any other information was provided to Dendron for the purpose of preparing this Report, Dendron assumed that said information was correct and up-to-date and prepared this Report in reliance on that information. Dendron and its agents, assessors, and/or employees, are not responsible for the veracity or accuracy of such information. Dendron and its agents, assessors, or employees are not liable for any damages, injuries, or losses arising from inaccuracies, errors, and/or omissions in the documents, records, site and grading plans, permits, representations, or other information upon which Dendron relied in preparing this Report.

For the purpose of preparing this Report, Dendron and its agents, assessors, and/or employees assumed that the property which is the subject of this Report is in full compliance with all applicable federal, provincial, municipal, and local statutes, regulations, by-laws, guidelines, and other related laws. Dendron and its agents, assessors, and/or employees are not liable for any issues with respect to non-compliance with any of the above-referenced statutes, regulations, bylaws, guidelines, and laws as it may pertain to or affect the property to which this Report applies.

For the purpose of preparing this Report, Dendron and its agents, assessors, and/or employee assumed that there are no hidden or unapparent conditions affecting the results, observations, interpretations, analysis, recommendations, and conclusions contained within this Report.

No Publication



The Client acknowledges and agrees that all intellectual property rights and title, including without limitation, all copyright in this Report shall remain solely with Dendron Forestry. Possession of this Report, or a copy thereof, does not entitle the Client or any third party to the right of publication or reproduction of the Report for any purpose save and except where Dendron has given its prior written consent.

Neither all nor any part of the contents of this Report shall be disseminated to the public through advertising, public relations, news, sales, the internet or other media (including, without limitation, television, radio, print or electronic media) without the prior written consent of Dendron Forestry.

Implementing the Report Recommendations

Dendron and its agents, assessors, and/or employees accept no responsibility for the implementation of any part of this Report unless specifically requested to provide oversight on the implementation of the recommendations. In the event that inspection or supervision of all or part of the implementation of the within recommendations is requested, that request shall be in writing and the details agreed to in writing by both parties.

Dendron and its agents, assessors, and/or employees are not liable for any damages or injuries arising from the manner in which the recommendations in this Report are implemented, including failure to, incorrect, or negligent implementation of the recommendations.

Further Services

Neither Dendron nor any assessor employed or retained by Dendron for the purpose of preparing or assisting in the preparation of this Report shall be required to provide any further consultation or services to the Client, save and except as already carried out in the preparation of this Report and including, without limitation, to act as an expert witness or witness in any court in any jurisdiction unless the Client has first made specific arrangements with respect to such further services, including, without limitation, providing the payment of the Report's regular hourly billing fees.

Limits of Liability

In carrying out this Report, Dendron and its agents, assessors, and/or employees have exercised a reasonable standard of care, skill, and diligence as would be customarily and normally provided in carrying out this Report. While reasonable efforts have been made to ensure that the trees recommended for retention are healthy, no guarantees are offered, or implied, that these trees, or all parts of them will remain standing. It is professionally impossible to predict with absolute certainty the behaviour of any single tree or group of trees, or all their component parts, in all given circumstances. Inevitably, a standing tree will always pose some risk. Most trees have the potential to fall, lean, or otherwise pose a danger to property and persons in the event of adverse weather conditions, and this risk can only be eliminated if the tree is removed.

Without limiting the foregoing, no liability is assumed by Dendron for:

- a) any legal description provided with respect to the Property;
- b) issues of title and or ownership respect to the Property;
- c) the accuracy of the Property line locations or boundaries with respect to the Property; and
- d) the accuracy of any other information provided to Dendron by the Client or third parties;
- e) any consequential loss, injury or damages suffered by the Client or any third parties, including but not limited to replacement costs, loss of use, earnings and business interruption; and
- f) the unauthorized distribution of the Report.

The total monetary amount of all claims or causes of action the Client may have as against Dendron Forestry, including but not limited to claims for negligence, negligent misrepresentation, and breach of contract, shall be strictly limited solely to the total amount of fees paid by the Client to Dendron Forestry pursuant to the Contract for Services dated October 24, 2024, for which this Assessment was carried out.

Further, under no circumstance may any claims be initiated or commenced by the Client against Dendron or any of its directors, officers, employees, contractors, agents, assessors, or Assessors, in contract or in tort, more than 12 months after the date of this Report.

No Third Party Liability

This Report was prepared by Dendron exclusively for the Client for the purpose set out in the Report. Any use which a third party makes of this Report, or any reliance on or decisions a third party may make based upon this Report, are made at the sole risk of any such third parties. Dendron Forestry accepts no responsibility for any damages or loss suffered by any third party or by the Client as a result of decisions made or actions based upon the unauthorized use or reliance of this Report by any such party.

General

Any plans and/or illustrations in this Report are included only to help the Client visualize the issues in this Report and shall not be relied upon for any other purpose. This report is best viewed in colour. Any copies printed in black and white may make some details difficult to properly understand. Dendron accepts no liability for misunderstandings due to a black and white copy of the report.

Notwithstanding any of the above, nothing in this Report is taken to absolve the Client of the responsibility of obtaining a new Report in the event that the circumstances of the tree change.

Note: the tree layer has been added to the original base layer supplied by the client in pdf format. This layer refers to the trees only, and the original base has not been altered in the process, although it may be cropped. Refer to the original plan for details as quality is lost when importing the plan into the software used to create the tree layer.

Base Layer: Site plan by Evolution Design and Drafting, dated October 23, 2024

TIR Map – 1975 Banff Avenue		
Date	Revision	Prepared By
29/10/2024	Version 1	KM

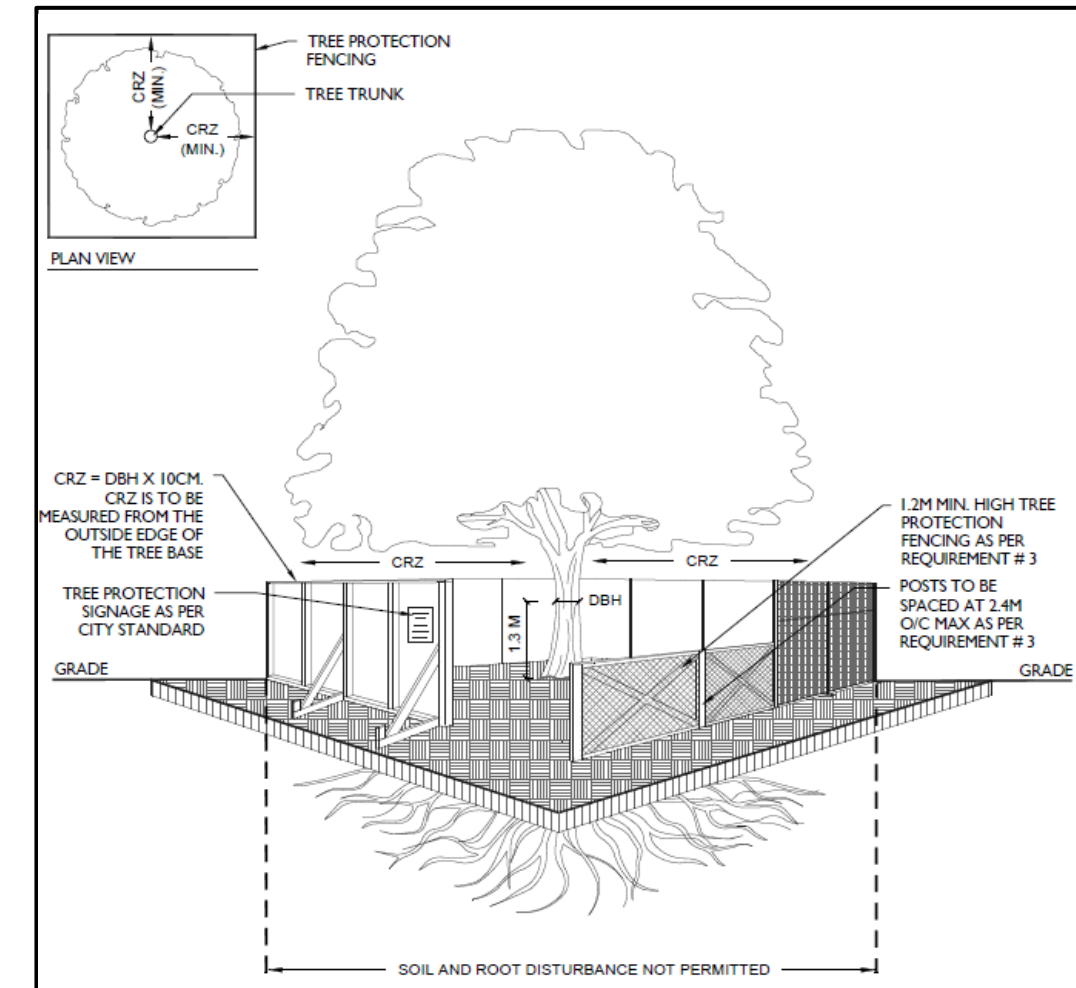

Failure to install and maintain fencing as described in this report may result in fines from the city.

- TREE PROTECTION REQUIREMENTS:**
- PRIOR TO ANY WORK ACTIVITY WITHIN THE CRITICAL ROOT ZONE (CRZ = 10 X DIAMETER) OF A TREE, TREE PROTECTION FENCING MUST BE INSTALLED SURROUNDING THE CRITICAL ROOT ZONE, AND REMAIN IN PLACE UNTIL THE WORK IS COMPLETE.
 - UNLESS PLANS ARE APPROVED BY CITY FORESTRY STAFF, FOR WORK WITHIN THE CRZ:
 - DO NOT PLACE ANY MATERIAL OR EQUIPMENT - INCLUDING OUTHOUSES;
 - DO NOT ATTACH ANY SIGNS, NOTICES OR POSTERS TO ANY TREE;
 - DO NOT RAISE OR LOWER THE EXISTING GRADE;
 - TUNNEL OR BORE WHEN DIGGING;
 - DO NOT DAMAGE THE ROOT SYSTEM, TRUNK, OR BRANCHES OR ANY TREE;
 - ENSURE THAT EXHAUST FUMES FROM ALL EQUIPMENT ARE NOT DIRECTED TOWARD ANY TREE CANOPY.
 - DO NOT EXTEND HARD SURFACE OR SIGNIFICANTLY CHANGE LANDSCAPING
 - TREE PROTECTION FENCING MUST BE AT LEAST 1.2M IN HEIGHT, AND CONSTRUCTED OF RIGID OR FRAMED MATERIALS (E.G. MODULOC - STEEL, PLYWOOD HOARDING, OR SNOW FENCE ON A 2"X4" WOOD FRAME) WITH POSTS 2.4M APART, SUCH THAT THE FENCE LOCATION CANNOT BE ALTERED. ALL SUPPORTS AND BRACING MUST BE PLACED OUTSIDE OF THE CRZ, AND INSTALLATION MUST MINIMISE DAMAGE TO EXISTING ROOTS. (SEE DETAIL)
 - THE LOCATION OF THE TREE PROTECTION FENCING MUST BE DETERMINED BY AN ARBORIST AND DETAILED ON ANY ASSOCIATED PLANS FOR THE SITE (E.G. TREE CONSERVATION REPORT, TREE INFORMATION REPORT, ETC). THE PLAN AND CONSTRUCTED FENCING MUST BE APPROVED BY CITY FORESTRY STAFF PRIOR TO THE COMMENCEMENT OF WORK.
 - IF THE FENCED TREE PROTECTION AREA MUST BE REDUCED TO FACILITATE CONSTRUCTION, MITIGATION MEASURES MUST BE PRESCRIBED BY AN ARBORIST AND APPROVED BY CITY FORESTRY STAFF. THESE MAY INCLUDE THE PLACEMENT OF PLYWOOD, WOOD CHIPS, OR STEEL PLATING OVER THE ROOTS FOR PROTECTION OR THE PROPER PRUNING AND CARE OF ROOTS WHERE ENCOUNTERED.
- THE CITY'S TREE PROTECTION BY-LAW, 2020-340 PROTECTS BOTH CITY-OWNED TREES, CITY-WIDE, AND PRIVATELY-OWNED TREES WITHIN THE URBAN AREA. PLEASE REFER TO WWW.OTTAWA.CA/TREEBYLAW FOR MORE INFORMATION ON HOW THE TREE BY-LAW APPLIES.

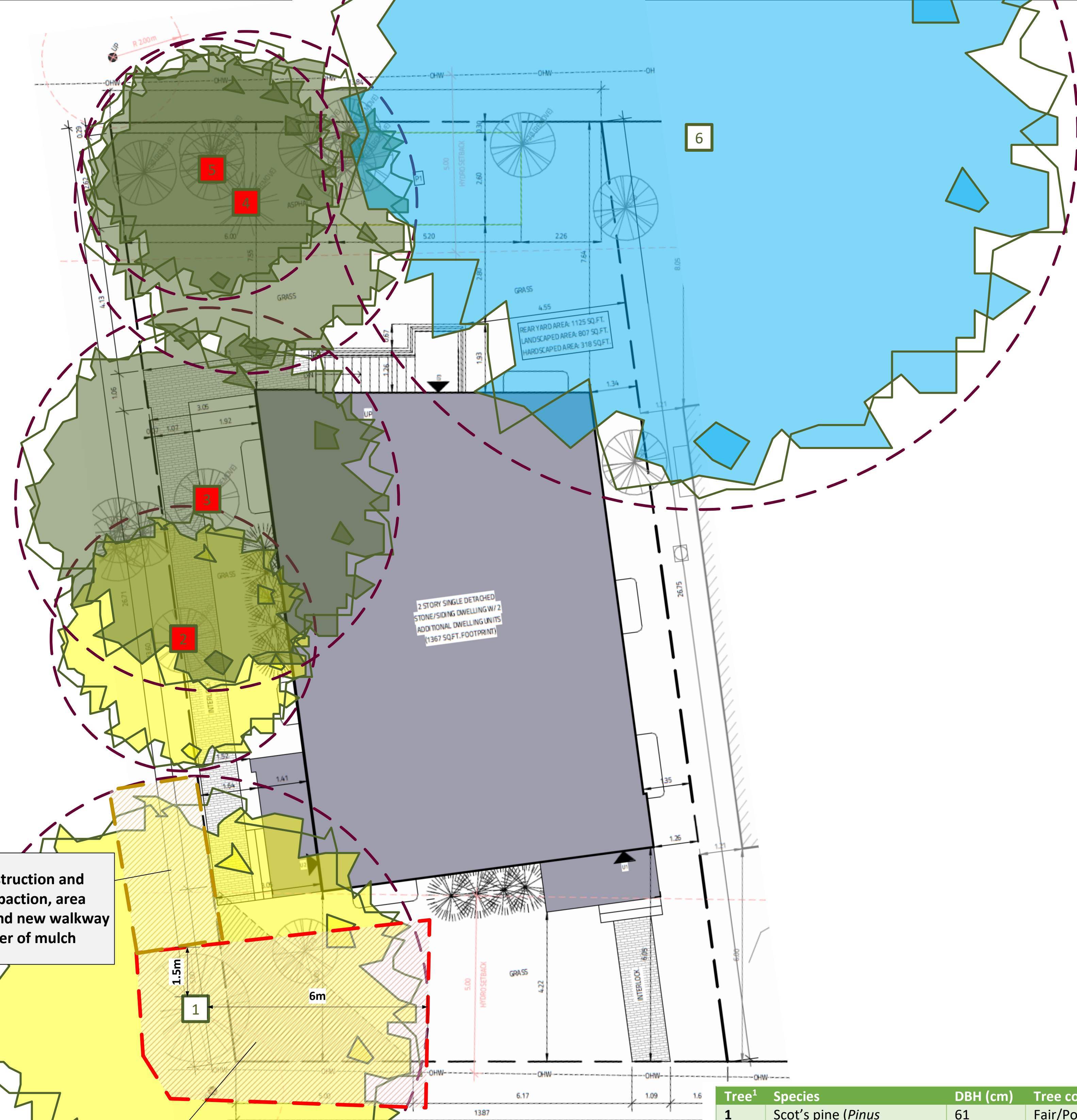

To facilitate construction and prevent soil compaction, area between sidewalk and new walkway to have a 6" layer of mulch

TPA to extend from edge of sidewalk to line of excavation

BANFF AVE.

Tree ¹	Species	DBH (cm)	Tree condition	Forester recommendation
1	Scot's pine (<i>Pinus sylvestris</i>)	61	Fair/Poor: large amounts of canopy removed – asymmetrical crown remaining – large pruning wounds; slight lean west	Retain and protect as per the City of Ottawa Tree Protection Specifications (March 2021).
2	Sugar maple (<i>Acer saccharum</i>)	36	Poor: extensive decay in leader and scaffold branch	Remove due to health condition. Tree permit required for removal.
3	Manitoba maple (<i>Acer negundo</i>)	40, 30, 16	Poor: failure at main union – heavy lean increases risk; majority of canopy removed – asymmetrical crown	Remove: within excavation area. Also in poor condition and should be removed based on health. Tree permit required for removal.
4	White spruce (<i>Picea glauca</i>)	31, 34	Fair: majority of crown removed from smaller stem – pruned around wires; decay at main union	Remove: within proposed driveway. Tree permit required for removal.
5	Manitoba maple (<i>Acer negundo</i>)	35	Poor: growing on fence; large portion of canopy removed around wires	Remove: within proposed driveway. Tree permit required for removal.
6	Manitoba maple (<i>Acer negundo</i>)	80, 60 (estimate)	Poor: extensive decay in large stem; stems with heavy leans	Retain. No mitigations required; far enough from construction

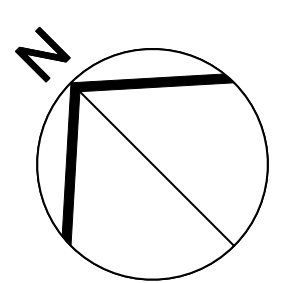

Legend

- Critical Root Zone (as defined in By-Law 2020-340)
- Private Tree
- Tree either fully or partly on adjacent property
- Tree either fully or partly on city property
- Tree Protection Area
- Tree to be removed