

**BRIDOR**  
Developments

CLIENT:  
956-8 St. Augustin Rd  
Ottawa, ON K1M 1R6  
Tel: (613) 443-3575

CONSULTANTS

ARCHITECTS:  
**BRYDEN GIBSON**  
ARCHITECTS INCORPORATED  
1066 Somerset Street West, Suite 200, Ottawa, Ontario, K1V 4T3  
Telephone: 613 724 9914 E-mail: architecture@brydengibson.ca

CIVIL ENGINEERS:  
**TATHAM**  
ENGINEERING

LEGEND

- PROPOSED SAWCUT CONCRETE WALKWAY
- PROPOSED DECIDUOUS TREE
- PROPOSED CONIFEROUS TREE
- PROPOSED SOD
- PROPOSED IRONSTONE MULCH
- EXISTING TREE TO REMAIN
- GROUP OF EXISTING TREES TO REMAIN
- EXISTING TREE TO BE REMOVED
- PROPOSED TREE PROTECTION FENCE

7	ISSUED FOR SITE PLAN CONTROL	11/29/2024	WF	JL
6	REVISED PER NEW SITE PLAN	07/20/2023	ML	JL
5	REVISED PER NEW SITE PLAN	07/07/2023	ML	JL
4	REVISED PER NEW CIVIL DRAWING	04/17/2023	ML	JL
3	REVISED PER CITY COMMENTS	01/24/2023	ML	JL
2	REVISED PER NEW SITE PLAN	11/22/2022	ML	JL
1	ISSUED FOR SITE PLAN CONTROL	05/31/2022	ML	JL

**JAMES B. LENNOX & ASSOCIATES INC.**  
**LANDSCAPE ARCHITECTS**  
3332 CARLING AVE. OTTAWA, ONTARIO K2J 5A8  
Tel: (613) 722-5168 Fax: (866) 343-3942

PROJECT  
4 STOREY APARTMENT BUILDINGS  
3817-3843 INNES ROAD, OTTAWA ON

DRAWING  
TREE CONSERVATION REPORT &  
LANDSCAPE PLAN

SCALE  
AS SHOWN

START DATE  
FEBRUARY 2022

PROJECT NO.  
22MIS2221

DRAWING NO.  
L.1

PLOT SIZE ARCH-D

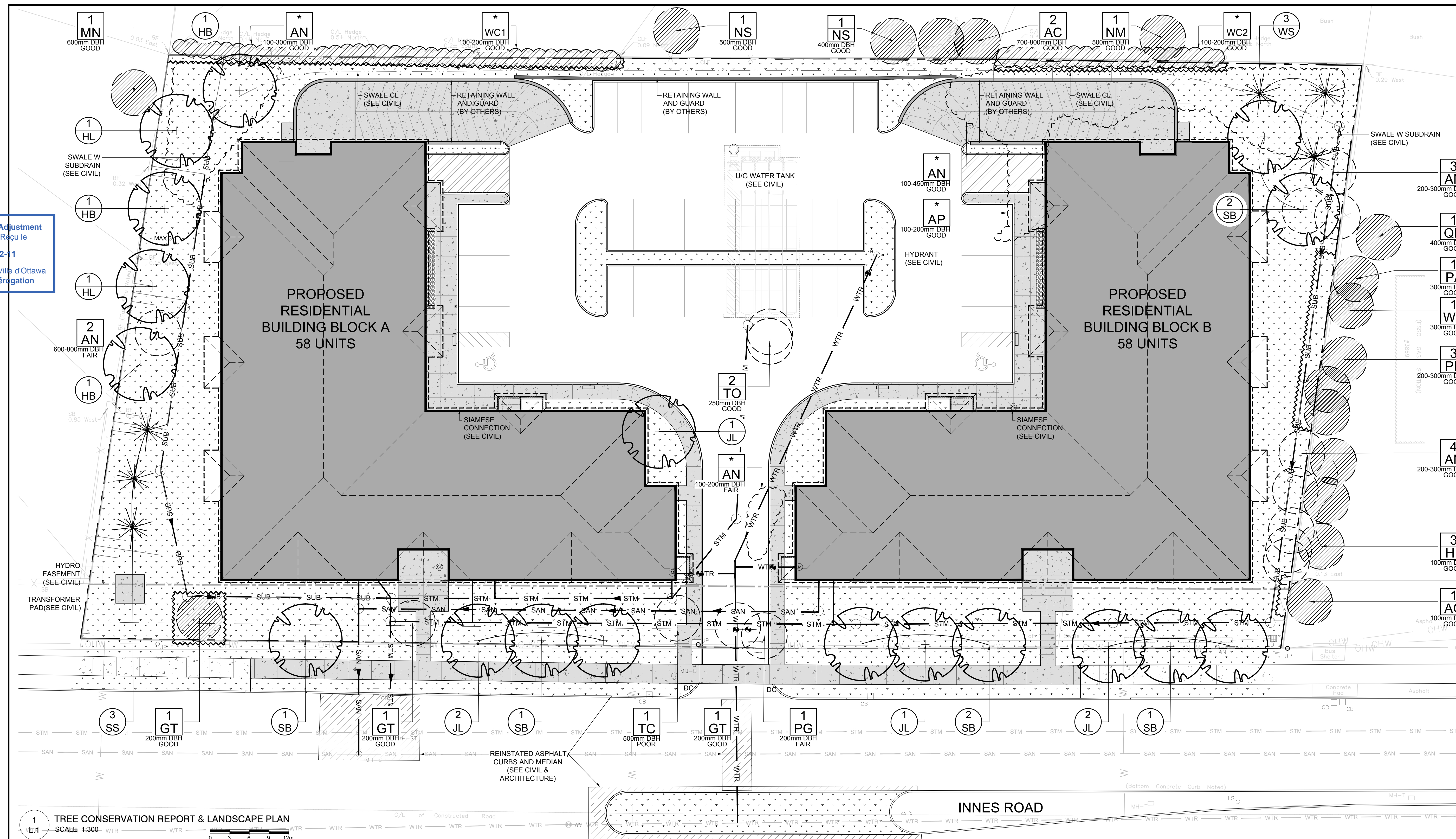

Committee of Adjustment  
Received | Reçu le  
2024-12-11  
City of Ottawa | Ville d'Ottawa  
Comité de dérogation

**EXISTING TREE LIST**

KEY	QTY	BOTANICAL NAME	COMMON NAME	SIZE	CONDITION	REMARKS	OWNERSHIP
AC	2	Acer negundo	Manitoba Maple	700-800mm DBH	GOOD	To remain	6662 Drolet St.
AG	1	Acer ginnala	Amur Maple	100mm DBH	GOOD	To remain	3869 Innes Rd.
AN	*	Acer negundo	Manitoba Maple	100-800mm DBH	FAIR-GOOD	To be removed	3813, 3843, 3835 Innes
AP	*	Acer platanoides	Norway Maple	100-200mm DBH	GOOD	To be removed	3835 Innes Rd.
GT	3	Gleditsia triacanthos	Honey Locust	200mm DBH	GOOD	See plan	3817 & 3853 Innes
HL	3	Gleditsia triacanthos	Honey Locust	100mm DBH	GOOD	To remain	3869 Innes Rd.
MN	1	Acer negundo	Manitoba Maple	600mm DBH	GOOD	See plan	1411 Markwell Cr.
NM	1	Acer platanoides	Norway Maple	500mm DBH	GOOD	To remain	3869 Innes Rd.
NS	2	Picea abies	Norway Spruce	400-500mm DBH	GOOD	To remain	6662 Drolet St.
PA	1	Picea abies	Norway Spruce	300mm DBH	GOOD	To remain	3869 Innes Rd.
PG	1	Picea glauca	White Spruce	200mm DBH	FAIR	To remain	3869 Innes Rd.
PP	3	Picea pungens	Colorado Spruce	200-300mm DBH	GOOD	To remain	3869 Innes Rd.
QR	1	Quercus rubra	Red Oak	450mm DBH	GOOD	To remain	3869 Innes Rd.
TC	1	Tilia cordata	Littleleaf Linden	500mm DBH	POOR	To be removed	3869 Innes Rd.
TO	2	Thuja occidentalis	White Cedar	250mm DBH	GOOD	To be removed	3835 Innes Rd.
WC1	*	Thuja occidentalis	White Cedar	100-200mm DBH	GOOD	To remain	6662 Drolet St.
WC2	*	Thuja occidentalis	White Cedar	100-200mm DBH	GOOD	To remain	3869 Innes Rd.
WS	1	Picea glauca	White Spruce	300mm DBH	GOOD	To remain	3869 Innes Rd.

**PROPOSED PLANT LIST**

KEY	QTY	BOTANICAL NAME	COMMON NAME	SIZE	CONDITION	REMARKS
HB	3	Celtis occidentalis	Hackberry	60mm cal.	B&B	
HL	2	Gleditsia triacanthos 'Skyline'	Skyline Honey Locust	60mm cal.	B&B	
JL	6	Syringa reticulata	Japanese Tree Lilac	60mm cal.	B&B	
SB	1	Amelanchier canadensis	Servicberry	60mm cal.	B&B	
SS	3	Picea omorika	Serbian Spruce	1.8m Ht.	B&B	
WS	3	Picea glauca	White Spruce	1.8m Ht.	B&B	

- GENERAL NOTES:**
- It is the responsibility of the appropriate contractor or official to report any errors, omissions or discrepancies on this plan with actual site conditions to the Landscape Architect before proceeding with construction.
  - The contractor is to notify all utility companies and authorities prior to any excavation and ascertain locations of underground services.
  - The contractor is to reinstaite all areas and items damaged as a result of construction activity.
  - The contractor is to comply with all pertinent codes and by-laws.
  - The contractor is to maintain a positive surface run-off throughout the entire construction period.
  - The Landscape Architect is not responsible for subsurface conditions.
  - The contractor is to identify all existing trees to remain on site with the Landscape Architect prior to construction.
  - The contractor is to stake the proposed location of all plant material in conjunction with the Landscape Architect prior to excavation.
  - Minimum distances for selected deciduous trees are as follows:
    - Building Foundations 7.5m
    - Sidewalks 1.5m
    - Public Streets 2.5m
    - Underground Infrastructure 2.0m
  - All trees within 1m of underground utility trenches are to be excavated by hand.
  - Remove all protective wrapping from tree trunks after installation.
  - Staking of trees shall only be performed if necessary.
  - Ensure that mulch is pulled back a min. distance of 75mm from base of tree trunk.

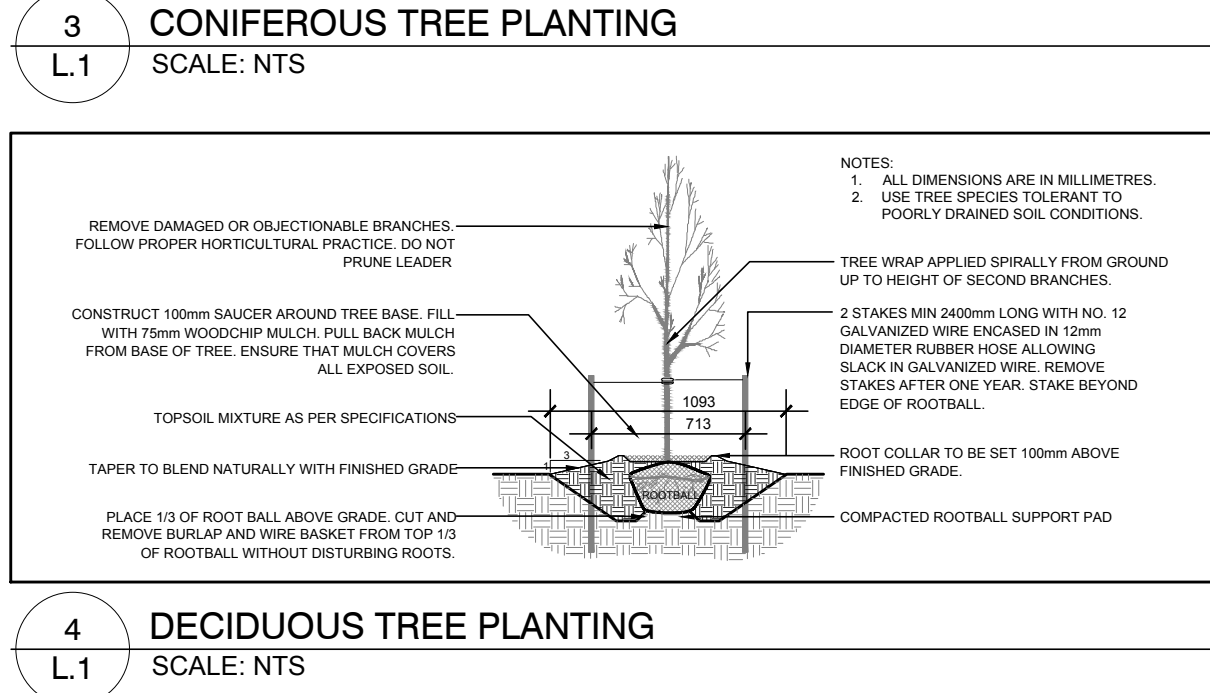
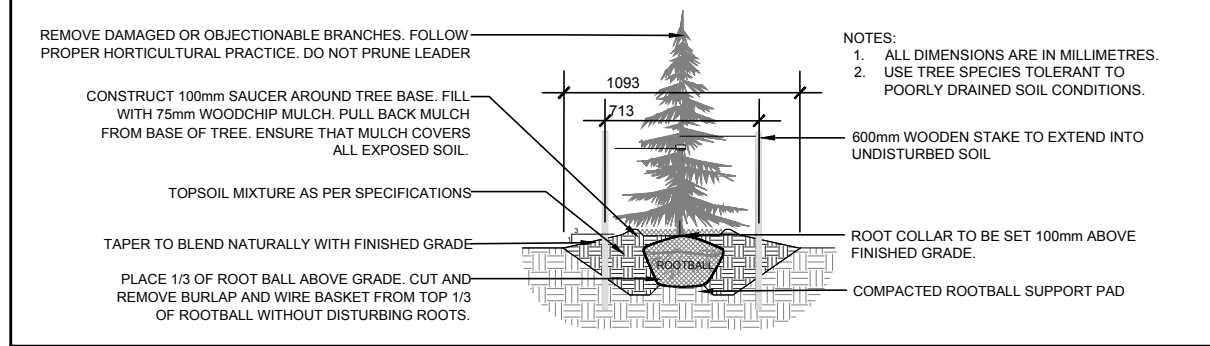
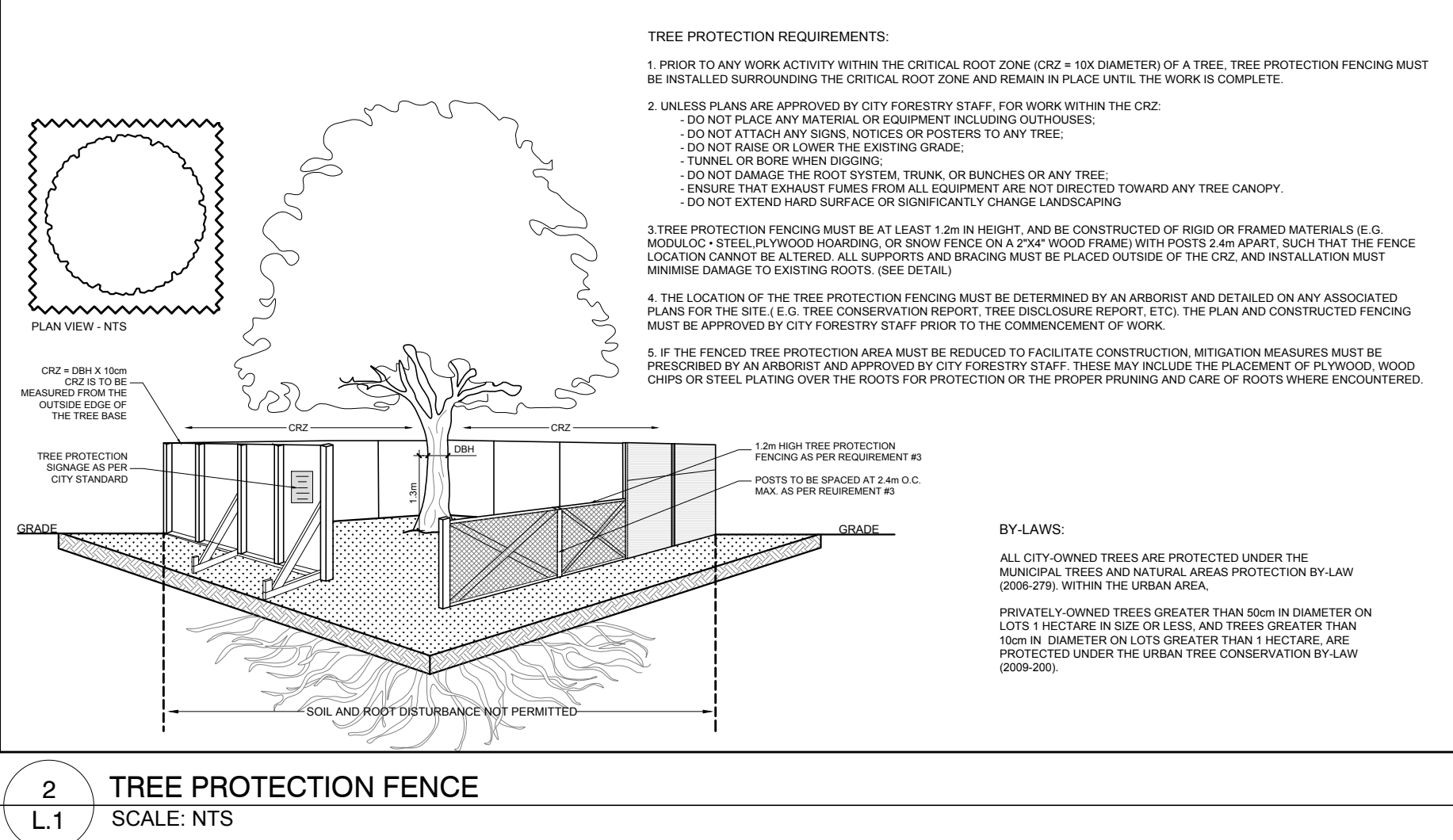

D07-12-20-0164