

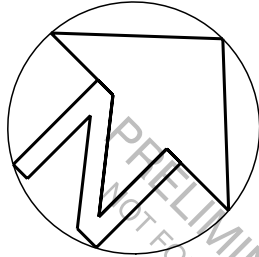

FALLOWFIELD RD

NOTES:

1. RETAINED LAND IS VACANT.
2. HOUSE ON SEVERED LAND LIES IN EXCESS OF 23M DISTANT FROM ALL PROPOSED LOT LINES.
3. ACCESSORY BUILDINGS ON SEVERED LAND LIE IN EXCESS OF 5M DISTANT FROM ALL PROPOSED PROPERTY LINES.
4. SEPTIC ON SEVERED LAND LIES IN EXCESS OF 5M DISTANT FROM ALL PROPOSED PROPERTY LINES.
5. WELL ON SEVERED LAND LIES IN EXCESS OF 30M DISTANT FROM ALL PROPOSED PROPERTY LINES.
6. POOL ON SEVERED LAND LIES IN EXCESS OF 2M DISTANT FROM ALL PROPOSED PROPERTY LINES.



Committee of Adjustment
Received | Reçu le
2024-09-03
City of Ottawa | Ville d'Ottawa
Comité de dérogation

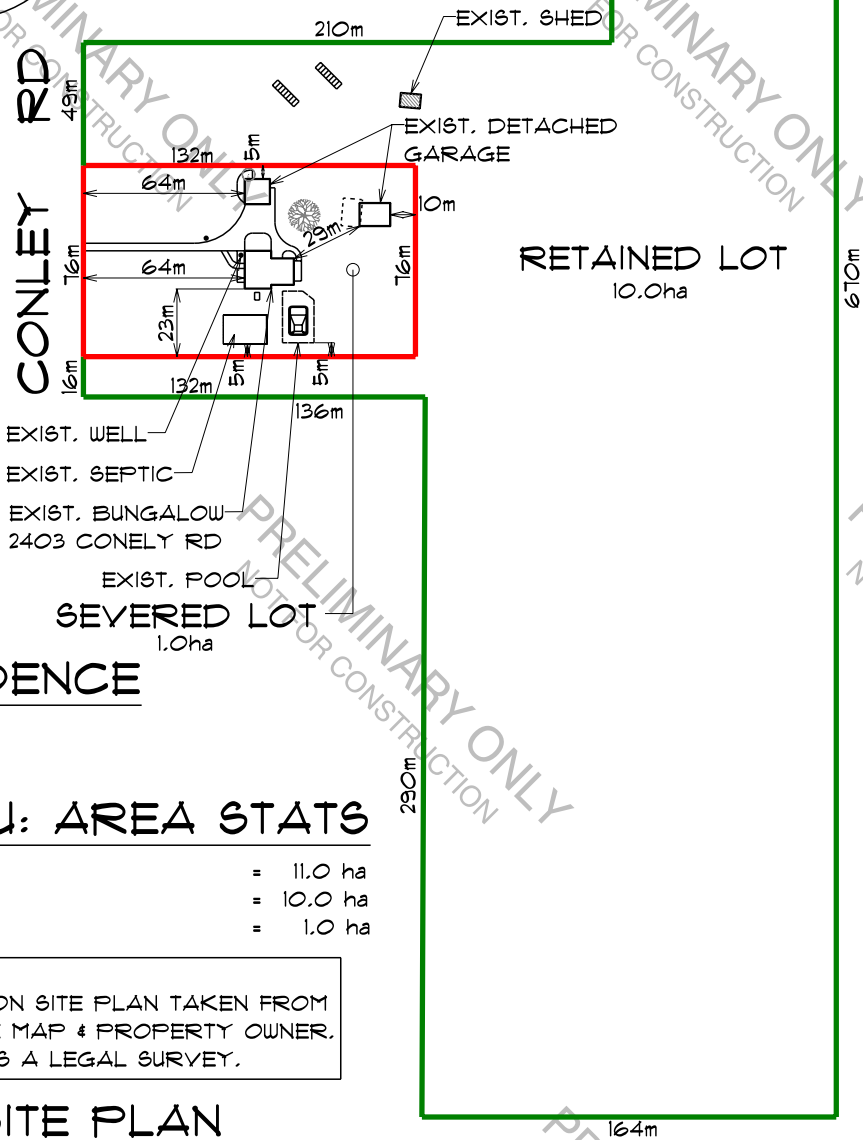

DO RESIDENCE

2403 CONLEY RD.
STITTSVILLE, ON.
K2S 1B8

ZONE - RU: AREA STATS

EXIST. LOT AREA	= 11.0 ha
RETAINED LOT	= 10.0 ha
SEVERED LOT	= 1.0 ha

NOTE:
ALL INFORMATION ON SITE PLAN TAKEN FROM
geoOTTAWA ONLINE MAP & PROPERTY OWNER.
NOT TO BE USED AS A LEGAL SURVEY.

SKETCH SITE PLAN

SCALE: 1:3000

RESIDENCE FOR:
DO RESIDENCE
2403 CONLEY RD
STITTSVILLE, ON
K2S 1B8

DRAWING TITLE:
PROPOSED SEVERANCE SITE SKETCH

DATE:
JULY, 2024

DRAWN BY:
T.S.

PROJECT No.:
24-DO SEVERANCE

APPROVED:
A.M.W.

SCALE:
AS SHOWN

All drawings, specifications and related documents are the copyright property of Seaway Design Group and must be returned upon request. Reproduction of drawings, specifications, and related documents in whole or in part is forbidden without the written permission of Seaway Design Group.

SEAWAY DESIGN Group
UNIT 10 - 4503 SOUTH AVENUE,
BROCKVILLE ON tel: 613-704-8797
www.seawaydg.ca

