

SKETCH FOR COMMITTEE OF ADJUSTMENT APPLICATION:  
**#3060 SHEA ROAD**  
 GEOGRAPHIC TOWNSHIP OF GOULBOURN  
 CITY OF OTTAWA  
 SCALE 1:2500 (Metric)

**CAUTION:**  
 THIS IS NOT A PLAN OF SURVEY  
 THIS SKETCH MAY NOT BE USED FOR ANY  
 PURPOSE OTHER THAN THAT OF COMMITTEE  
 OF ADJUSTMENT APPLICATION.

THIS IS NOT AN ORIGINAL COPY UNLESS  
 EMBOSSED WITH SURVEYORS SEAL

© ANNIS O'SULLIVAN VOLLEBEKK Ltd, 2025.  
 "THIS SKETCH IS PROTECTED BY COPYRIGHT"

NOTES

ALL DISTANCES AND AREAS SHOWN ARE APPROXIMATE AND ARE  
 TAKEN FROM geoOTTAWA MAPPING MEASUREMENTS.  
 HOUSE ON SEVERED LANDS LIES IN EXCESS OF 13 METERS DISTANT  
 FROM ALL PROPOSED PROPERTY LINES.  
 SEPTIC AND STORAGE SHEDS ON SEVERED LANDS LIE IN EXCESS OF  
 8 METRES DISTANT FROM ALL PROPOSED PROPERTY LINES.  
 STORAGE BARN ON SEVERED LANDS LIES IN EXCESS OF 17 METERS DISTANT  
 DISTANT FROM ALL PROPOSED PROPERTY LINES.  
 WELL ON SEVERED LANDS LIES IN EXCESS OF 25 METERS DISTANT  
 FROM ALL PROPOSED PROPERTY LINES.

RETAINED LANDS ARE VACANT.

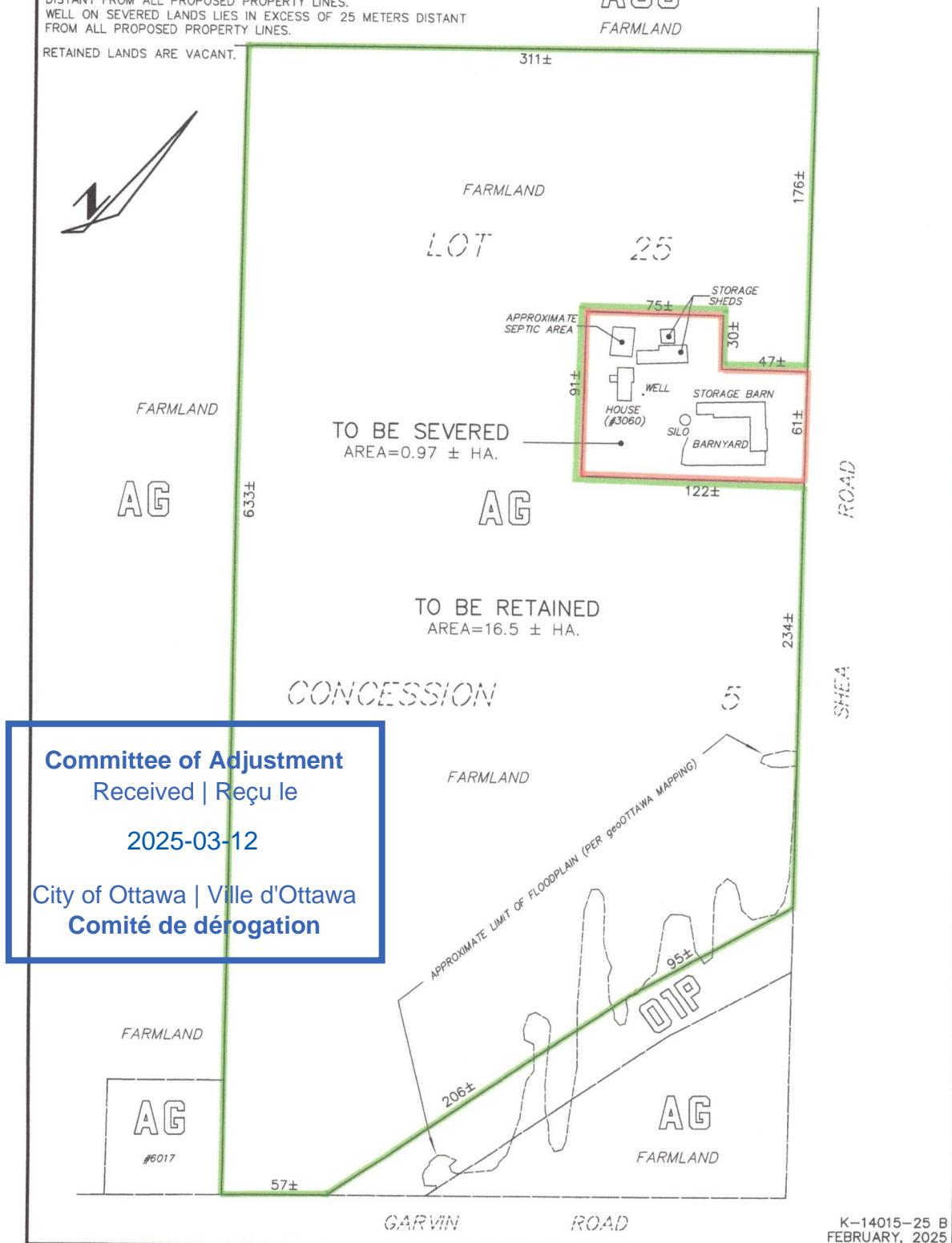

**Committee of Adjustment**  
 Received | Reçu le  
 2025-03-12  
 City of Ottawa | Ville d'Ottawa  
 Comité de dérogation