

This document is presented in the language it was provided.
Ce document est présenté dans la langue dans laquelle il a été fourni.



trilliumtree@bellnet.ca
613-831-4475
trilliumtree.ca

Trillium Tree Experts Ltd.
P.O. Box 13632
Kanata, ON K2K 1X6

January 20, 2025

Tree Information Report – 1094 Normandy Cres

Report prepared by,
Chris McIntyre
Trillium Tree Experts
613-831-4475
trilliumtree@bellnet.ca

Property owner,
Lorenzo Cavaliere
1094 Normandy Cres
Ottawa, ON, K2C 0L8
lorenzo@clcproperties.ca

Committee of Adjustment
Received | Reçu le

2025-02-25

City of Ottawa | Ville d'Ottawa
Comité de dérogation

This Tree Information Report is being submitted as a partial requirement for the development of this property. A site visit was conducted by Chris McIntyre, Certified Arborist ON-1219A, on January 14, 2025.

The focus of this report is to outline the current vegetation on the site, detailing species, size, and condition. While evaluating the impact the purposed development may have on the vegetation, and how to mitigate damage to retained trees.

The report is based on the current plans provided by Lorenzo Cavaliere. Moving forward if any changes are made to the purposed build, the property owner is responsible for prompting a review of this TIR.

Chris McIntyre

January 20, 2025

Date

Lorenzo Cavaliere

Date

Tree No.	Species	D.B.H (cm)	Ownership	Condition of tree	Client's reason for removal	Arborist recommendation
1	Colorado Spruce	59	Private - shared	Tree health and structure are fair.	Proximity to overhead hydro primary, within 8ft. CRZ cannot be adequately protected.	19ft CRZ cannot be properly protected, root system is shallow, even with keeping excavation to minimums damage caused will effect integrity of root system. Recommendation is removal.
2	Norway maple	40	City	Tree health and structure are poor, extensive hydro pruning, tree is growing directly under primary.	Condition, not a suitable tree long term.	13ft CRZ cannot be properly protected. Hydro pruning has negatively effected natural growth. City proposal for sidewalk install summer 2025 will also negatively effect condition. Recommendation is removal.
3	Sugar maple	50	Neighbour	Tree health and vigor are fair.	Tree to be retained.	CRZ protection fencing to be installed at 10ft, all below protection to be implemented.
4	Juniper	28	Private	Tree health and vigor are fair.	Within footprint of purposed.	Remove.
5	Mt. ash	26	Private - shared	Tree health and vigor are poor.	Tree to be retained.	CRZ protection fencing to be installed at 3ft, all below protection to be implemented.
6	Manitoba maple	52	Private - shared	Tree health and vigor are fair. Splitting with unions, decay present in lower trunk.	Tree to be retained.	CRZ protection fencing to be installed at 8ft, all below protection to be implemented.
7	Manitoba maple	22	Private - shared	Tree health and vigor are fair.	Tree to be retained.	CRZ protection fencing to be installed at 5ft, all below protection to be implemented.
8	Manitoba maple	30	Private - shared	Tree health and vigor are fair. Weak structure, significant amount of canopy damage.	Tree to be retained.	CRZ protection fencing to be installed at 7ft, all below protection to be implemented.

TREE REPLACEMENT - At landscaping phase 2 new 50-60mm trees have been purposed at the front of each house. Due to overhead smaller variety trees are recommended - crabapple, ivory silk lilac, serviceberry.

The following are measures to be implemented prior and during the construction process.

- Critical root zone of retained trees must be protected as outlined above. Snow or metal fencing must be erected around the CRZ and signage should be installed to identify tree is being protected.
- Pruning must be performed prior to construction to ensure tree limbs will not be in conflict with equipment and construction. Permission must be obtained to prune Municipal or neighbors trees. (performed by Certified Arborist).
- No material or equipment is permitted within any CRZ.
- No signs, notices or posters may be attached to the tree.
- No grade changes within any CRZ.
- Ensure exhaust fumes from equipment are not directed towards tree canopy's.

--	--	--	--	--	--	--

Site Visit - January 2025
Report Completed - January 2025

Report prepared by: Chris McIntyre Trillium Tree Experts P.O Box 13632 Kanata, ON K2K 1X6 613-831-4475 trilliumtree@bellnet.ca	Property Owner Contact Information: Lorenzo Cavaliere 1094 Normandy Cres Ottawa, ON K2C 0L8 613-371-4770 lorenzo@clcproperties.ca
--	--



Tree 1



Tree 2



Tree 3



Tree 4



Tree 5



Tree 6



Tree 7



Tree 8

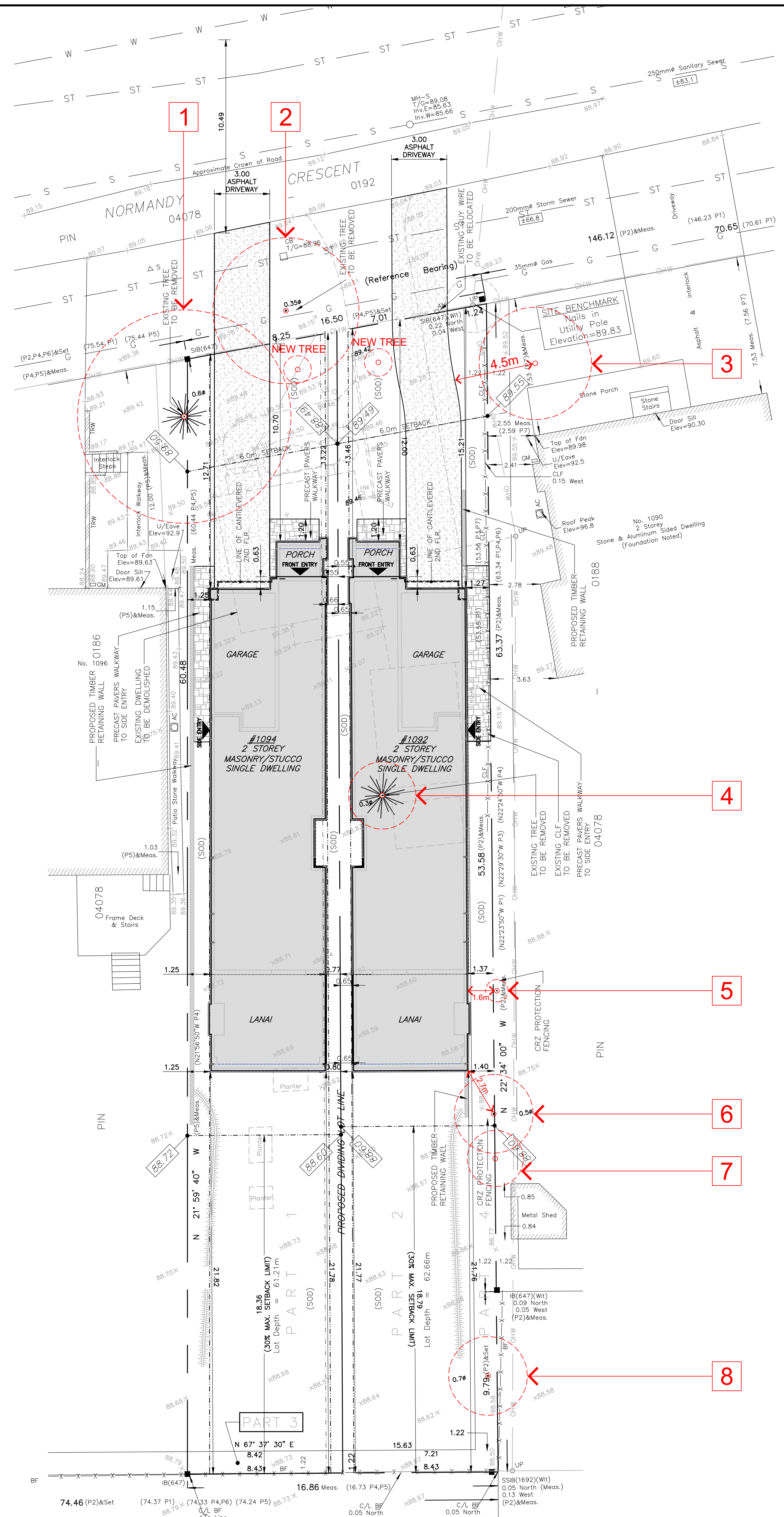
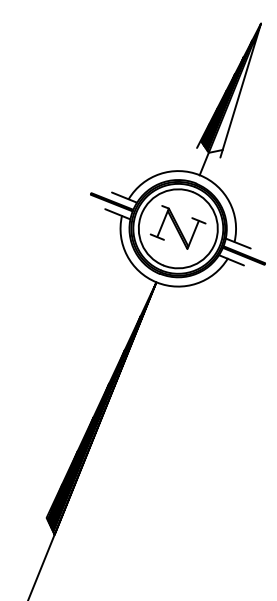

SCALE 1:150
0 2 4 6 8 10 12m

1094 NORMANDY CRESCENT
OTTAWA ONTARIO
TREE INFORMATION REPORT



REVISED FEBRUARY 19, 2025