

Replacement Tree Specifications

Trees 1-4, large trees at maturity, species suggestions include:

- Hackberry (*Celtis occidentalis*)*
- Katsura (*Cercidiphyllum japonicum*)
- Black walnut (*Juglans nigra*)* – nuts
- Black cherry (*Prunus serotina*)*
- White oak (*Quercus alba*)*
- Bur oak (*Quercus macrocarpa*)*
- Pin Oak (*Quercus palustris*)
- English oak (*Quercus robur*)
- Red oak (*Quercus rubra*)*
- Basswood (*Tilia americana*)*
- Ginkgo (*Ginkgo biloba*)
- Kentucky coffeetree (*Gymnocladus dioica*) – has pods
- Liberty elm (*Ulmus americana* “*Libertas*”)
- Honey locust (*Gleditsia triacanthos*)
- Red maple (*Acer rubrum*)*

Additional conifer species suggestions for trees 3 and 4:

- Eastern larch (*Larix laricina*)*
- White spruce (*Picea glauca*)*
- Norway spruce (*Picea abies*)
- Colorado spruce (*Picea pungens*)
- Eastern white cedar (*Thuja occidentalis*)*
- Canadian hemlock (*Tsuga canadensis*)*

Note: Proposed tree locations are suggestions only and should be finalized only once construction is complete and should adhere to City of Ottawa Tree Planting Guidelines

*Native to Ottawa region: Planting species native to a region can help maintain and enhance biodiversity.

Note: Norway maple (*Acer platanoides*) is *not* recommended as it is highly invasive and not a suitable tree for urban planting.

The species recommended herein are the most suitable species based on the existing plans. For best success, tree species should be matched to site conditions.

All deciduous trees must be a minimum of 50 mm in diameter measured no less than 15 cm above ground level. Coniferous trees must be no less than 200 cm in height.

Committee of Adjustment
Received | Reçu le

2025-03-27
City of Ottawa | Ville d'Ottawa
Comité de dérogation

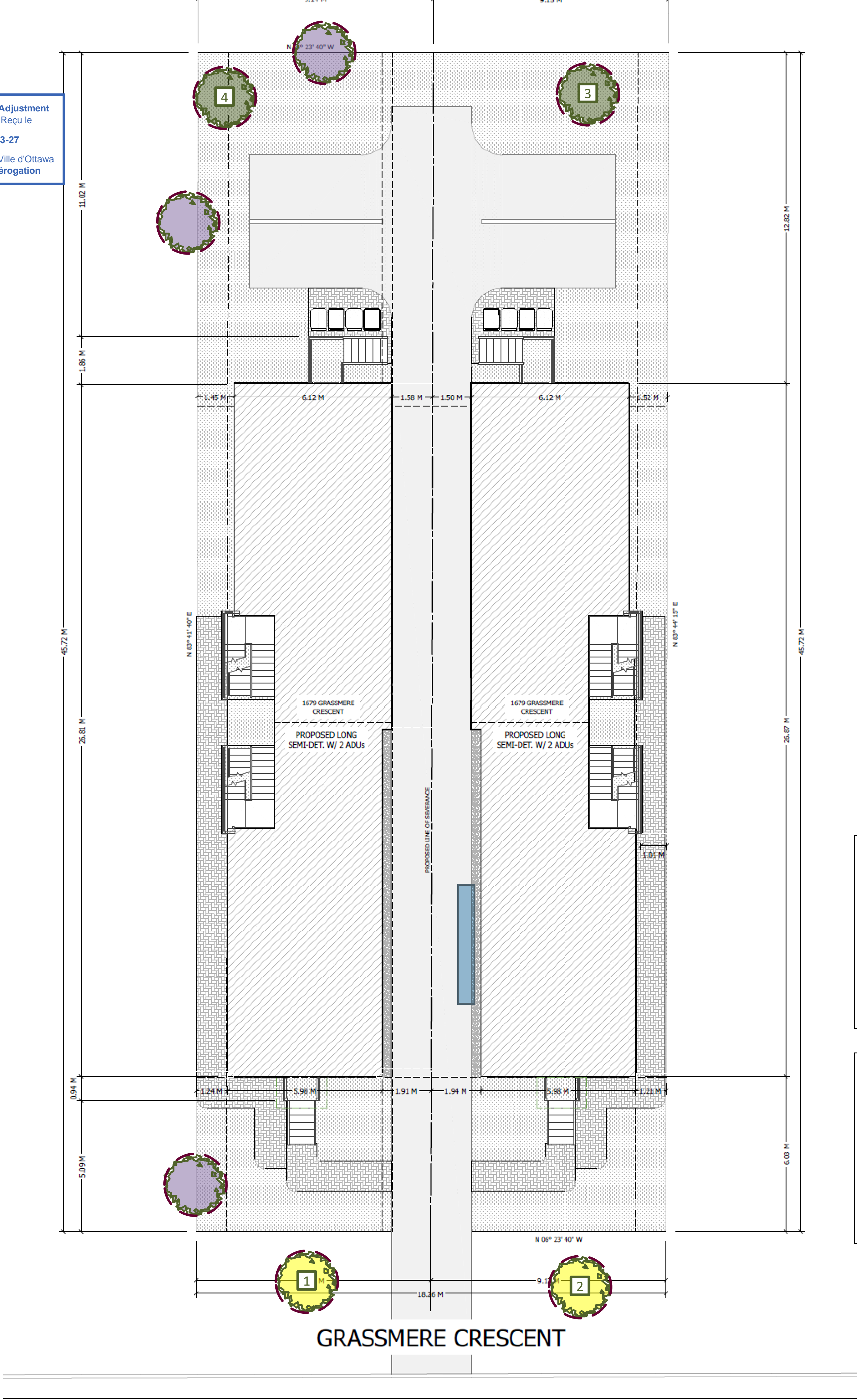

Tree Planting Plan – 1679 Grassmere
Prepared by Dendron Forestry Services
Version 1.0, March 1, 2025
For more information, please contact:
info@dendronforestry.ca

Note: the tree layer has been added to the original grading plan supplied by the client in pdf format. This layer refers to the trees only, and the original grading plan has not been altered in the process. Refer to the original plan for details as quality is lost when importing the plan into the mapping software used to create the tree layer.

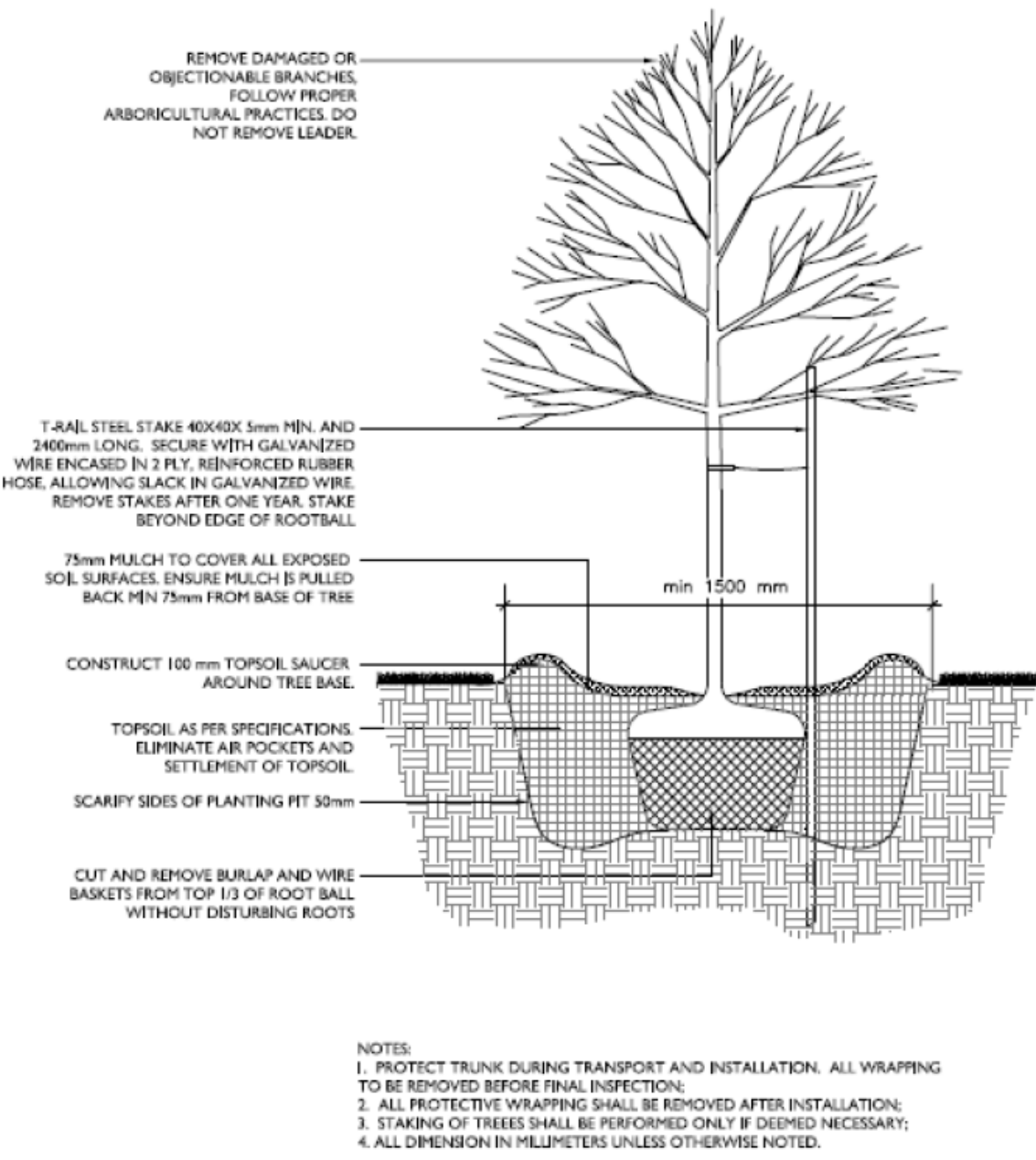



Tree Information Report (TIR) – Information on how to submit to the City of Ottawa

You have your TIR, now what?

- 1) Is the TIR part of a Committee of Adjustment (CoA) Application?

No – Go to 2

Yes – Submit your TIR and Tree Replacement Report to the city CoA planner you are working with. An infill forester at the city will be reviewing the file, and you can also send it directly to them at cofa_trees@ottawa.ca. If you would like feedback from the city on your application in advance of your hearing, it is suggested that you send it to the infill foresters for a pre-consultation.

Are any of the trees impacted by the development boundary trees, or on adjacent properties? If so, the city will request reassurance that the adjacent owners are in agreement with the plans.

- 2) The TIR is part of a Building Permit Application.

*Note: If the TIR was completed using a Site Plan, you will need to update it using the **final grading plan** as part of the Building Permit Application. Once you receive your final grading plan, send it to Dendron for an update to the TIR. If trees are being removed, you will also require a Tree Replacement Report/Planting Plan to apply for tree permits. Note that the city may also request a Tree Planting Plan to show the planting of a new tree per lot if there are no trees in the right-of-way.*

Are trees being removed?

No – Submit your application online [here](#). Be sure to click that no trees are being removed and it will just ask you to upload the report.

Yes – You will have to apply online for Tree Removal Permits to be allowed to remove your trees. Go to [this website](#) and follow the steps listed below.

Note: In addition to the TIR, you will need your Tree Replacement Report/Planting Plan in order to complete this application.

The fee is \$1,055 per protected tree for a maximum of five (5) private trees at \$5,275.

To complete the online application for Tree Removal Permits

For the “Tree retention and protection plan” document, upload the TIR.

Note: On the online application portal, they will only accept files that are 5MB or smaller, so you will need to reduce the TIR file if it is more than this.



For the “Tree replacement information” document, upload the Tree Replacement Report.

If any of the trees to be removed are boundary trees, a [Declaration of Boundary Tree Co-owner](#) form needs to be filled out by the neighbour to demonstrate agreement to tree removal. This completed form needs to be uploaded when prompted.

You will have to manually input the data for each tree to be removed:

- Species can be copied from the ‘Tree Information’ table in the TIR
- Diameter at breast height can be copied from the table in the TIR
 - For multi-stem trees, input the largest stem diameter listed in the table
- Condition of Tree can be copied from the ‘Condition’ column in the TIR table
- Location of Tree can be a generalized description of the location (ie: ‘side yard’ or ‘behind garage’)
- ‘Why you need to remove the tree’ and ‘Arborist recommendation’ can both be copied from the “Recommendations” column of the TIR table
- When they ask for a picture of the tree, just upload the TIR again – the report includes pictures of the trees that are being removed.

You will need to provide your info as well as Dendron’s address:

info@dendronforestry.ca

Dendron Forestry Services

101-45 Spencer Street, Ottawa, K1Y 2P5

Credentials:

Astrid Nielsen: Ontario Professional Forester 1882 and ISA Certified Arborist ON1976A

Kevin Myers: ISA ON-2907A

You can now pay online directly

This online application will trigger a service request with the forestry inspector who should get in contact with you. They will work with you to calculate any compensation which is:

- For private trees 30-50 cm: Two replacement trees to be planted onsite
- For private trees 50 cm +: Three replacement trees to be planted onsite
 - If there is not enough space to plant some of these trees onsite, the city will charge a \$400 fee per tree to be planted elsewhere in the city.
- For city trees, the city will apply the CTLA Trunk Formula method or a replacement ratio, whichever is greater. You are also responsible for the cost of removal.
- The cost and payment for the replacement trees is coordinated by the forestry inspector

The city will only issue the tree permit once the building permit has been issued. Once you receive your building permit, forward it to the forestry inspector so they can issue your tree permit. **You will have to post your tree permits for 7 days prior to tree removal, and for 7 days after removal.**