

**METRIC**  
DISTANCES AND ELEVATIONS SHOWN ON THIS PLAN ARE IN METRES  
AND CAN BE CONVERTED TO FEET BY DIVIDING BY 0.3048

TOPOGRAPHIC SURVEY OF  
**LOT 31**  
REGISTERED PLAN 633  
CITY OF OTTAWA

SCALE 1 : 200  
0 5 10 20 metres

**FAIRHALL, MOFFATT & WOODLAND LIMITED**  
ONTARIO LAND SURVEYORS

**ELEVATION NOTES**

- ELEVATIONS SHOWN HEREON ARE REFERRED TO GEODETIC DATUM (CVGD28).
- ELEVATIONS FOR MANHOLE COVERS AND CATCH BASINS HAVE TO BE INDEPENDENTLY CONFIRMED BEFORE THEY CAN BE ACCEPTED FOR FINAL DESIGN OR CONSTRUCTION PURPOSES.
- IT IS THE RESPONSIBILITY OF THE USER OF THIS INFORMATION TO VERIFY THAT THE JOB BENCHMARKS HAVE NOT BEEN ALTERED OR DISTURBED AND THAT THEIR RELATIVE ELEVATION AND DESCRIPTION AGREE WITH THE INFORMATION SHOWN ON THIS DRAWING.

**UTILITY NOTES**

- THIS DRAWING CANNOT BE ACCEPTED AS ACKNOWLEDGING ALL UNDERGROUND UTILITIES AND IT WILL BE THE RESPONSIBILITY OF THE USER TO CONTACT THE RESPECTIVE UTILITY AUTHORITIES FOR CONFIRMATION OR LOCATION.
- UNDERGROUND UTILITIES, AS REPORTED ON THIS DRAWING, ARE NOT BASED ON AN ACTUAL 'FIELD LOCATE' BY THE RESPECTIVE UTILITY AGENCIES BUT HAVE BEEN COMPILED FROM DATA OBTAINED FROM THE FOLLOWING SOURCE:  
a) CITY OF OTTAWA PUBLIC UTILITIES REGISTRY
- BEFORE ANY WORK INVOLVING PROBING, EXCAVATING, ETC., A FIELD LOCATION OF UNDERGROUND PLANT BY THE PERTINENT UTILITY AUTHORITY IS MANDATORY.

**NOTES**

- BEARINGS ARE ASTROMERIC AND ARE REFERRED TO THE EASTERLY LIMIT OF BRADLEY STREET AS SHOWN ON REGISTERED PLAN 633, HAVING A BEARING OF N 39° 23' 30" E.
- SURVEY PERFORMED UNDER WINTER CONDITIONS AND MAY NOT REFLECT ALL FEATURES ON SITE.

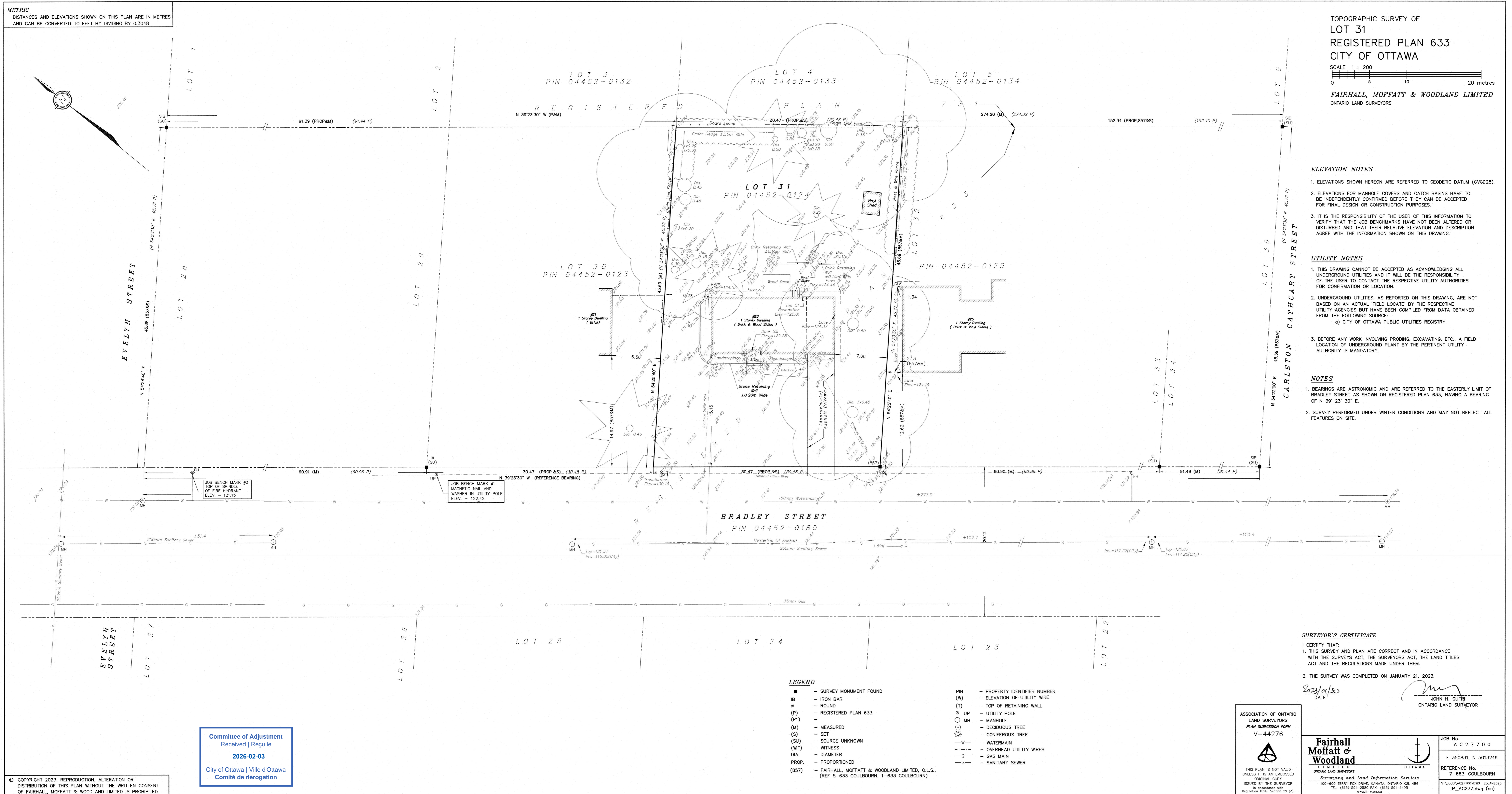

Committee of Adjustment  
Received | Reçu le  
2026-02-03  
City of Ottawa | Ville d'Ottawa  
Comité de dérogation

© COPYRIGHT 2023. REPRODUCTION, ALTERATION OR DISTRIBUTION OF THIS PLAN WITHOUT THE WRITTEN CONSENT OF FAIRHALL, MOFFATT & WOODLAND LIMITED IS PROHIBITED.

**LEGEND**

- |  |                                  |
|--|----------------------------------|
| ■ - SURVEY MONUMENT FOUND  | PIN - PROPERTY IDENTIFIER NUMBER |
| IB - IRON BAR  | (W) - ELEVATION OF UTILITY WIRE  |
| ○ - ROUND  | (T) - TOP OF RETAINING WALL      |
| (P) - REGISTERED PLAN 633  | ⊗ UP - UTILITY POLE              |
| (P1) - MEASURED  | ○ MH - MANHOLE                   |
| (M) - SET  | ○ - DECIDUOUS TREE               |
| (S) - SOURCE UNKNOWN   | ○ - CONIFEROUS TREE              |
| (SU) - WITNESS   | — W — WATERMAIN                  |
| DIA. - DIAMETER  | — O — OVERHEAD UTILITY WIRES     |
| PROP. - PROPORTIONED   | — G — GAS MAIN                   |
| (857) - FAIRHALL, MOFFATT & WOODLAND LIMITED, O.L.S., (REF 5-633 GOULBOURN, 1-633 GOULBOURN) | — S — SANITARY SEWER             |

**SURVEYOR'S CERTIFICATE**

- I CERTIFY THAT:  
1. THIS SURVEY AND PLAN ARE CORRECT AND IN ACCORDANCE WITH THE SURVEYORS ACT, THE SURVEYORS ACT, THE LAND TITLES ACT AND THE REGULATIONS MADE UNDER THEM.
- THE SURVEY WAS COMPLETED ON JANUARY 21, 2023.

2023/01/30  
DATE

JOHN H. GUTRI  
ONTARIO LAND SURVEYOR

ASSOCIATION OF ONTARIO  
LAND SURVEYORS  
PLAN SUBMISSION FORM  
V-44276

**Fairhall  
Moffatt  
Woodland**

100-600 TERRY FOX DRIVE, KANATA, ONTARIO K2L 4B6  
TEL: (613) 591-2500 FAX: (613) 591-1495  
www.fmw.com

JOB No.  
A C 2 7 7 0 0  
E 350831, N 5013249  
REFERENCE No.  
7-663-GOULBOURN  
S:\005\AC27700\DWG 23JAN2023  
TP\_AC277.dwg (ss)

**METRIC**  
DISTANCES AND COORDINATES SHOWN ON THIS PLAN ARE IN METRES AND CAN BE CONVERTED TO FEET BY DIVIDING BY 0.3048

COORDINATES WERE DERIVED FROM REAL TIME NETWORK OBSERVATIONS (SMARTNET) MTM ZONE 9, NAD83 CSRS (2010).  
COORDINATES HAVE BEEN DETERMINED TO AN URBAN ACCURACY IN ACCORDANCE WITH SECTION 14(2) OF O.REG 216/10.

POINT ID	NORTHING	EASTING
306	5013271.14	350781.99
424	5013107.22	350918.45
432	5013224.30	350820.94

COORDINATES CANNOT IN THEMSELVES BE USED TO RE-ESTABLISH CORNERS OR BOUNDARIES SHOWN ON THIS PLAN.

PLAN PREPARED FOR COMMITTEE OF ADJUSTMENT PURPOSES  
DECEMBER 18, 2025

SCHEDULE				
PART	LOT	REGISTERED PLAN	ALL OF PIN	AREA(sq. m)
1	31	633	04452-0124	694
2				694

Committee of Adjustment  
Received | Reçu le  
**2026-02-03**  
City of Ottawa | Ville d'Ottawa  
Comité de dérogation

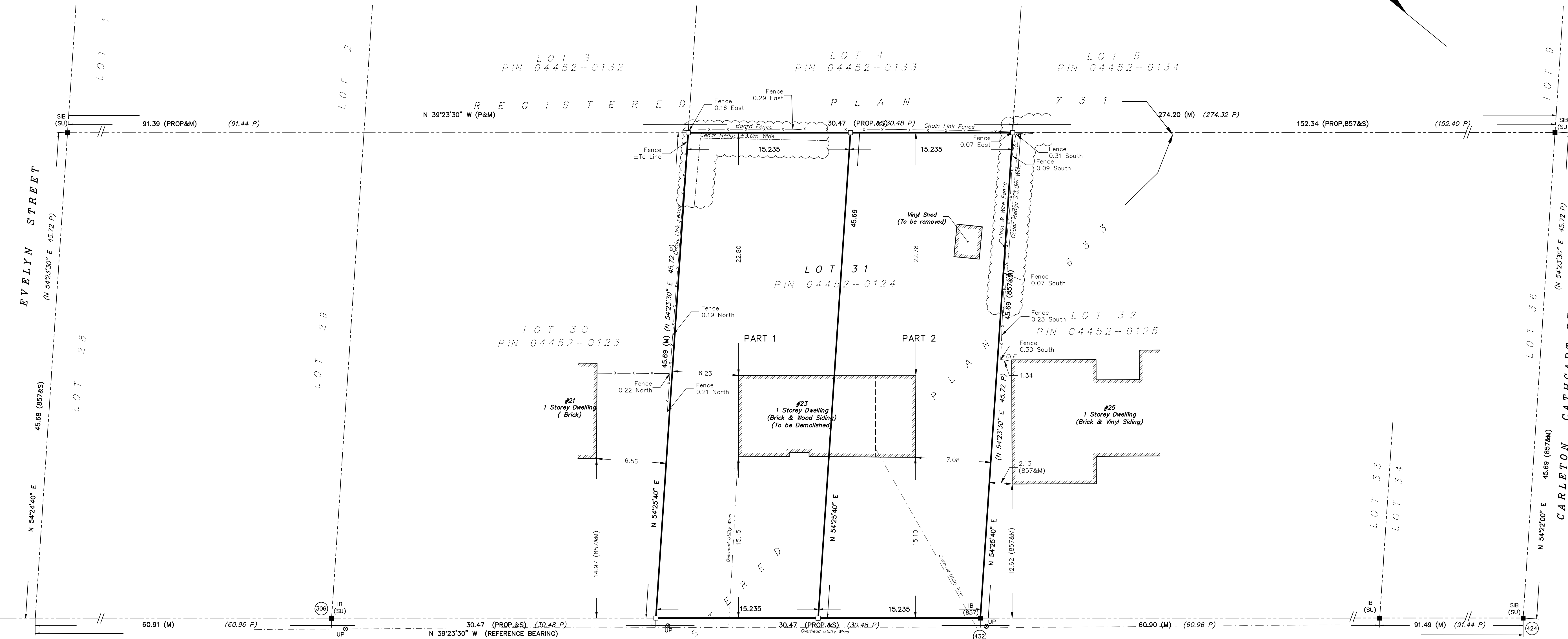

PLAN OF SURVEY OF  
LOT 31  
REGISTERED PLAN 633  
CITY OF OTTAWA

SCALE 1 : 200  
0 5 10 20 metres  
THE INTENDED PLOT SIZE OF THIS PLAN IS 915mm IN WIDTH BY 457mm IN HEIGHT WHEN PLOTTED AT A SCALE OF 1:200.  
FAIRHALL, MOFFATT & WOODLAND LIMITED  
ONTARIO LAND SURVEYORS

- NOTES**
- BEARINGS ARE ASTRONOMIC AND ARE REFERRED TO THE EASTERLY LIMIT OF BRADLEY STREET AS SHOWN ON REGISTERED PLAN 633, HAVING A BEARING OF N 39°23'30" E.
  - BEARINGS CAN BE CONVERTED TO GRID BY APPLYING AN ANGLE ROTATION OF 0°23'50" COUNTER-CLOCKWISE, REFERENCE BEARING BECOMES N 39°47'20" W.
  - DISTANCES ARE GROUND AND CAN BE CONVERTED TO GRID BY MULTIPLYING BY THE COMBINED SCALE FACTOR 0.999912.

- LEGEND**
- - SURVEY MONUMENT SET
  - - SURVEY MONUMENT FOUND
  - SSIB - SHORT STANDARD IRON BAR
  - SIB - STANDARD IRON BAR
  - IB - IRON BAR
  - - ROUND
  - (P) - REGISTERED PLAN 633
  - (M) - MEASURED
  - (S) - SET
  - (SU) - SOURCE UNKNOWN
  - (WIT) - WITNESS
  - PROP. - PROPORTIONED
  - (857) - FAIRHALL, MOFFATT & WOODLAND LIMITED, O.L.S., (REF 7-633 GOULBOURN, 1-633 GOULBOURN)
  - PIN - PROPERTY IDENTIFIER NUMBER
  - ⊙UP - UTILITY POLE
  - - OVERHEAD UTILITY WIRES

**SURVEYOR'S CERTIFICATE**

I CERTIFY THAT:

- THIS SURVEY AND PLAN ARE CORRECT AND IN ACCORDANCE WITH THE SURVEYS ACT, THE SURVEYORS ACT, THE LAND TITLES ACT AND THE REGULATIONS MADE UNDER THEM.
- THE SURVEY WAS COMPLETED ON

DATE \_\_\_\_\_ JOHN H. GUTRI  
ONTARIO LAND SURVEYOR

THIS PLAN OF SURVEY RELATES TO AOLS PLAN SUBMISSION FORM NUMBER .....

<b>Fairhall Moffatt &amp; Woodland</b> LIMITED ONTARIO LAND SURVEYORS Surveying and Land Information Services 100-600 TERRY FOX DRIVE, KANATA, ONTARIO K2L 4B6 TEL: (613) 591-2580 FAX: (613) 591-1495 www.fmw.on.ca	JOB No. A C 2 7 7 0 0 E 350831, N 5013249 REFERENCE No. 7(a) - 663 GOULBOURN S:\J083\AC22700\DWG rp_ac277.dwg (rr)
	OTTAWA

BRADLEY STREET  
PIN 04452-0180

