

NOTES:

- OWNER CONTACT INFORMATION:**
 RICHCRAFT HOMES
 2280 ST. LAURENT BOULEVARD, SUITE 202, OTTAWA, ONTARIO, K1G 4K1
 - ARBORIST CONTACT INFORMATION:**
 NAK DESIGN STRATEGIES
 1285 WELLINGTON STREET WEST, OTTAWA, ONTARIO, K1Y 3A8
 (P): 613.237.2345
 - CONTRACTOR INFORMATION:**
 N/A
 - SELF-DECLARATION STATEMENT:** ALL PARTIES AGREE WITH THE INFORMATION AND WILL RESPECT THE PROPOSED WORK AND MITIGATION MEASURES. IT IS ACKNOWLEDGED AND UNDERSTOOD THAT AN INSPECTOR MAY ENTER THE PROPERTY AT A REASONABLE TIME FOR THE PURPOSE OF CARRYING OUT AN INSPECTION. FAILURE TO ABIDE BY THE RECOMMENDATIONS OF THE APPROVED TREE INFORMATION REPORT, DAMAGING OR DESTROYING TREES IDENTIFIED FOR PROTECTION THE OWNER WILL BE RESPONSIBLE TO BEAR FULLY THE COST OF COMPENSATION, REMOVAL, AND REPLACEMENT
- 4.1. PROPERTY OWNER: RICHCRAFT HOMES
 4.2. ARBORIST: NAK DESIGN STRATEGIES
 4.3. CONTRACTOR: N/A
5. **SITE PHOTOGRAPHS:**

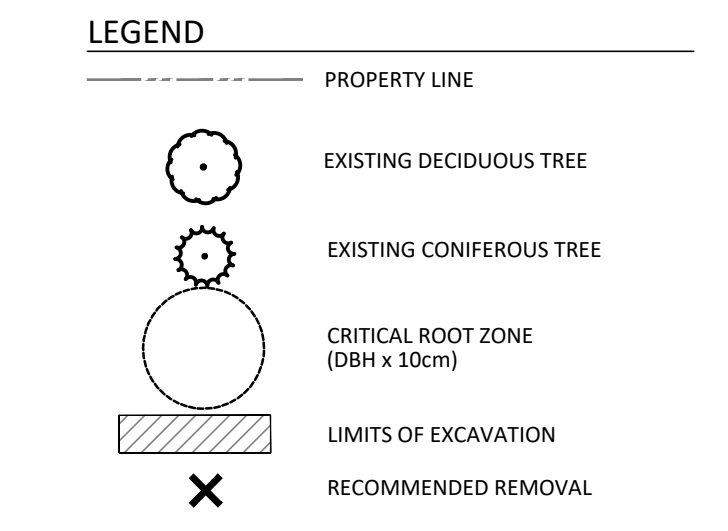

Contractor shall check all dimensions on the work and report any discrepancy to the Landscape Architect before proceeding. All drawings and specifications are the property of the Landscape Architect and must be returned at the completion of the work. This drawing is not to be used for construction until signed by the Landscape Architect.

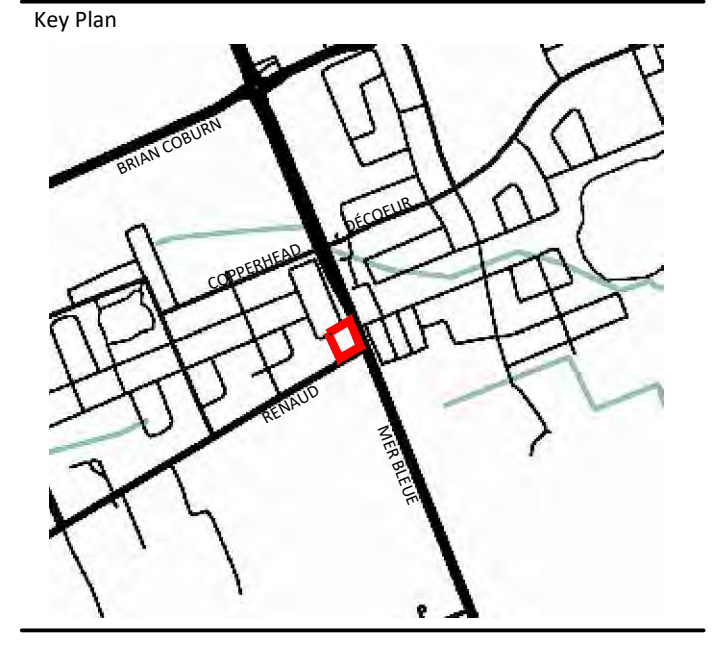

No.	Description	Date
2	Re-issued for Consent / Severance	Jan.16/26
1	Issued for Consent / Severance	Jan.14/26

Revision
 City Approval Stamp

Tree #	Botanical Name	Common Name	DBH (cm)	Ownership	Condition	Notes	Client's Reason for Removal	Arborist Recommendation
1	<i>Picea pungens</i> var. <i>Glauca</i>	Blue Colorado Spruce	40	Private 6615 Renaud Rd.	GOOD	Symmetrical Canopy, Single Stem	Construction Purposes - Proposed Single-Detached	Removal
2	<i>Thuja occidentalis</i>	Eastern White Cedar	40	Private 6615 Renaud Rd.	GOOD	Asymmetrical Canopy, Pruned Limbs, Co-dominant Leaders: 3@=1m Above Grade	Construction Purposes - Proposed Single-Detached Lot	Removal
3	<i>Thuja occidentalis</i>	Eastern White Cedar	40	Private 6615 Renaud Rd.	GOOD	Asymmetrical Canopy, Pruned Limbs, Single Stem, Co-dominant Leaders: 7@=1m Above Grade	Construction Purposes - Proposed Single-Detached Lot	Removal
4	<i>Thuja occidentalis</i>	Eastern White Cedar	40	Private 6615 Renaud Rd.	GOOD	Asymmetrical Canopy, Single Stem, Multi-stem: 2	Construction Purposes - Proposed Single-Detached Lot	Removal
5	<i>Pinus strobus</i>	Eastern White Pine	60	Private 6615 Renaud Rd.	GOOD	Symmetrical Canopy, Broken Limbs, Pruned Limbs, Single Stem	Construction Purposes - Proposed Townhouse Lot	Removal
6	<i>Picea glauca</i>	White Spruce	60	Private 6615 Renaud Rd.	GOOD	Symmetrical Canopy, Single Stem	Construction Purposes - Proposed Townhouse Lot	Removal
7	<i>Acer rubrum</i>	Red Maple	40	Private 6615 Renaud Rd.	GOOD	Symmetrical Canopy, Single Stem, Co-dominant Leaders: 4@=1m Above Grade, Included Bark	Construction Purposes - Proposed Single-Detached Lot	Removal
8	<i>Acer rubrum</i>	Red Maple	30	Private 6615 Renaud Rd.	MODERATE	Asymmetrical Canopy, Single Stem, Co-dominant leaders: 3@=1m Above Grade, Included Bark, Bark rot on trunk	Construction Purposes - Proposed Single-Detached Lot	Removal
9	<i>Picea glauca</i>	White Spruce	35	Private 6615 Renaud Rd.	GOOD	Asymmetrical Canopy, Die-back =20% @ branches, Broken Limbs, Single Stem, Bark rot @ Limbs	Construction Purposes - Proposed Single-Detached Lot	Removal

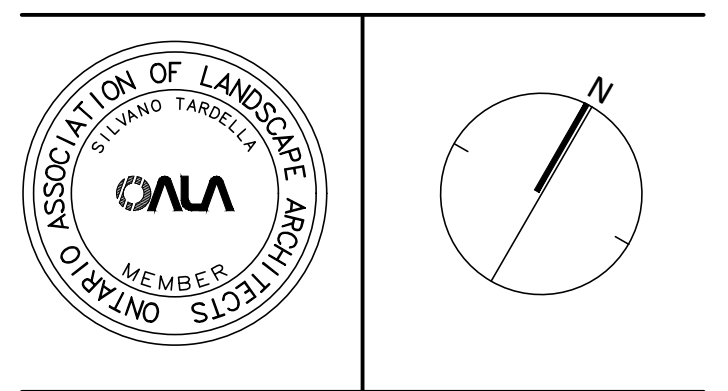

ARBORIST: PAT GAUVREAU
 ISA CERTIFICATION NUMBER: ON-3138A

NAK
 design strategies

1285 WELLINGTON STREET, OTTAWA, ON K1Y 3A8 CANADA
 T 613.237.2345 NAKDESIGNSTRATEGIES.COM

RENAUD & RAPPEL
 6615 RENAUD ROAD

Title
TREE INFORMATION REPORT

Date	January, 2026	Sheet	
Scale	1:250		
Drawn	PG		
Checked	JH		
Job No.	18-135		

TIR 1.0

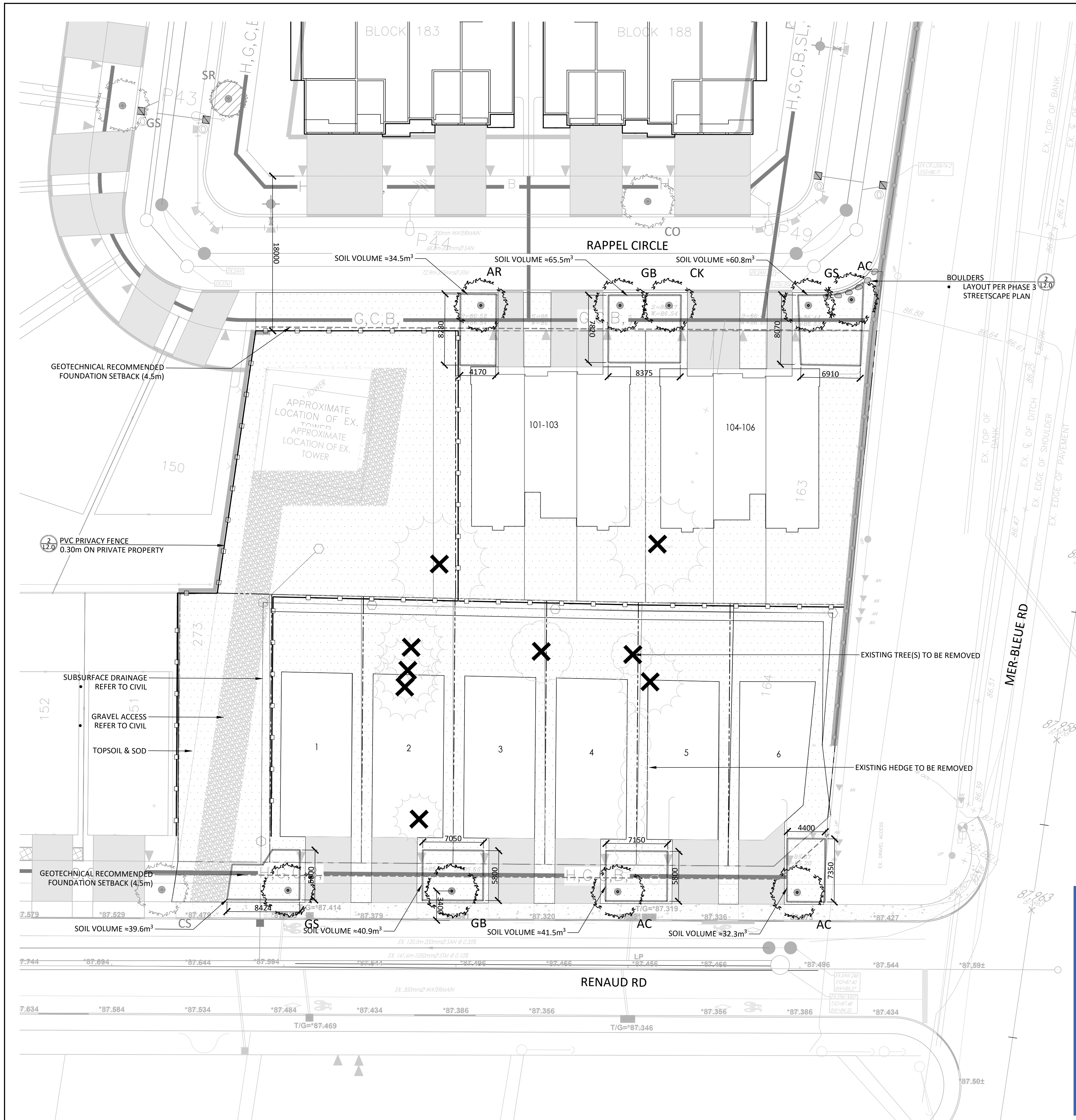

STREET TREE REQUIREMENT BASED ON DRAFT CONDITIONS FOR FINAL APPROVAL:

- 1 TREE PER INTERIOR SINGLE (NON-CORNER) LOTS
- 2 TREES PER EXTERIOR SINGLE (CORNER) LOTS
- 1 TREE PER EXTERIOR TOWNHOUSE (CORNER) LOT
- 2 TREES PER 3 MULTIPLE-UNITS TOWNHOUSE

- INTERIOR SINGLE (NON-CORNER) LOTS (5): 5 TREES
- EXTERIOR SINGLE (CORNER) LOTS (1): 2 TREES
- EXTERIOR TOWNHOUSE (CORNER) LOT (1): 1 TREE
- 3 MULTIPLE-UNITS TOWNHOUSE (2): 4 TREES

TOTAL NUMBER OF TREES REQUIRED: 12
 NUMBER OF STREET TREES SHOWN ON PLAN: 9
 DIFFERENCE: -3

TRAILSEDGE EAST PH.1: +22 TREES
 TRAILSEDGE EAST PH.2&3: -40 TREES
 TRAILSEDGE EAST PARK: +94 TREES (DECIDUOUS, 50mm CAL.)

- STREET TREE PLANTING GUIDELINE**
 NOTE: APPROVED CROSS SECTIONS SHALL TAKE PRECEDENCE
- 4.5m - STREET LIGHT (SMALL TREE <7m MATURE HT.)
 - 2.5m - STREET LIGHT (MEDIUM/LARGE TREE >7m MATURE HT.)
 - 3.0m - HYDRO TRANSFORMER
 - 1.5m - PATH, DRIVEWAY, FENCE, SOUND WALL
 - 4.5m - CONIFERS MINIMUM SETBACK FROM CURB
 - 2.5m - FIRE HYDRANTS
 - 1.5m - WATER SERVICE / CURB STOP
 - 1.0m - BELL / CABLE PEDESTALS

TREE PLANTING IN MARINE CLAY SOILS

THE LANDSCAPE CONSIDERATIONS CONTAINED WITHIN SEC. 6.8 OF PATERSON GROUP'S GEOTECHNICAL INVESTIGATION, DATED AUGUST 12, 2022.

- THIS LANDSCAPE PLAN CONFORMS WITH THE TREE-TO-FOUNDATION SETBACK, SOIL VOLUME, AND SURFACE-GRADING REQUIREMENTS OUTLINED IN THE CITY OF OTTAWA'S GUIDELINES FOR TREE PLANTING IN SENSITIVE MARINE CLAY SOILS (2017), BASED ON THE FINDINGS OUTLINED IN THE PROJECT GEOTECHNICAL REPORT BY PATERSON GROUP (REPORT PG0861-3 REVISION 5, DATED AUGUST 12, 2022).
- ADDITIONAL REQUIREMENTS OUTLINED IN THE CITY OF OTTAWA'S GUIDELINES FOR TREE PLANTING IN SENSITIVE MARINE CLAY SOILS (2017), INCLUDING USF DEPTH, FOUNDATION WALL REINFORCEMENT, AND SUBDIVISION GRADING, SHOULD BE CONFIRMED BY THE PROJECT ENGINEER(S).
- THE CONTRACTOR SHOULD REPORT ANY DISCREPANCIES TO THE CONTRACT ADMINISTRATOR BEFORE PLANTING TREES.

TREE TYPE/SIZE	SINGLE TREE SOIL VOLUME	MULTIPLE TREE SOIL VOLUME (m ³ /TREE)	SOIL VOLUME FOR MARINE CLAY AREAS (SINGLE TREE)
ORNAMENTAL	15	9	
COLUMNAR	15	9	
SMALL	20	12	25
MEDIUM	25	15	30
LARGE	30	18	
CONIFER	25	15	

DECIDUOUS TREES - MEDIUM (8-14M HEIGHT)

KEY	QTY	BOTANICAL NAME	COMMON NAME	MATURE Ht. (M)	SIZE	REMARKS
AR	1	ACER RUBRUM 'BRANDYWINE'	BRANDYWINE MAPLE	12	50mm	B&B
GB	2	GINKGO BILOBA 'AUTUMN GOLD'	AUTUMN GOLD GINKGO	14	50mm	B&B
GS	2	GLEDITSIA TRIACANTHOS VAR. INERMIS 'IMPERIAL'	IMPERIAL HONEYLOCUST	12	50mm	B&B
CK	1	CLADASTRIS KENTUCKEA	YELLOWWOOD	12	50mm	B&B

DECIDUOUS TREES - SMALL (6-8M HEIGHT)

AC	3	AMELANCHIER CANADENSIS	SERVICEBERRY	6	50mm	B&B
----	---	------------------------	--------------	---	------	-----

Committee of Adjustment
 Received | Reçu le
2026-02-09
 City of Ottawa | Ville d'Ottawa
 Comité de dérogation

Contractor shall check all dimensions on the work and report any discrepancy to the Landscape Architect before proceeding. All drawings and specifications are the property of the Landscape Architect and must be returned at the completion of the work. This drawing is not to be used for construction until signed by the Landscape Architect.

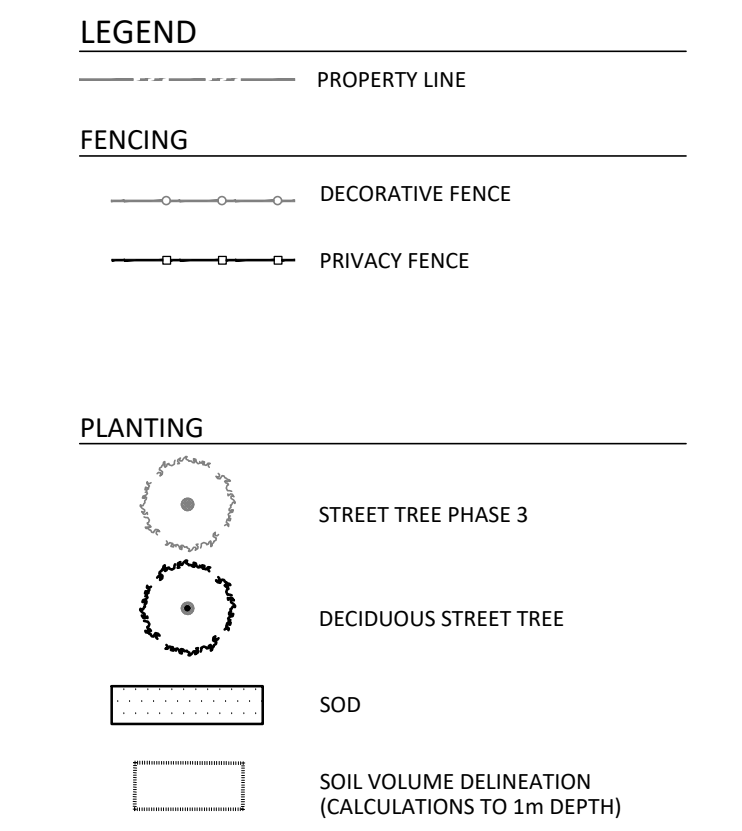
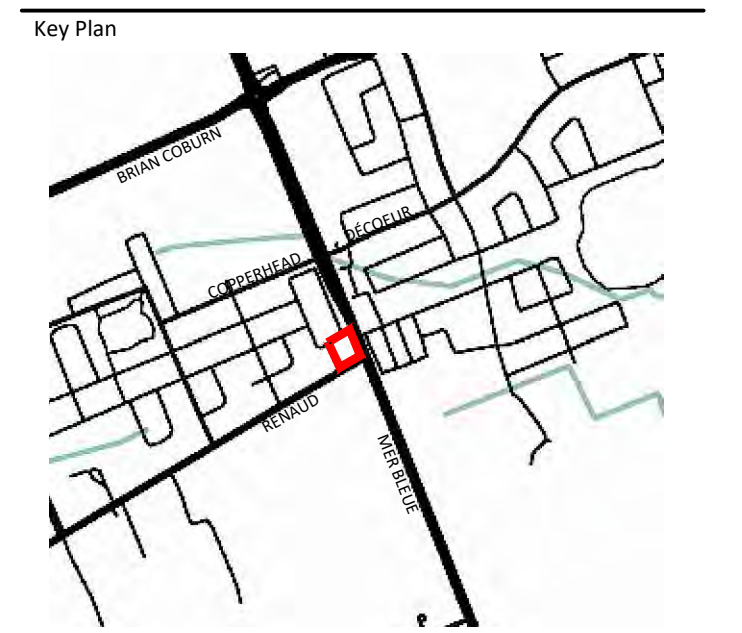

7	Re-issued for Consent / Severance	Jan.16/26
6	Issued for Consent / Severance	Jan.14/26
5	Re-issued for ZBA	Jul.7/25
4	Re-issued for ZBA	May.7/25
3	Re-issued for ZBA	Apr.30/25
2	Re-issued for ZBA	Feb.25/25
1	Issued for ZBA	Jan.16/25
No.	Description	Date

Revision
 City Approval Stamp

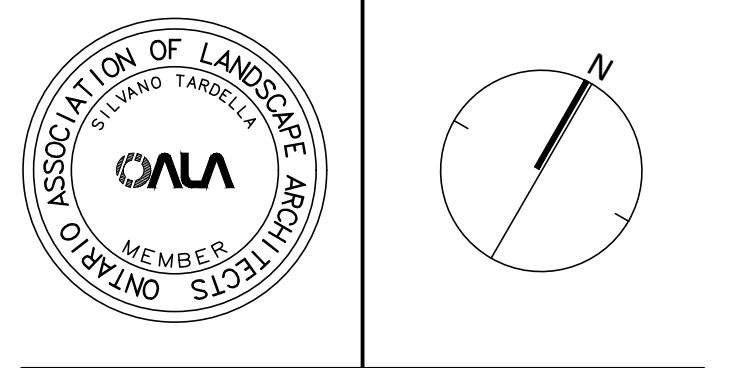

ARBORIST: PAT GAUVREAU
 ISA CERTIFICATION NUMBER: ON-3138A

NAK
 design strategies
 1285 WELLINGTON STREET, OTTAWA, ON K1Y 3A8 CANADA
 T 613.237.2345
 Project

RENAUD & RAPPEL
 6615 RENAUD ROAD

Title	
LANDSCAPE PLAN	
Date	January, 2026
Scale	1:250
Drawn	PG
Checked	JH
Job No.	18-135
Sheet	L1.0