



Dendron Forestry Services

www.dendronforestry.ca

613.805.WOOD (9663)

info@dendronforestry.ca

Tree Information Report v2.0

Submitted as part of Committee of Adjustment Application for the City of Ottawa

Address: 501 Cole

Date: March 3, 2026

Prepared by: Astrid Nielsen, RPF, ISA Certified Arborist ®
131 Smirle Ave, Ottawa, K1Y 0S4
Astrid.nielsen@dendronforestry.ca

Prepared for: Tony Cassone, ottawabuilder@hotmail.com

Site Visit: February 15, 2022, and February 26, 2026

Committee of Adjustment
Received | Reçu le

2026-03-23

City of Ottawa | Ville d'Ottawa
Comité de dérogation

This Report must be read in its entirety, including the Assumptions and Limiting Conditions attached herein.

Purpose of the Report

The purpose of this report is to provide the client with an impact assessment of all protected trees on site as per the City of Ottawa's Tree Protection By-law No. 2020-340. This report is part of a Committee of Adjustment application to the City of Ottawa and considers the impact that the proposed development will have on the trees. The assessment of the suitability of tree retention is based on the information provided at the time of report preparation which includes the Draft 4R Plan.

This assessment does not consider additional factors that could influence tree retainability such as:

- site grading, and requirement for retaining walls and/or swales
- installation of services for the new units
- capping of existing water and sewer services
- installation of gas lines for the new units
- site access

The potential for retaining those tree(s) identified for retention in this report may change as more information on the site-specific construction details is provided during the building permitting phase. For those trees that are recommended for retention, mitigation measures are provided to reduce the impact during construction. It should be noted that the construction phase includes all site works that could impact trees, from the capping of services at the beginning to the final landscaping steps at the end.



Tree Information

The following is an inventory of all trees that are protected under City of Ottawa Tree Protection (By-law No. 2020-340) on the site and adjacent City property. This includes Distinctive Trees (private trees with a diameter at breast height (dbh) of 30 cm or greater) and city-owned trees of all sizes. It also includes Distinctive Trees on adjacent properties whose Critical Root Zone (CRZ) extend into the subject area. The CRZ is an area around the trunk with a radius equivalent to 10 times the diameter of the trunk. This does not take into account infrastructure such as buildings and asphalt and assumes the tree has no restrictions on root growth.

Tree ¹	Species	Diameter at breast height (cm)	Ownership ^{2,3}	Condition	Recommendations
1	Norway maple (<i>Acer platanoides</i>)	77 cm	City	Poor; 2 cables in crown, main branch (40 cm) leaning over road has split with epicormic shoots, decay in old pruning wounds, wound and split in main trunk at 3 m, recent woodpecker activity	Contact city forestry inspector to assess for removal; not suitable for retention
2	Red oak (<i>Quercus rubra</i>)	64 cm	Private – 501 Cole	Good/fair; seam 2 m long on trunk to base of tree	Remove; within area of excavation for new home, Tree Permit required
3	Silver maple (<i>Acer saccharinum</i>)	82 cm	Private – 501 Cole	Fair; lean towards home, scar 1 m X 15 cm on upper side of lean, 2 codominant stems and one with significant decay at old branch wound	Retain and protect with City of Ottawa Tree Protection Specifications (March 2021) as detailed in report pending aerial inspection
5	Norway maple (<i>Acer platanoides</i>)	61 cm	Jointly owned with 502 Roosevelt	Poor; Recent failure of one codominant stem on subject property, advanced canker visible in remaining stem	Remove based on health, Tree Permit and permission from adjacent property owner required

¹ Please refer to the attached Tree Information map for tree numbers. Note that this includes a tree layer added to the grading plan (in pdf format) provided by the client. This layer includes only information about the trees and the original survey plan is not altered in this process.

²Ownership of the tree in this report is based on the information provided and should not be used as a determination of ownership. For ownership disputes, a survey should be relied on. For boundary trees, consent from the adjacent property owner is required for removal as part of the application.

³Trees on adjacent properties do not include a full assessment. The diameters are estimated, and health is estimated based on what is visible from the subject property. Trees along the property line may also have limited health assessments if part of the tree is not visible.



Proposed Development and Conserved Vegetation

Tree 1 is a city tree that has been maintained using a cabling support system. This tree is showing more recent signs of stress, including new woodpecker activity, and should be assessed by forestry services for viability. Given the health of this tree and potential for failure, it is not suitable for retention during any development at all. **Tree 2** is a red oak that is within the excavation assuming that the future development uses the as-of-right footprint for the new building.

Tree 3 is a silver maple in fair condition. It is not an ideal candidate for retention, however, if retention is the goal, an aerial inspection is recommended to ensure there are no immediate hazards. There is a large cavity in the crown that should be further inspected, and a call made at that time whether the tree is viable and not presenting a risk that the owners is willing to accept.

Tree 4 is a Norway maple that is in decline and should be removed. This tree appeared healthy 4 years ago and has since shown visible signs of canker and has lost one of its codominant stems. The canker is visible in the crown of the remaining stem that is leaning over the adjacent property at 502 Roosevelt. Permission to remove this tree is required by the adjacent property owner. If the tree is retained, any hazards should be mitigated, and both property owners agree to any remaining risk mitigation and maintenance that will be required in the future.

Tree Protection and Mitigation

Prior to any site works, protective fencing should be installed around tree 3 as indicated in the attached Tree Information Map and maintained until all construction on site has been completed as per the **City of Ottawa Tree Protection Specifications (March 2021)**. Within the fenced area, the following tree protection guidelines should be applied:

- Do not change the grade
- Do not store construction material
- Do not operate machinery
- Do not convert to hard surface or change the landscaping
- Do not excavate unless it is a method that has been pre-approved by the City
- Do not place signs, notices or posters to any tree
- Do not damage the root system, trunk, or branches of any tree
- Direct the exhaust away from the tree

The tree protection fencing must be 1.2 m in height and constructed of a rigid or framed material (e.g. modulus – steel, plywood hoarding, or snow fence on a 2"X4" wood frame) with posts 2.4 m apart such that the fence location cannot be altered. All supports must be placed outside of the CRZ and installation must minimize damage to existing roots.

If the fenced tree protection area must be reduced to facilitate construction, *one* of the following mitigation measures should be applied:

- Place a layer of 6-12 inches (15 to 30 cm) of woodchip mulch to the area
- Apply ¾ (2 cm) inch plywood, or road mats over a 4+ inch (10 cm) thick layer of the wood chip mulch
- Apply 4-6 inches (10 to 15 cm) of gravel over a taut, staked, geotextile fabric



The undersigned personally inspected the property and issues associated with this report on February 15, 2022, and February 26, 2026. On Behalf of Dendron Forestry Services,



Astrid Nielsen, MFC, RPF (Registered Professional Forester)
ISA Certified Arborist®, ON-1976
ISA Tree Risk Assessment Qualified
Principal, Dendron Forestry Services
Astrid.nielsen@dendronforestry.ca
(613) 805-9663 (WOOD)



Photo 1: Tree 1, city owned Norway maple to be removed



Photo 2: Tree 1, horizontal crack large branch hanging over road



Photo 3: Tree 1, photo showing several wounds in canopy



Photo 4: Tree 2, privately owned red oak to be removed



Photo 5: Tree 3, Silver maple to be retained pending aerial inspection



Photo 6: Tree 3, large cavity in crown requiring further inspection



Photo 7: Tree 4, Norway maple to be removed



Intended Use of the Report

This Information Report was carried out by Dendron Forestry Services (hereafter Dendron) at the request of the Client. The information, interpretation and analysis contained within this Report is to be used solely for the purposes outlined within this Report. This Report is for the exclusive use of the Client.

Limitations of this Report

This Report is based on the circumstances and observations as they existed at the time of the site inspection of the Client's Property and the trees situated thereon by Dendron and upon information provided by the Client to Dendron. The opinions in this Report are given based on observations made and using generally accepted professional judgment, however, because trees and plants are living organisms and subject to change, damage and disease, the results, observations, recommendations, and analysis as set out in this Report are valid only as at the date any such testing, observations and analysis took place and no guarantee, warranty, representation or opinion is offered or made by Dendron as to the length of the validity of the results, observations, recommendations and analysis contained within this Report. As a result the Client shall not rely upon this Report, save and except for representing the circumstances and observations, analysis and recommendations that were made as at the date of such inspections. It is recommended that the trees discussed in this Report should be re-assessed periodically.

Further Services

Neither Dendron nor any assessor employed or retained by Dendron for the purpose of preparing or assisting in the preparation of this Report shall be required to provide any further consultation or services to the Client, save and except as already carried out in the preparation of this Report and including, without limitation, to act as an expert witness or witness in any court in any jurisdiction unless the Client has first made specific arrangements with respect to such further services, including, without limitation, providing the payment of the Report's regular hourly billing fees.

Dendron accepts no responsibility for the implementation of all or any part of the Report, unless specifically request to examine the implementation of such activities recommended herein. In the event that inspection or supervision of all or part of the implementation is request, that request shall be in writing and the details agreed to in writing by both parties.

Assumptions

The Client is hereby notified and does hereby acknowledge and agree that where any of the facts and information set out and referenced in this Report are based on assumptions, facts or information provided to Dendron by the Client and/or third parties and unless otherwise set out within this Report, Dendron will in no way be responsible for the veracity or accuracy of any such information. Further, the Client acknowledges and agrees that Dendron has, for the purposes of preparing their Report, assumed that the Property, which is the subject of this Report is in full compliance with all applicable federal, provincial, municipal and local statutes, regulations, by-laws, guidelines and other related laws. Dendron explicitly denies any legal liability for any and all issues with respect to non-compliance with any of the above-referenced statutes, regulations, bylaws, guidelines and laws as it may pertain to or affect the Property to which this Report applies.

Professional Responsibility

In carrying out this Report, Dendron and any Assessor appointed for and on behalf of Dendron to perform and carry out the Report has exercised a reasonable standard of care, skill and diligence as would be customarily and normally provided in carrying out this Report. While reasonable efforts have been made to ensure that the trees recommended for retention are healthy, no guarantees are offered, or implied, that these trees, or all parts of them will remain standing. It is professionally impossible to predict with absolute certainty the behaviour of any single tree or group of trees, or all their component parts, in all given circumstances. Inevitably, a standing tree will always pose some risk. Most trees have the potential to fall, lean, or otherwise pose a danger to property and persons in the event of adverse weather conditions, and this risk can only be eliminated if the tree is removed.

Without limiting the foregoing, no liability is assumed by Dendron for:

- a) any legal description provided with respect to the Property;
- b) issues of title and or ownership respect to the Property;
- c) the accuracy of the Property line locations or boundaries with respect to the Property; and
- d) the accuracy of any other information provided to Dendron by the Client or third parties;
- e) any consequential loss, injury or damages suffered by the Client or any third parties, including but not limited to replacement costs, loss of use, earnings and business interruption; and
- f) the unauthorized distribution of the Report.

Further, under no circumstance may any claims be initiated or commenced by the Client against Dendron or any of its directors, officers, employees, contractors, agents or Assessors, in contract or in tort, more than 12 months after the date of this Report.

General

Any plans and/or illustrations in this Report are included only to help the Client visualize the issues in this Report and shall not be relied upon for any other purpose. This report is best viewed in colour. Any copies printed in black and white may make some details difficult to properly understand. Dendron accepts no liability for misunderstandings due to a black and white copy of the report.

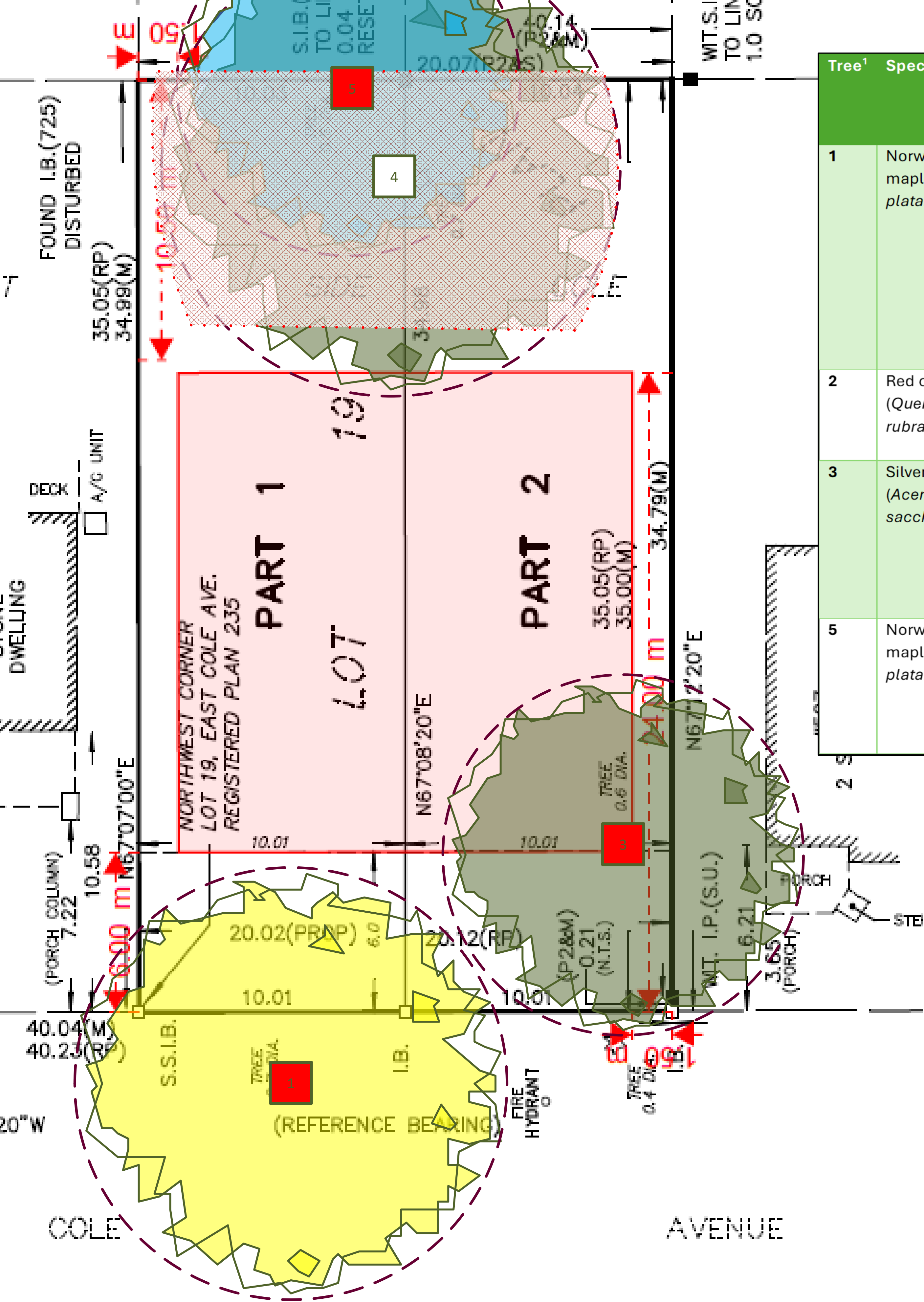

Tree ¹	Species	Diameter at breast height (cm)	Ownership ^{2,3}	Condition	Recommendations
1	Norway maple (<i>Acer platanoides</i>)	77 cm	City	Poor; 2 cables in crown, main branch (40 cm) leaning over road has split with epicormic shoots, decay in old pruning wounds, wound and split in main trunk at 3 m, recent woodpecker activity	Contact city forestry inspector to assess for removal; not suitable for retention
2	Red oak (<i>Quercus rubra</i>)	64 cm	Private – 501 Cole	Good/fair; seam 2 m long on trunk to base of tree	Remove; within area of excavation for new home, Tree Permit required
3	Silver maple (<i>Acer saccharinum</i>)	82 cm	Private – 501 Cole	Fair; lean towards home, scar 1 m X 15 cm on upper side of lean, 2 codominant stems and one with significant decay at old branch wound	Retain and protect with City of Ottawa Tree Protection Specifications (March 2021) as detailed in report pending aerial inspection
5	Norway maple (<i>Acer platanoides</i>)	61 cm	Jointly owned with 502 Roosevelt	Poor; Recent failure of one codominant stem on subject property, advanced canker visible in remaining stem	Remove based on health, Tree Permit and permission from adjacent property owner required

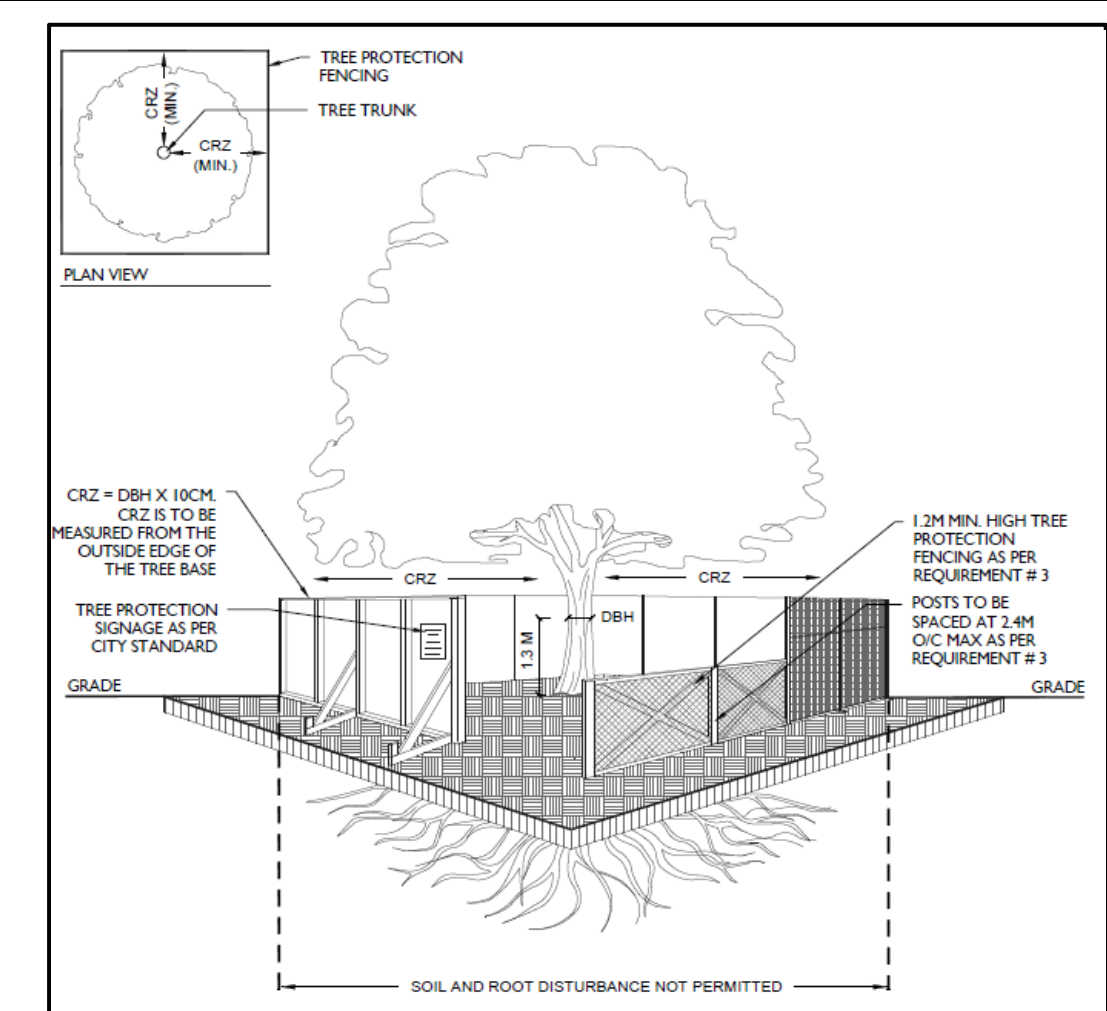

Failure to install and maintain fencing as described in this report may result in fines from the city.

- TREE PROTECTION REQUIREMENTS:**
- PRIOR TO ANY WORK ACTIVITY WITHIN THE CRITICAL ROOT ZONE (CRZ = 10 X DIAMETER) OF A TREE, TREE PROTECTION FENCING MUST BE INSTALLED SURROUNDING THE CRITICAL ROOT ZONE, AND REMAIN IN PLACE UNTIL THE WORK IS COMPLETE.
 - UNLESS PLANS ARE APPROVED BY CITY FORESTRY STAFF, FOR WORK WITHIN THE CRZ:
 - DO NOT PLACE ANY MATERIAL OR EQUIPMENT - INCLUDING outhouses;
 - DO NOT ATTACH ANY SIGNS, NOTICES OR POSTERS TO ANY TREE;
 - DO NOT RAISE OR LOWER THE EXISTING GRADE;
 - TUNNEL OR BORE WHEN DIGGING;
 - DO NOT DAMAGE THE ROOT SYSTEM, TRUNK, OR BRANCHES OR ANY TREE;
 - ENSURE THAT EXHAUST FUMES FROM ALL EQUIPMENT ARE NOT DIRECTED TOWARD ANY TREE CANOPY.
 - DO NOT EXTEND HARD SURFACE OR SIGNIFICANTLY CHANGE LANDSCAPING
 - TREE PROTECTION FENCING MUST BE AT LEAST 1.2M IN HEIGHT, AND CONSTRUCTED OF RIGID OR FRAMED MATERIALS (E.G. MODULOC - STEEL, PLYWOOD HOARDING, OR SNOW FENCE ON A 2"X4" WOOD FRAME) WITH POSTS 2.4M APART, SUCH THAT THE FENCE LOCATION CANNOT BE ALTERED. ALL SUPPORTS AND BRACING MUST BE PLACED OUTSIDE OF THE CRZ, AND INSTALLATION MUST MINIMISE DAMAGE TO EXISTING ROOTS. (SEE DETAIL)
 - THE LOCATION OF THE TREE PROTECTION FENCING MUST BE DETERMINED BY AN ARBORIST AND DETAILED ON ANY ASSOCIATED PLANS FOR THE SITE (E.G. TREE CONSERVATION REPORT, TREE INFORMATION REPORT, ETC). THE PLAN AND CONSTRUCTED FENCING MUST BE APPROVED BY CITY FORESTRY STAFF PRIOR TO THE COMMENCEMENT OF WORK.
 - IF THE FENCED TREE PROTECTION AREA MUST BE REDUCED TO FACILITATE CONSTRUCTION, MITIGATION MEASURES MUST BE PRESCRIBED BY AN ARBORIST AND APPROVED BY CITY FORESTRY STAFF. THESE MAY INCLUDE THE PLACEMENT OF PLYWOOD, WOOD CHIPS, OR STEEL PLATING OVER THE ROOTS FOR PROTECTION OR THE PROPER PRUNING AND CARE OF ROOTS WHERE ENCOUNTERED.
- THE CITY'S TREE PROTECTION BY-LAW, 2020-340 PROTECTS BOTH CITY-OWNED TREES, CITY-WIDE, AND PRIVATELY-OWNED TREES WITHIN THE URBAN AREA. PLEASE REFER TO WWW.OTTAWA.CA/TREEBYLAW FOR MORE INFORMATION ON HOW THE TREE BY-LAW APPLIES.

- Critical Root Zone
- Tree Fencing Area
- Tree to be removed
- Private Tree
- Tree either fully or partly on city property
- Tree either fully or partly on adjacent property

Note that the tree layer has been added to the original survey plan supplied by the client in pdf format. This layer refers to the trees only, and the original survey plan has not been altered in the process.

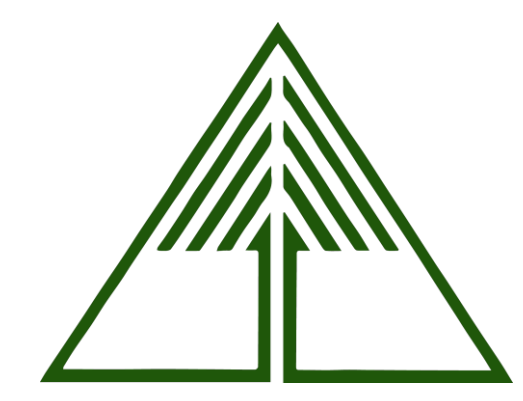

Tree Information Report – 501 Cole Ave
 Tree layer prepared by Dendron Forestry Services
 Version 2.0, March 3, 2026
 For more information, please contact info@dendronforestry.ca

