



Official Plan Amendment XX

to the
Official Plan for the
City of Ottawa

Portobello Road

INDEX

THE STATEMENT OF COMPONENTS

PART A – THE PREAMBLE introduces the actual amendment but does not constitute part of Amendment No. ___ to the Official Plan for the City of Ottawa.

PART B – THE AMENDMENT constitutes Amendment ____ to the Official Plan for the City of Ottawa.

PART A – THE PREAMBLE

Purpose	Page 4
Location	Page 4
Basis	Page 4

PART B – THE AMENDMENT

Introduction	Page 6
Details of the Amendment	Page 6
Implementation and Interpretation	Page 6

PART A – THE PREAMBLE

1. Purpose

This Official Plan Amendment re-designates land, owned by the City of Ottawa and fronting Portobello and Brian Coburn Boulevards as well as a number of small residential lots fronting Tenth Line and Trim Roads, in Orleans. The designation is to be changed from Agricultural Resource Area to General Rural Area.

This change is intended to make the designation of these lands consistent with the surrounding 250 ha of land which was recently re-designated to General Rural Area by the Local Planning Appeals Tribunal (LPAT).

2. Location

The proposed Official Plan Amendment applies to City owned land fronting Portobello and Brian Coburn Boulevards in Cumberland as well as small residential lots fronting Trim and Tenth Line Roads north of Wall Road. These properties are shown in grey shading on the location map that follows.

Basis

Rationale

The body of land shown in the location map has formed part of the City's Agricultural Resource Area dating from the former Regional Official Plan and the Township of Cumberland Rural Official Plan. The City of Ottawa Official Plan continued

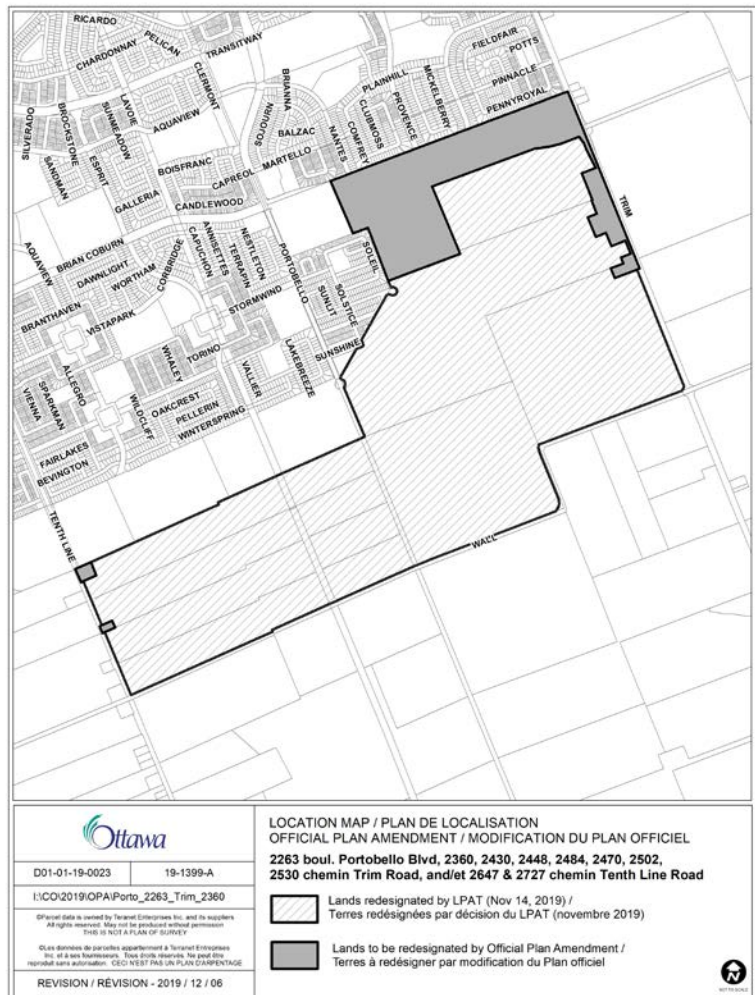

to recognise this land as agricultural land to be protected. The owners of the land that is identified by cross-hatching on the location map, applied to re-designate their land from Agricultural Resource Area to General Rural Area. The City refused that application and the owner's appealed the decision. The appeal was considered by the LPAT which, upheld the appeal and changed the designation of the land to General Rural Area. The LPAT decision did not include the remnant City land and residential lots fronting Trim and Tenth Line Roads. As a result, these remnant lots combined no longer meet the City's criteria for protection as an Agricultural Resource Area.

The City's policies, based upon Provincial Guidelines, seek to preserve clusters of agricultural land which are at least 250 ha in size. This area is considered the minimum that can be effectively protected from adjacent, non agricultural land uses. Given the change approved by the LPAT the remnant pieces of land, subject to this amendment no longer meet this minimum size criterion.

This amendment will re-designate these remnant pieces to a General Rural Area designation consistent with the designation of the lands redesignated by the LPAT.

PART B – THE AMENDMENT

1. Introduction

All of this part of this document entitled Part B – The Amendment consisting of the following text and Schedule 1 constitutes Amendment No. XX to the Official Plan for the City of Ottawa.

2. Details

Schedule A of the Official Plan of the City of Ottawa is hereby amended to redesignate the lands shown by heavy outline and shading on Schedule 1 to this from “Agricultural Resource Area” to “General Rural Area”.

3. Implementation and Interpretation

Implementation and interpretation of this Amendment shall be in accordance with the policies of the Official Plan for the City of Ottawa.

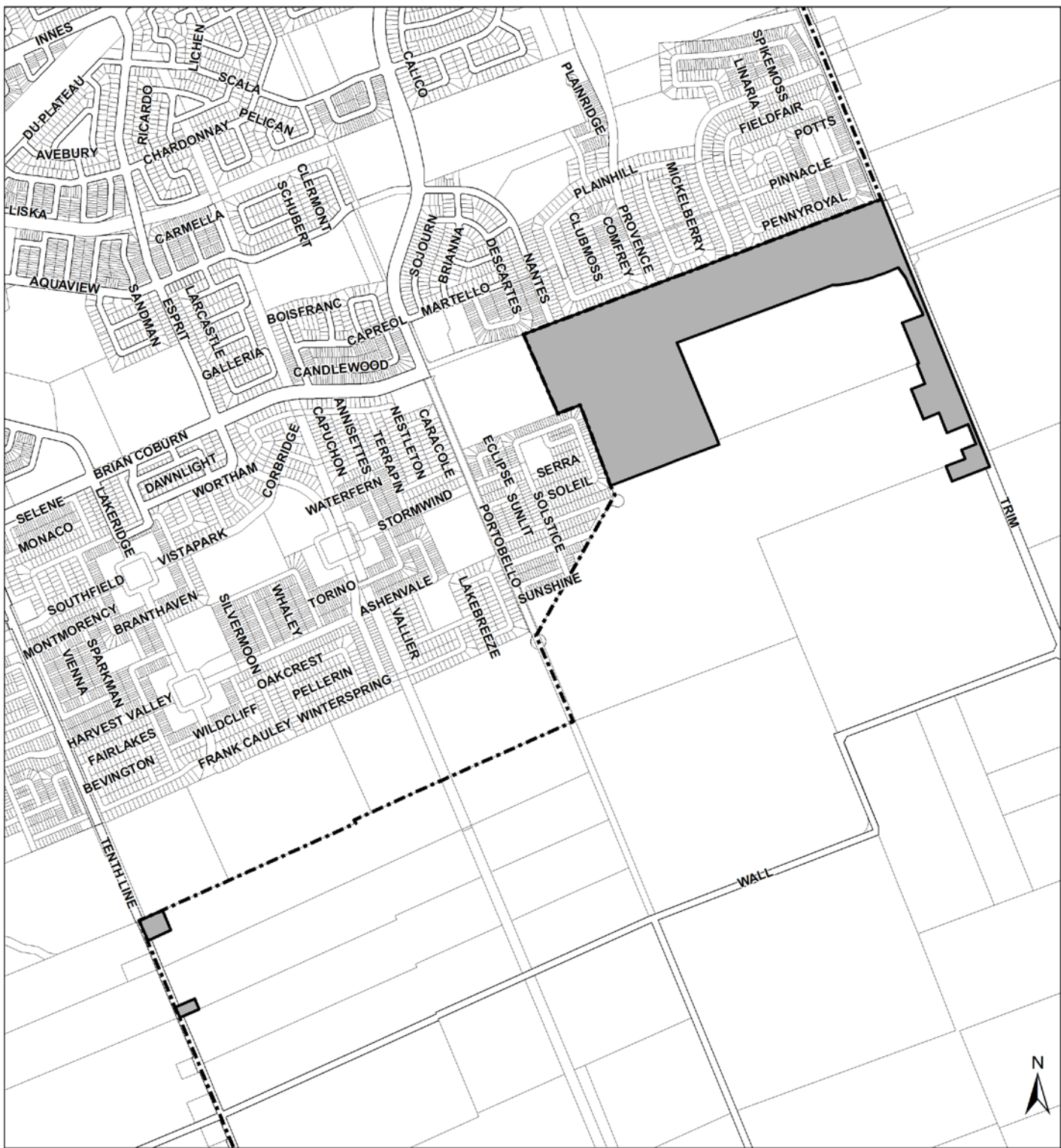

Planning, Infrastructure and Economic Development,
Services de la planification, de Géospatial Analytics,
Technologie and Solutions



Infrastructure et du développement économique,
Analyse géospatiale, technologie et solutions

D01-01-19-0023

20-0036-A

I:\AAStaff\Sheila\OPAs2013\OPA Portobello

10 / 08 / 2019

© Parcel data is owned by Terranet Enterprises Inc. and its suppliers.
All rights reserved. May not be reproduced without permission.
Parcel data appartient à Terranet Enterprises Inc. et à ses fournisseurs.
Tous droits réservés. Ne peut être reproduit sans autorisation.

Scale - N.T.S. / Echelle N.A.E.

**SCHEDULE 1 to
AMENDMENT NO.**
to the OFFICIAL PLAN
for the CITY OF OTTAWA
Amending Schedule A
Rural Policy Plan

**ANNEXE 1 de
L' AMENDEMENT NO.**
au PLAN OFFICIEL
de la VILLE D'OTTAWA
Modifiant l'Annexe A
Plan des politiques en milieu rural

 LANDS REDESIGNATED FROM "AGRICULTURAL RESOURCE AREA" TO "GENERAL RURAL AREA"
TERRES DONT LA DÉSIGNATION EST PASSÉE DE « ZONE DE RESSOURCES AGRICOLES »
À « ZONE RURALE GÉNÉRALE »

 URBAN BOUNDARY /LIMITES DU SECTEUR URBAIN