

1 NORTH ELEVATION  
A2-1 1/4"=1'-0"

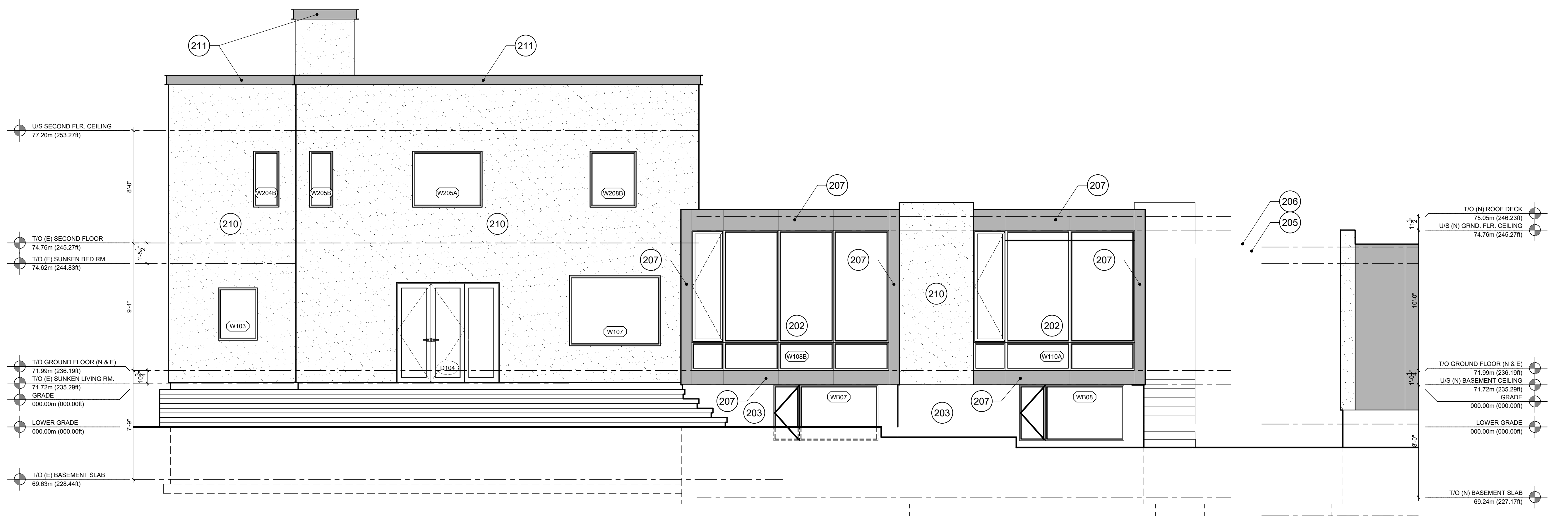

1 SOUTH ELEVATION  
A2-1 1/4"=1'-0"

GENERAL NOTES

- A THE CONTRACTOR SHALL CHECK AND VERIFY ALL DIMENSIONS ON SITE AND REPORT ALL DISCREPANCIES TO THE ARCHITECT.
- B DO NOT SCALE DRAWINGS.
- C ALL WORK SHALL COMPLY WITH THE ONTARIO BUILDING CODE AND THE REQUIREMENTS OF ALL AUTHORITIES HAVING JURISDICTION.
- D THIS DRAWING IS THE EXCLUSIVE PROPERTY OF CHRISTOPHER SIMMONDS ARCHITECT INC. COPYRIGHT RESERVED.

ELEVATION NOTES

- 201 EIFS STUCCO, FINISH & COLOUR TO MATCH EXISTING STUCCO SYSTEM.
- 202 ALUMINUM CLAD WINDOWS & DOORS. COLOUR TO MATCH EXISTING.
- 203 CEMENT PARING
- 204 2-PLY MODIFIED BITUMEN ROOFING MEMBRANE
- 205 PRE-FINISHED METAL FASCIA, DARKENED BRASS / COPPER TO MATCH EXISTING.
- 206 PRE-FINISHED METAL FLASHING c/w DRIP EDGE, DARKENED BRASS / COPPER TO MATCH EXISTING.
- 207 PRE-FINISHED METAL CLADDING, DARKENED BRASS / COPPER TO MATCH EXISTING METAL.
- 208 METAL CLAD GARAGE DOOR, COLOUR TO MATCH METAL CLADDING COLOUR.
- 209 NEW FRONT DOOR
- 210 EXISTING STUCCO CLADDING
- 211 EXISTING METAL FASCIA, DARKENED BRASS / COPPER

01	FEB. 07, 2022	ISSUED FOR HERITAGE APPLICATION
No.	DATE	DESCRIPTION
ARCHITECT'S SEAL:		PROJECT NORTH:
		
		340 CATHERINE ST. OTTAWA ON K1R 1C4 613.567.7888 PHONE / 613.567.7528 FAX csaarchitect.com
PROJECT:		
ENGLISH - ENRIGHT RESIDENCE 392 ASHBURY RD. ROCKCLIFFE, ON, K1M 0R8		
DRAWING TITLE: FRONT & REAR ELEVATIONS		
DATE:	SEP 22, 2021	DRAWING No:
SCALE:	1/4" = 1'-0"	
DRAWN BY:	SRB	
JOB No:	798-21	

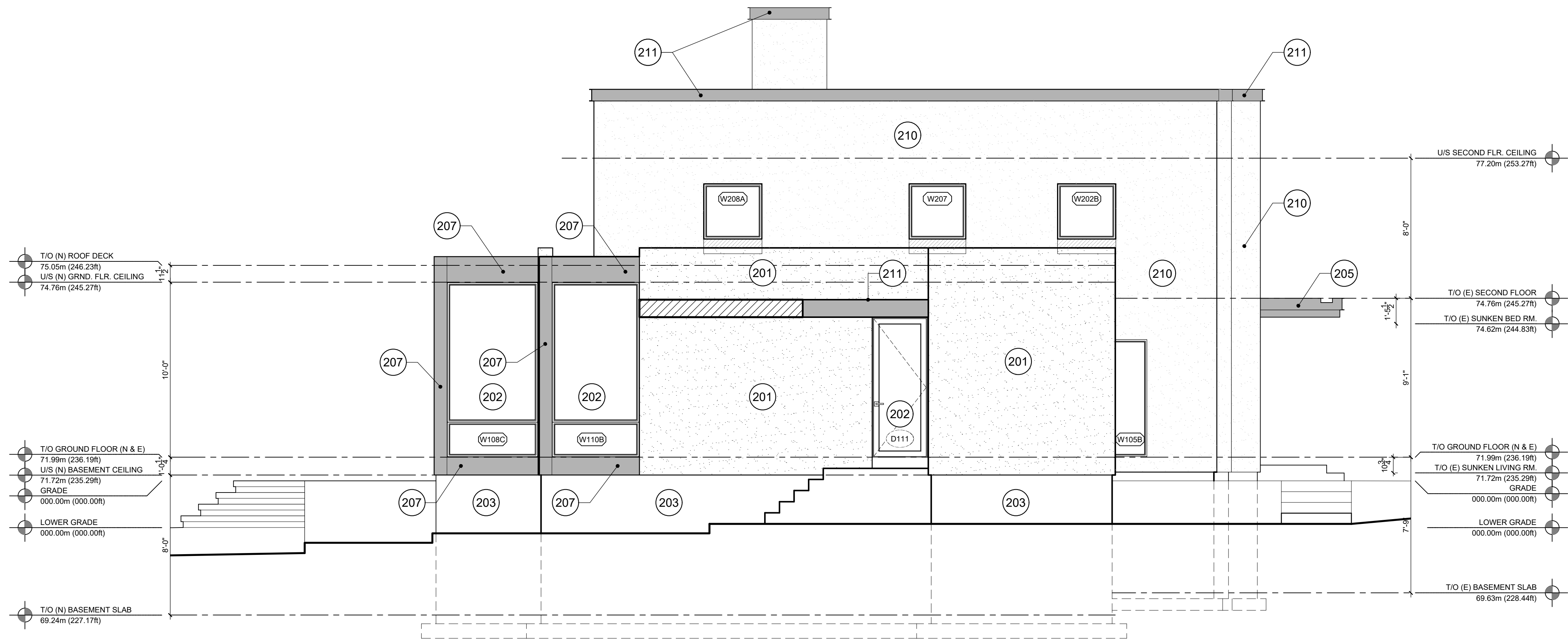

1 NORTH ELEVATION  
1/4" = 1'-0"

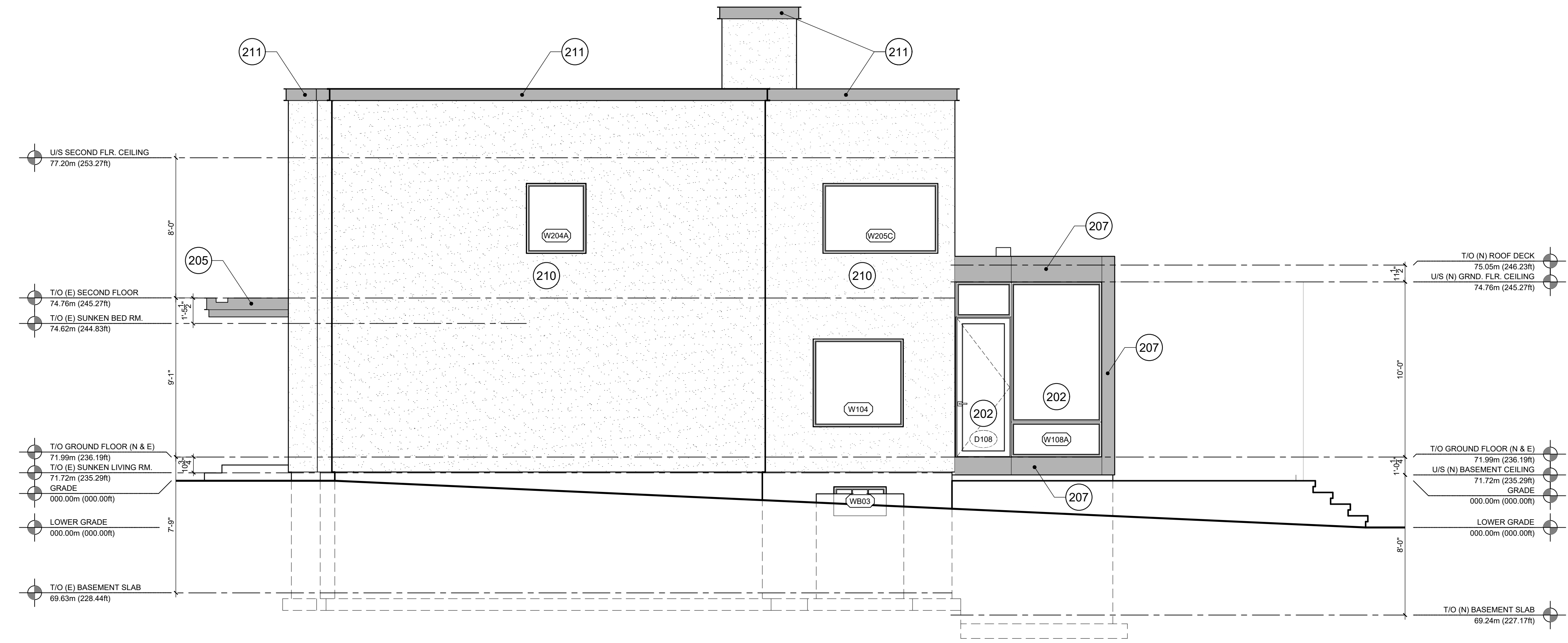

1 SOUTH ELEVATION  
1/4" = 1'-0"

GENERAL NOTES

- A THE CONTRACTOR SHALL CHECK AND VERIFY ALL DIMENSIONS ON SITE AND REPORT ALL DISCREPANCIES TO THE ARCHITECT.
- B DO NOT SCALE DRAWINGS.
- C ALL WORK SHALL COMPLY WITH THE ONTARIO BUILDING CODE AND THE REQUIREMENTS OF ALL AUTHORITIES HAVING JURISDICTION.
- D THIS DRAWING IS THE EXCLUSIVE PROPERTY OF CHRISTOPHER SIMMONDS ARCHITECT INC. COPYRIGHT RESERVED.

ELEVATION NOTES

- 201 EIFS STUCCO, FINISH & COLOUR TO MATCH EXISTING STUCCO SYSTEM.
- 202 ALUMINUM CLAD WINDOWS & DOORS. COLOUR TO MATCH EXISTING.
- 203 CEMENT PARGING
- 204 2-PLY MODIFIED BITUMEN ROOFING MEMBRANE
- 205 PRE-FINISHED METAL FASCIA, DARKENED BRASS / COPPER TO MATCH EXISTING.
- 206 PRE-FINISHED METAL FLASHING c/w DRIP EDGE, DARKENED BRASS / COPPER TO MATCH EXISTING.
- 207 PRE-FINISHED METAL CLADDING, DARKENED BRASS / COPPER TO MATCH EXISTING METAL.
- 208 METAL CLAD GARAGE DOOR, COLOUR TO MATCH METAL CLADDING COLOUR.
- 209 NEW FRONT DOOR
- 210 EXISTING STUCCO CLADDING
- 211 EXISTING METAL FASCIA, DARKENED BRASS / COPPER

02	FEB. 28, 2022	REVISED PER HERITAGE COMMENTS
01	FEB. 07, 2022	ISSUED FOR HERITAGE APPLICATION

No.	DATE	DESCRIPTION
-----	------	-------------

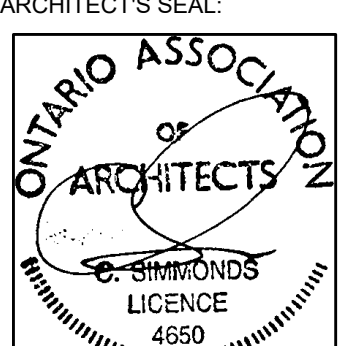
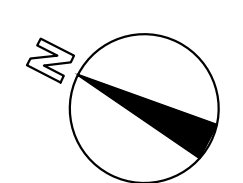
ARCHITECT'S SEAL:  PROJECT NORTH: 

**Christopher Simmonds** Architect  
 340 CATHERINE ST. OTTAWA ON K1R 1C4  
 613.567.7888 PHONE / 613.567.7528 FAX  
 csaarchitect.com

PROJECT:  
 ENGLISH - ENRIGHT RESIDENCE  
 392 ASHBURY RD.  
 ROCKCLIFFE, ON, K1M 0R8

DRAWING TITLE:  
 SIDE ELEVATIONS

DATE:	SEP 22, 2021	DRAWING No:	
SCALE:	1/4" = 1'-0"		
DRAWN BY:	SRB		
JOB No:	798-21		

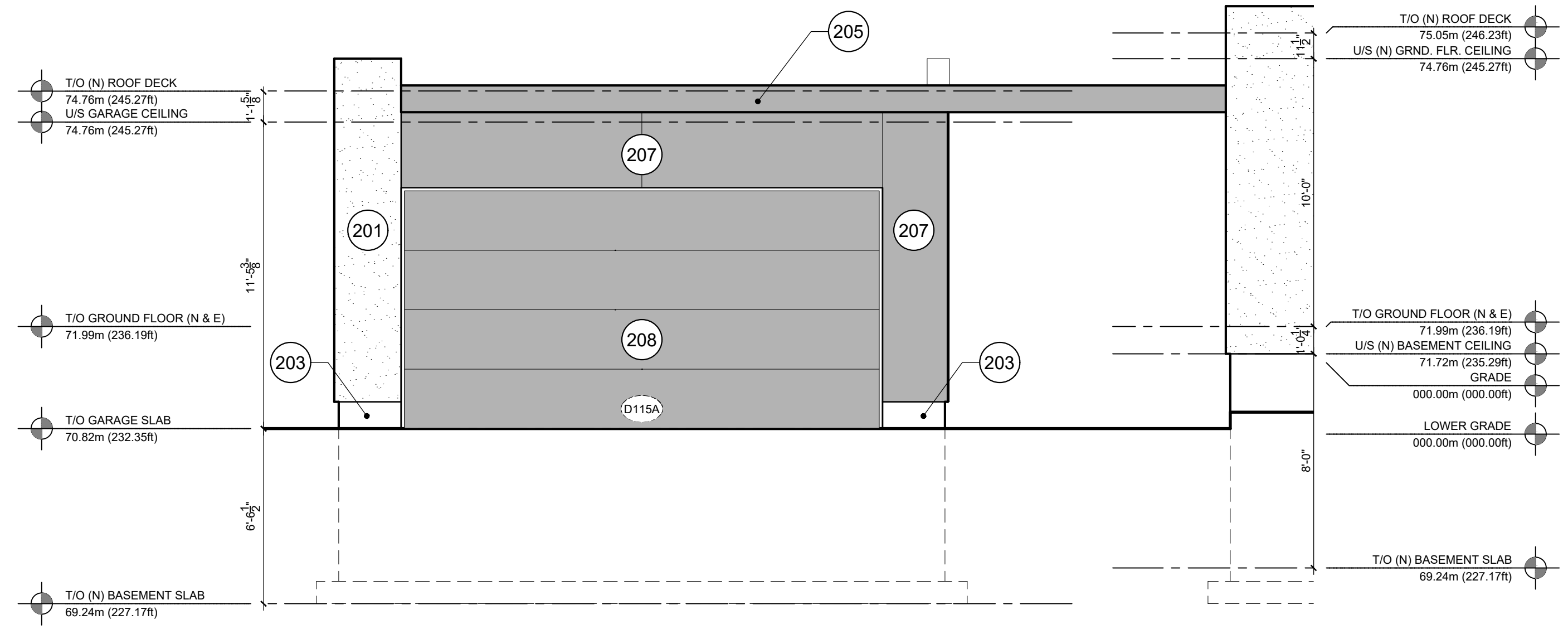

1 NORTH GARAGE ELEVATION  
A2-3 1/4"=1'-0"

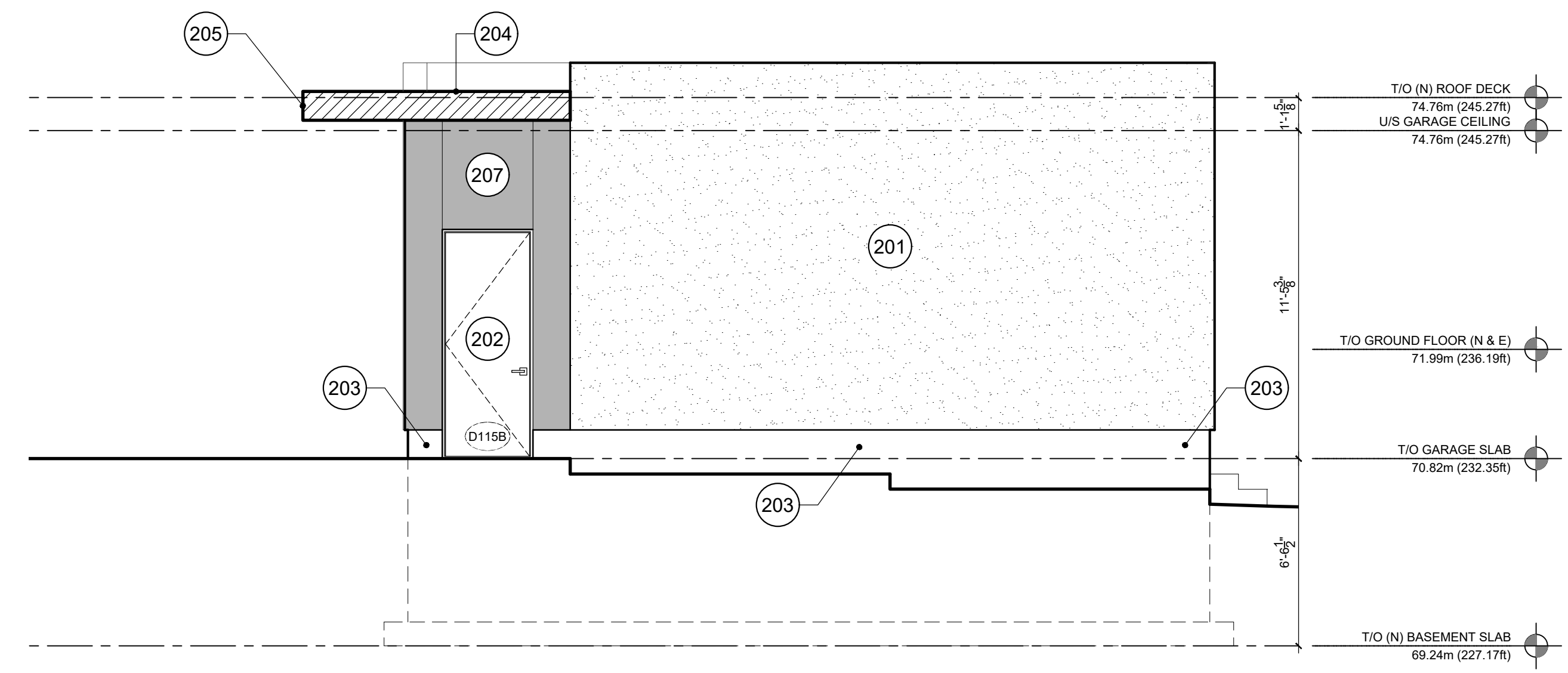

2 WEST GARAGE ELEVATION  
A2-3 1/4"=1'-0"

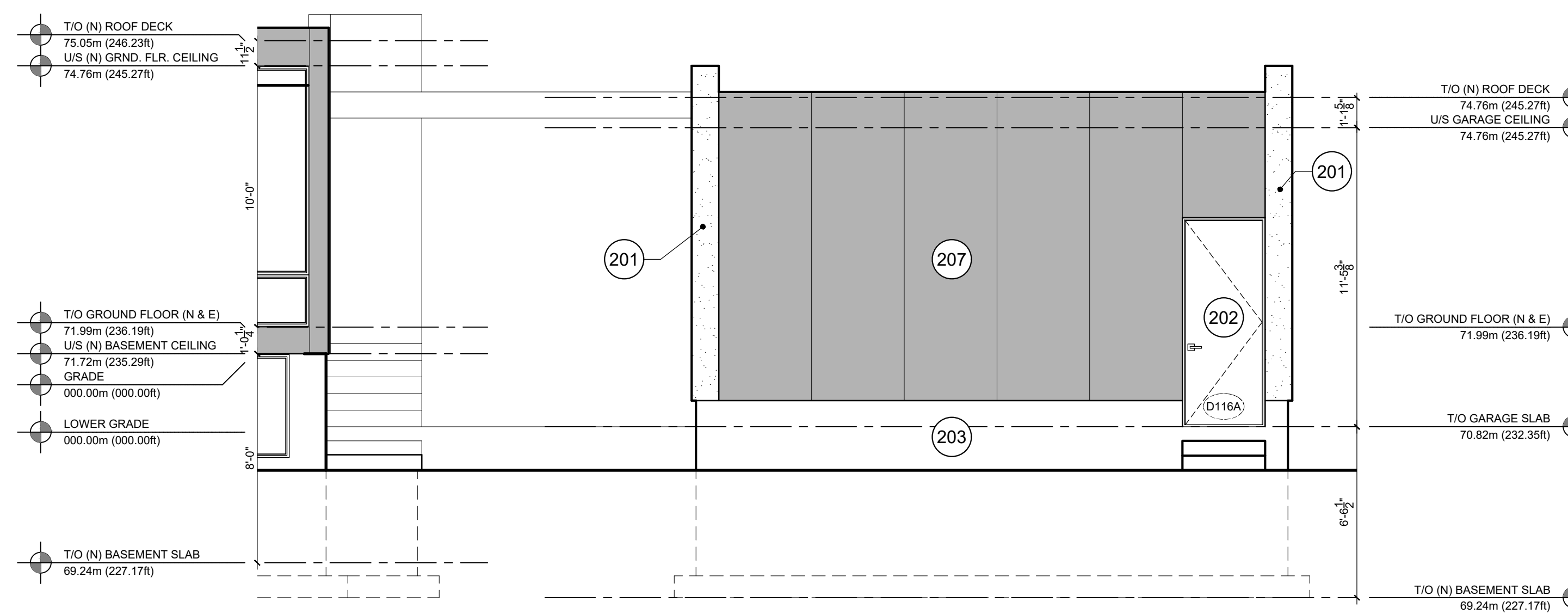

3 SOUTH GARAGE ELEVATION  
A2-3 1/4"=1'-0"

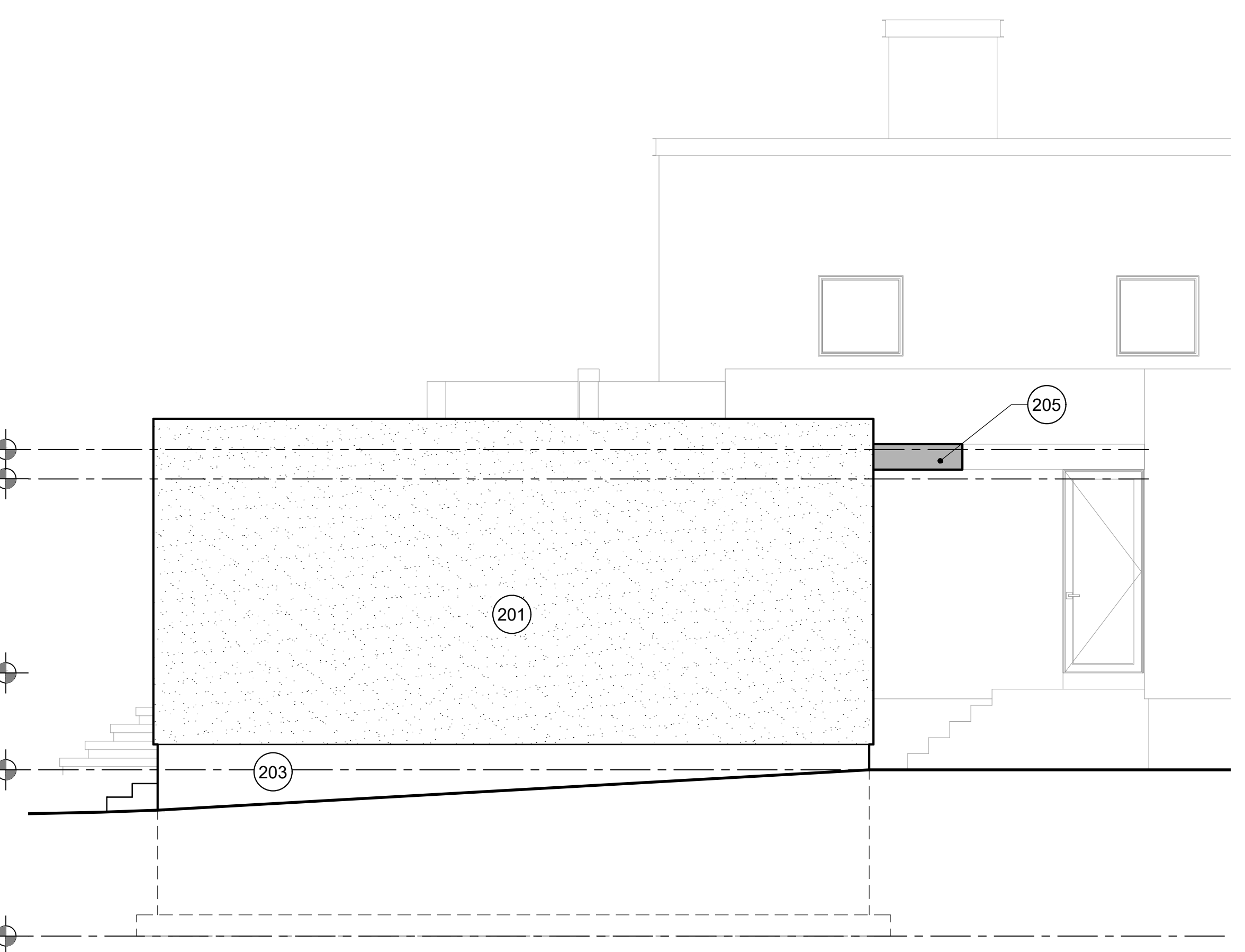

3 EAST GARAGE ELEVATION  
A2-3 1/4"=1'-0"

GENERAL NOTES

- A THE CONTRACTOR SHALL CHECK AND VERIFY ALL DIMENSIONS ON SITE AND REPORT ALL DISCREPANCIES TO THE ARCHITECT.
- B DO NOT SCALE DRAWINGS.
- C ALL WORK SHALL COMPLY WITH THE ONTARIO BUILDING CODE AND THE REQUIREMENTS OF ALL AUTHORITIES HAVING JURISDICTION.
- D THIS DRAWING IS THE EXCLUSIVE PROPERTY OF CHRISTOPHER SIMMONDS ARCHITECT INC. COPYRIGHT RESERVED.

ELEVATION NOTES

- 201 EIFS STUCCO, FINISH & COLOUR TO MATCH EXISTING STUCCO SYSTEM.
- 202 ALUMINUM CLAD WINDOWS & DOORS. COLOUR TO MATCH EXISTING.
- 203 CEMENT PARGING
- 204 2-PLY MODIFIED BITUMEN ROOFING MEMBRANE
- 205 PRE-FINISHED METAL FASCIA, DARKENED BRASS / COPPER TO MATCH EXISTING.
- 206 PRE-FINISHED METAL FLASHING c/w DRIP EDGE, DARKENED BRASS / COPPER TO MATCH EXISTING.
- 207 PRE-FINISHED METAL CLADDING, DARKENED BRASS / COPPER TO MATCH EXISTING METAL.
- 208 METAL CLAD GARAGE DOOR, COLOUR TO MATCH METAL CLADDING COLOUR.
- 209 NEW FRONT DOOR
- 210 EXISTING STUCCO CLADDING
- 211 EXISTING METAL FASCIA, DARKENED BRASS / COPPER

02	FEB. 28, 2022	REVISED PER HERITAGE COMMENTS
01	FEB. 07, 2022	ISSUED FOR HERITAGE APPLICATION

No.	DATE	DESCRIPTION
-----	------	-------------

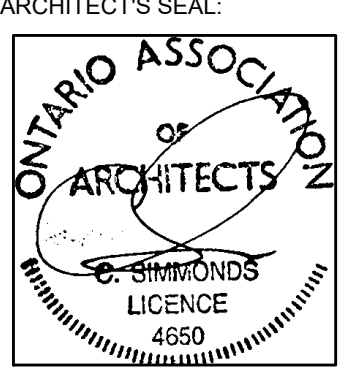
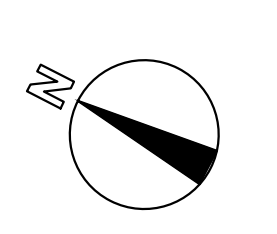
ARCHITECT'S SEAL:  PROJECT NORTH: 

**Christopher Simmonds** Architect  
340 CATHERINE ST. OTTAWA ON K1R 1C4  
613.567.7888 PHONE / 613.567.7528 FAX  
csarchitect.com

PROJECT:  
ENGLISH - ENRIGHT RESIDENCE  
392 ASHBURY RD.  
ROCKCLIFFE, ON, K1M 0R8

DRAWING TITLE:  
GARAGE  
ELEVATIONS

DATE:	SEP 22, 2021	DRAWING No:	
SCALE:	1/4" = 1'-0"		
DRAWN BY:	SRB		
JOB No:	798-21		

A2-3