

THIS DRAWING IS PREPARED FOR SITE PLAN CONTROL ONLY AND NOT TO BE USED FOR TENDER PURPOSES.

THIS DRAWING IS TO BE READ IN CONJUNCTION WITH THE TREE CONSERVATION REPORT Prepared by Ruhland & Associates, December 23, 2020

- A 400mm COMPACTED PLANTING MEDIUM
- B PLANTING MEDIUM / SUBSOIL CULTIVATED LAYER
- C SUBGRADE
- D 50-75 mm MULCH LAYER, KEEP MULCH AWAY FROM STEMS
- E PRECAST EDGER
- F PRECAST CONCRETE PAVERS, LEVELLING COURSE AND GRANULARS or CONCRETE TREE SURROUND (COORDINATE WITH CITY)
- G CROWN CENTER A MINIMUM OF 100mm ABOVE SURROUNDING GRADE
- H FIRST ROW OF PERENNIALS TO BE PLANTED HALF THE BED WIDTH FROM EDGER - REFER TO PLAN FOR BED WIDTH

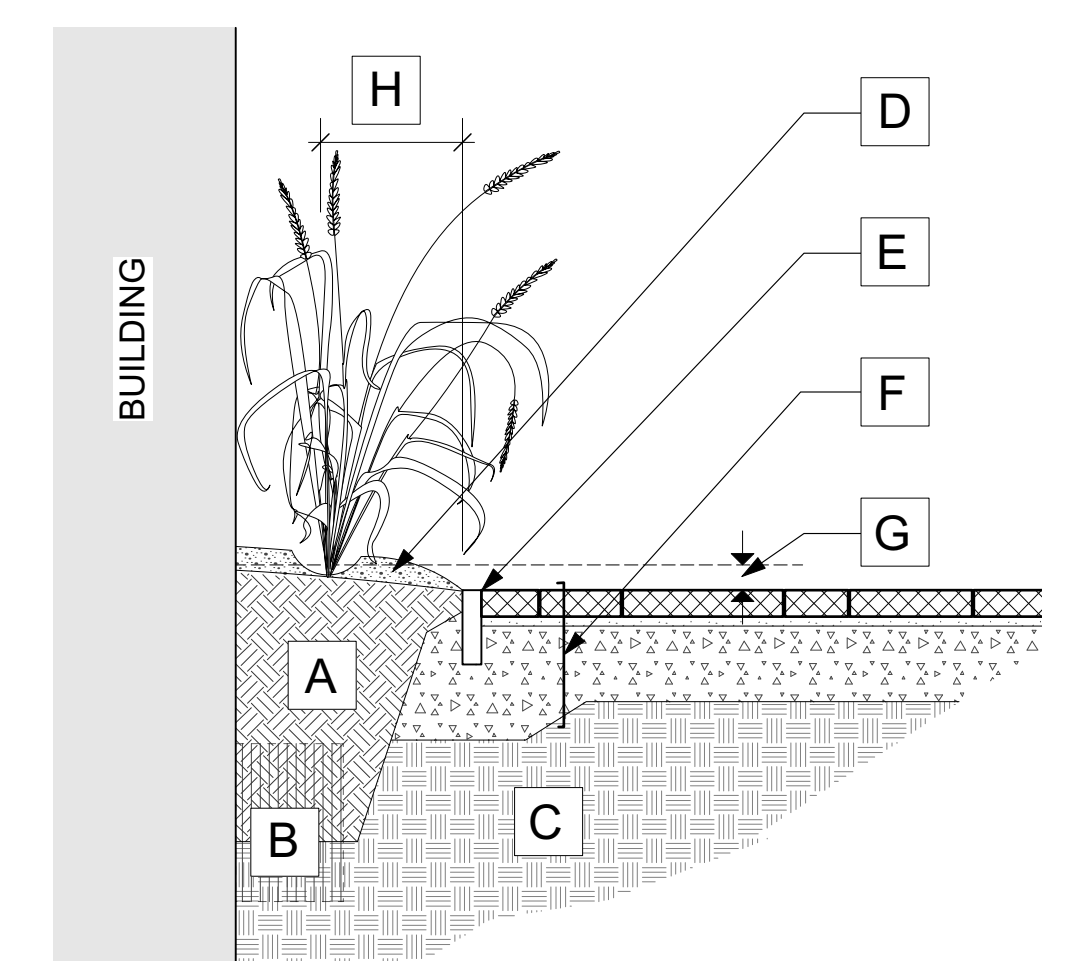

1 ORNAMENTAL GRASSES PLANTING BEDS
Scale: NTS

***STREET TREE PLANTING TO MATCH EXISTING PLANTING METHODS AND DETAILING. FINAL SPECIES, LOCATION AND DETAILING TO BE COORDINATED WITH CITY OF OTTAWA FORESTRY AND SURFACE OPERATIONS.**

- GENERAL NOTES
- 1 All general site information and conditions compiled from existing plans, surveys and consultant's field notes. Report all discrepancies prior to any work. No responsibility is born by the Consultant for unknown subsurface conditions.
 - 2 The location of the utilities is approximate only, and the exact location should be determined by consulting the municipal authorities and utility companies concerned. The Contractor shall prove the location of utilities and shall be responsible for adequate protection from damage.
 - 3 All dimensions shown are to be verified on site prior to any construction. No deviations are to be made from the layouts as shown on this plan without prior consultation with the Landscape Architect and Owner.
 - 4 Obtain approval of Landscape Architect for granular base and layout of all pavement areas prior to construction.
 - 5 Stake planting locations and receive approval of Landscape Architect and the City of Ottawa, prior to excavation of any planting pits. No substitutions of plant material shall be made without prior approval of the Landscape Architect.
 - 6 Where clay is encountered proper drainage must be ensured in tree/shrub pits, prior to planting. Have method approved by Landscape Architect and the City of Ottawa.
 - 7 Final subgrade is to be approved by the Landscape Architect prior to sod being laid.
 - 8 Maintain positive surface runoff through the entire construction period.
 - 9 Reinstatement all areas and items damaged as a result of construction activities.

6		
5		
4		
3		
2		
1	Issued for Site Plan Control	2020/12/23
no.	issue / revision	date

no. issue / revision date

north seal

Ruhland & Associates Ltd
landscape architecture • urban design • site planning
Ph 613-224-4744 Fx 613-224-1131 info@rala.ca www.rala.ca

project
406 408 Bank Street
OTTAWA, ON

drawing title
LANDSCAPE PLAN

scale	drawn by	designed by
1:75	T. Frost	A. Ahmed
date	checked by	plot date
December 2020	M. Ruhland	Dec. 23, 2020

project number drawing number
20-1632 L- 01

Contractor to check and verify all dimensions on the job

Plant List

ID	Qty	Botanical Name	Common Name	Sched. Size	Remarks
TREES					
QpP*	1	Quercus palustris 'Pringreen'	Green Pillar Pin Oak	70mm caliper	WB Staked
PERENNIALS					
CaKF	11	Calamagrostis x acutiflora 'Karl Foerster'	Karl Foerster Feather Reed Grass	1 gal.	Potted

NOTES:
REINSTATE PAVERS, CITY SIDEWALK TO EXISTING CONDITIONS. ADJUST FURNISHING PLACEMENT WHERE REQUIRED
THIS DRAWING TO BE READ IN CONJUNCTION WITH THE TREE CONSERVATION REPORT PREPARED BY RUHLAND & ASSOCIATES LTD. (2020/12/23)